

(SUBMIT IN TRIPLICATE)

UNITED STATES
DEPARTMENT OF THE INTERIOR
GEOLOGICAL SURVEY

Land Office Santa Fe
Lease No. 87-078115
Unit Greiner

SUNDRY NOTICES AND REPORTS ON WELLS

NOTICE OF INTENTION TO DRILL.....	<input checked="" type="checkbox"/>	SUBSEQUENT REPORT OF WATER SHUT-OFF.....	
NOTICE OF INTENTION TO CHANGE PLANS.....		SUBSEQUENT REPORT OF SHOOTING OR ACIDIZING.....	
NOTICE OF INTENTION TO TEST WATER SHUT-OFF.....		SUBSEQUENT REPORT OF ALTERING CASING.....	
NOTICE OF INTENTION TO RE-DRILL OR REPAIR WELL.....		SUBSEQUENT REPORT OF RE-DRILLING OR REPAIR.....	
NOTICE OF INTENTION TO SHOOT OR ACIDIZE.....		SUBSEQUENT REPORT OF ABANDONMENT.....	
NOTICE OF INTENTION TO PULL OR ALTER CASING.....		SUPPLEMENTARY WELL HISTORY.....	
NOTICE OF INTENTION TO ABANDON WELL.....			

(INDICATE ABOVE BY CHECK MARK NATURE OF REPORT, NOTICE, OR OTHER DATA)

March 20, 1960

Well No. 9 is located 1130 ft. from N line and 1600 ft. from E line of sec. 13
NE 1/4, Section 13 31N 18W N.M.P.M.
(1/4 Sec. and Sec. No.) (Twp.) (Range) (Meridian)
Undesignated Pictured Cliffs San Juan New Mexico
(Field) (County or Subdivision) (State or Territory)

The elevation of the derrick floor above sea level is 6202 ft. (Ground Elevation)

DETAILS OF WORK

(State names of and expected depths to objective sands; show sizes, weights, and lengths of proposed casings; indicate mudding jobs, cementing points, and all other important proposed work)

Propose To: Set 90' of 7 5/8" surface and cement with 100 sz. cement.

Drill through Pictured Cliffs formation to an approximate total depth of 2875'. Set 4 1/2" production casing at total depth and cement with 100 sz.

Perforate Pictured Cliffs formation with four shots per foot.

Sand-water frac with 40,000# sand and 40,000 gals. water.

Run 1" tubing.

NE 1/4 of Section 13, consisting of 160 acres, dedicated to well.

I understand that this plan of work must receive approval in writing by the Geological Survey before operation can be commenced.

Company Astec Oil & Gas Company

Address Box 786

Farmington, New Mexico

By ORIGINAL SIGNED BY JOE C. SALMON
Joe C. Salmon
Title District Superintendent

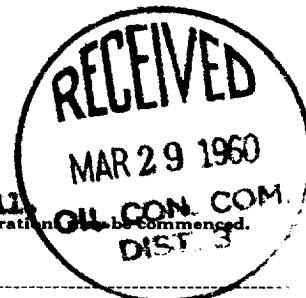

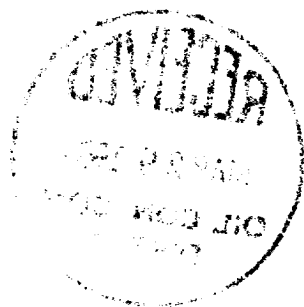

NEW MEXICO OIL CONSERVATION COMMISSION

Well Location and Acreage Dedication Plat

Section A.

Date March 24, 1960

Operator Aztec Oil & Gas Company Lease Granier
Well No. 9 Unit Letter B Section 13 Township 31N Range 12W NMPM
Located 1130 Feet From North Line, 1680 Feet From East Line
County San Juan G. L. Elevation 6292 Dedicated Acreage 160 Acres
Name of Producing Formation Pictured Cliffs Pool Undesignated

1. Is the Operator the only owner* in the dedicated acreage outlined on the plat below?
Yes XXX No .
2. If the answer to question one is "no," have the interests of all the owners been consolidated by communitization agreement or otherwise? Yes No . If answer is "yes,"
Type of Consolidation
3. If the answer to question two is "no," list all the owners and their respective interests below:

Owner

Land Description

Section B

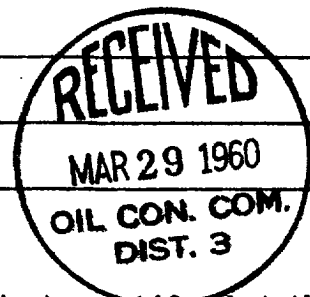
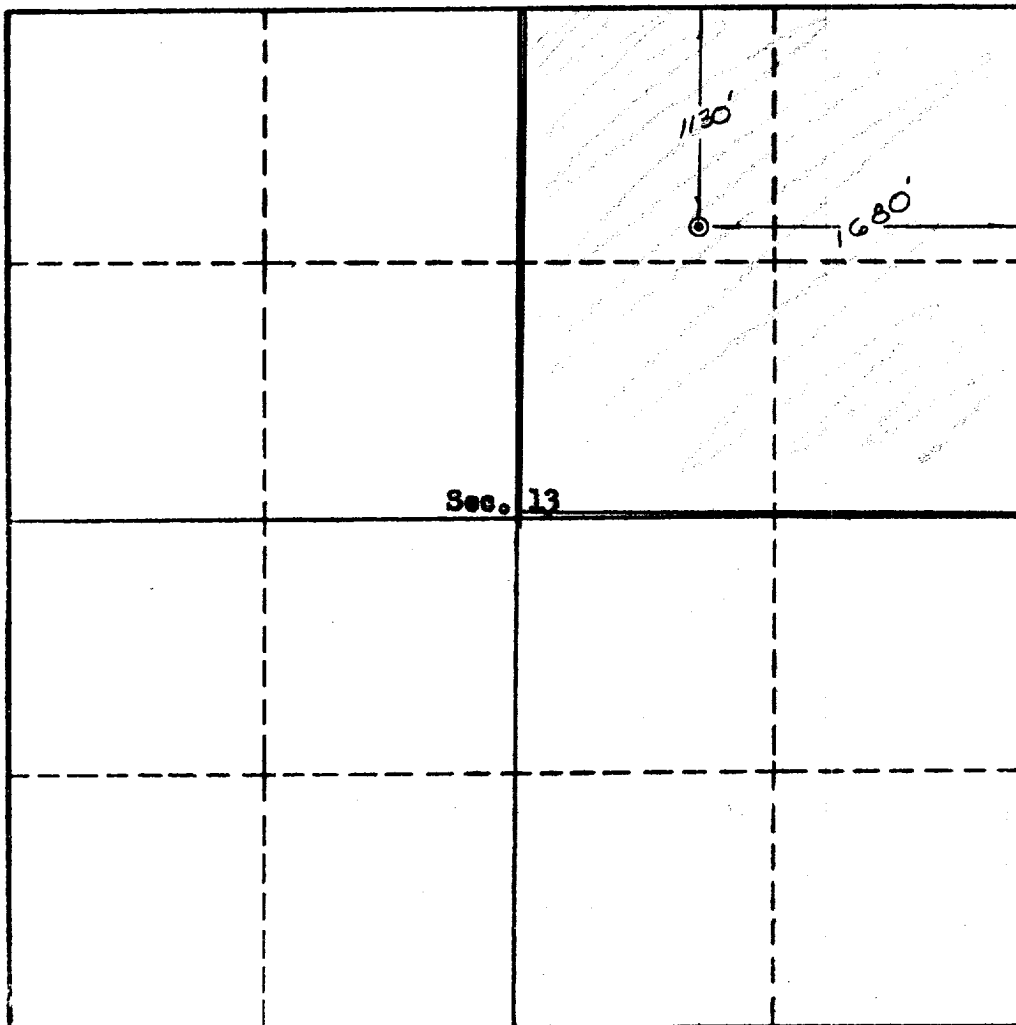

This is to certify that the information in Section A above is true and complete to the best of my knowledge and belief.

Aztec Oil & Gas Company
(Operator)

ORIGINAL SIGNED BY JOE C. SALMON
(Representative)

Box 786, Farmington, N.M.
Address

This is to certify that the well location shown on the plat in Section B is plotted from field notes or actual surveys made by me or under my supervision and that the same is true and correct to the best of my knowledge and belief.

Date Surveyed March 23, 1960

Ernest V. Echoshawk
Ernest V. Echoshawk
Registered Land Surveyor.

Certificate No. 1545



