

NEW MEXICO OIL CONSERVATION COMMISSION

Well Location and Acreage Dedication Plat

Section A.

Date June 5, 1959

Operator Magnolia Petroleum Co. Lease Navajo "A"
Well No. 10 Unit Letter _____ Section 14 Township 31N Range 17W NMPM
Located 2135 Feet From North Line, 2150 Feet From East Line
County San Juan G. L. Elevation 5670 Dedicated Acreage 40 Acres
Name of Producing Formation Gallup Pool Horseshoe Gallup

1. Is the Operator the only owner* in the dedicated acreage outlined on the plat below?
Yes X No _____.
2. If the answer to question one is "no," have the interests of all the owners been consolidated by communitization agreement or otherwise? Yes _____ No _____. If answer is "yes," Type of Consolidation _____
3. If the answer to question two is "no," list all the owners and their respective interests below:

Owner

Land Description

Section B

N 89° 56' W 5288 3'

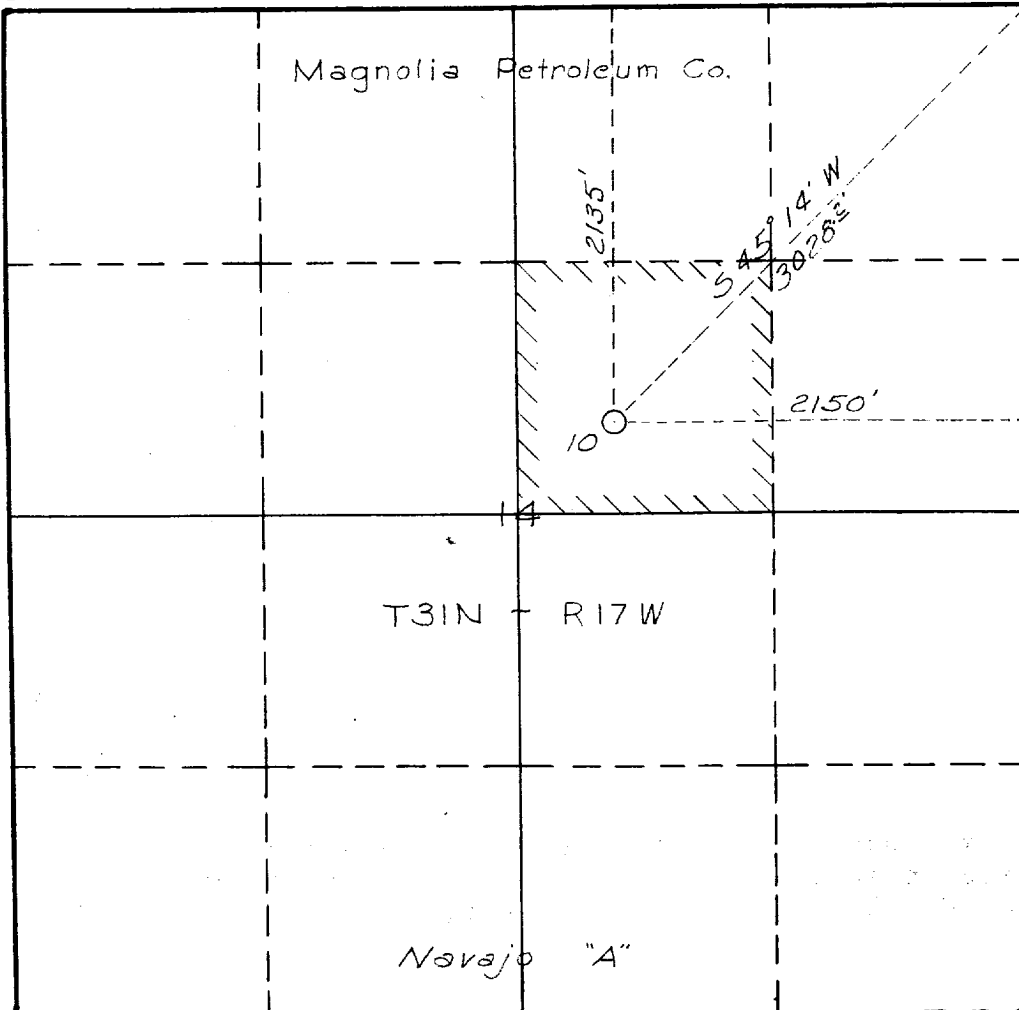

RECEIVED
JUN 9 1959

This is to certify that the information in Section A above is true and complete to the best of my knowledge and belief.

Magnolia Petroleum Company

(Operator)

G. Young, Jr.
(Representative)

Box 2406, Hobbs, New Mexico

Address

This is to certify that the well location shown on the plat in Section B was plotted from field notes of actual surveys made by me or under my supervision and that the same is true and correct to the best of my knowledge and belief.

Date Surveyed 6-2-59

Carl E. Turner
Registered Professional
Engineer and/or Land Surveyor.

Certificate No. 2490

(See instructions for completing this form on the reverse side)