

Form 9-331a
(March 1942)

(SUBMIT IN TRIPLICATE)

UNITED STATES
DEPARTMENT OF THE INTERIOR
GEOLOGICAL SURVEY

Land Office Santa Fe
Lease No. 077648
Unit Et. Sec. 12, T-31-N.,
R-12-W., N.M.P.M.

SUNDRY NOTICES AND REPORTS ON WELLS

NOTICE OF INTENTION TO DRILL.....	<input checked="" type="checkbox"/>	SUBSEQUENT REPORT OF WATER SHUT-OFF.....	
NOTICE OF INTENTION TO CHANGE PLANS.....		SUBSEQUENT REPORT OF SHOOTING OR ACIDIZING.....	
NOTICE OF INTENTION TO TEST WATER SHUT-OFF.....		SUBSEQUENT REPORT OF ALTERING CASING.....	
NOTICE OF INTENTION TO RE-DRILL OR REPAIR WELL.....		SUBSEQUENT REPORT OF REDRILLING OR REPAIR.....	
NOTICE OF INTENTION TO SHOOT OR ACIDIZE.....		SUBSEQUENT REPORT OF ABANDONMENT.....	
NOTICE OF INTENTION TO PULL OR ALTER CASING.....		SUPPLEMENTARY WELL HISTORY.....	
NOTICE OF INTENTION TO ABANDON WELL.....			

(INDICATE ABOVE BY CHECK MARK NATURE OF REPORT, NOTICE, OR OTHER DATA)

MAY 17, 19 51

Well No. 6 DAVIS is located 990 ft. from N line and 1650 ft. from E line of sec. 12

SW 1/4 SE 1/4

(1/4 Sec. and Sec. No.)

T-31-N., R-12-W.,

(Twp.)

(Range)

N.M.P.M.,

(Meridian)

La Plata Field

(Field)

San Juan County

(County or Subdivision)

New Mexico

(State or Territory)

The elevation of the derrick floor above sea level is ft. To be furnished.

DETAILS OF WORK

(State names of and expected depths to objective sands; show sizes, weights, and lengths of proposed casings; indicate mudding jobs, cementing points, and all other important proposed work)

Well to be drilled with rotary tools to top of Point Lookout Sand, which is expected at about 5100'. 5-1/2" casing will be set and cemented with 200 sacks at this point and the well completed with cable tools to a total depth of about 5350'. 10-3/4" O.D. surface casing cemented to surface and about 5200' of 2" tubing will be used. Well to be shot with approximately 800 quarts of nitroglycerine.

I understand that this plan of work must receive approval in writing by the Geological Survey before operations may be commenced.

Company AZTEC OIL & GAS COMPANY

Address 1104 BURT BUILDING

DALLAS, TEXAS

By Law Thompson

Title Chief Engineer

AZTEC OIL & GAS COMPANY

Company ~~SOUTHERN OIL COMPANY~~

Lease DAVIS Well No. 6

Sec. 12 T. 31 N., R. 12 W., N.M.P.M.

Location 990' from S. line; 1650' from E. line

San Juan County

New Mexico

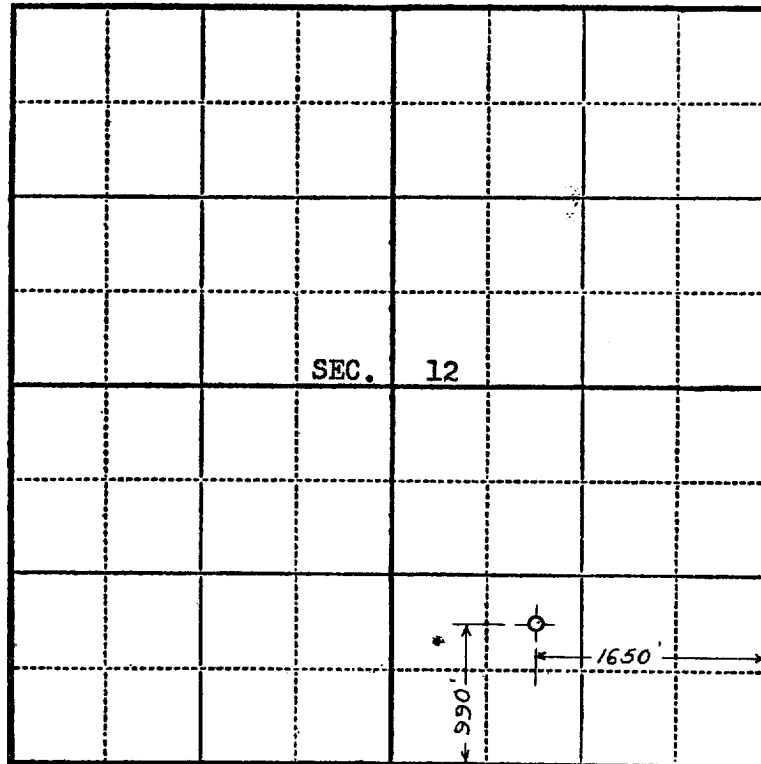

Scale—4 inches equals 1 mile.

This is to certify that the above plat was prepared from field notes of actual surveys made by me or under my supervision and that the same are true and correct to the best of my knowledge and belief.

Seal:

[Signature]
Registered Professional
Engineer and Land Surveyor.

Farmington, New Mexico

Surveyed August, 19 50