

NEW MEXICO OIL CONSERVATION COMMISSION  
Well Location and Acreage Dedication Plat

Section A.

Date August 19, 1957

Operator COLORADO WESTERN EXPLORATION CO. Lease Government-Owned  
Well No. 1-7 Unit Letter H Section 7 Township 31 NORTH Range 12 WEST NMPM  
Located 990 Feet From the SOUTH Line, 990 Feet From the WEST Line  
County SAN JUAN G. L. Elevation 5884.0 Dedicated Acreage 316.21 Acres  
Name of Producing Formation Mesa Verde Pool Blanco

1. Is the Operator the only owner\* in the dedicated acreage outlined on the plat below?  
Yes \_\_\_\_\_ No X
2. If the answer to question one is "no," have the interests of all the owners been consolidated by communitization agreement or otherwise? Yes X No \_\_\_\_\_. If answer is "yes," Type of Consolidation Operating Agreement - Communitization being prepared
3. If the answer to question two is "no," list all the owners and their respective interests below:

Owner

Land Description

RECEIVED

AUG 21 1957

U. S. NATIONAL BANK BLDG.  
DENVER 2, COLORADO

Section B

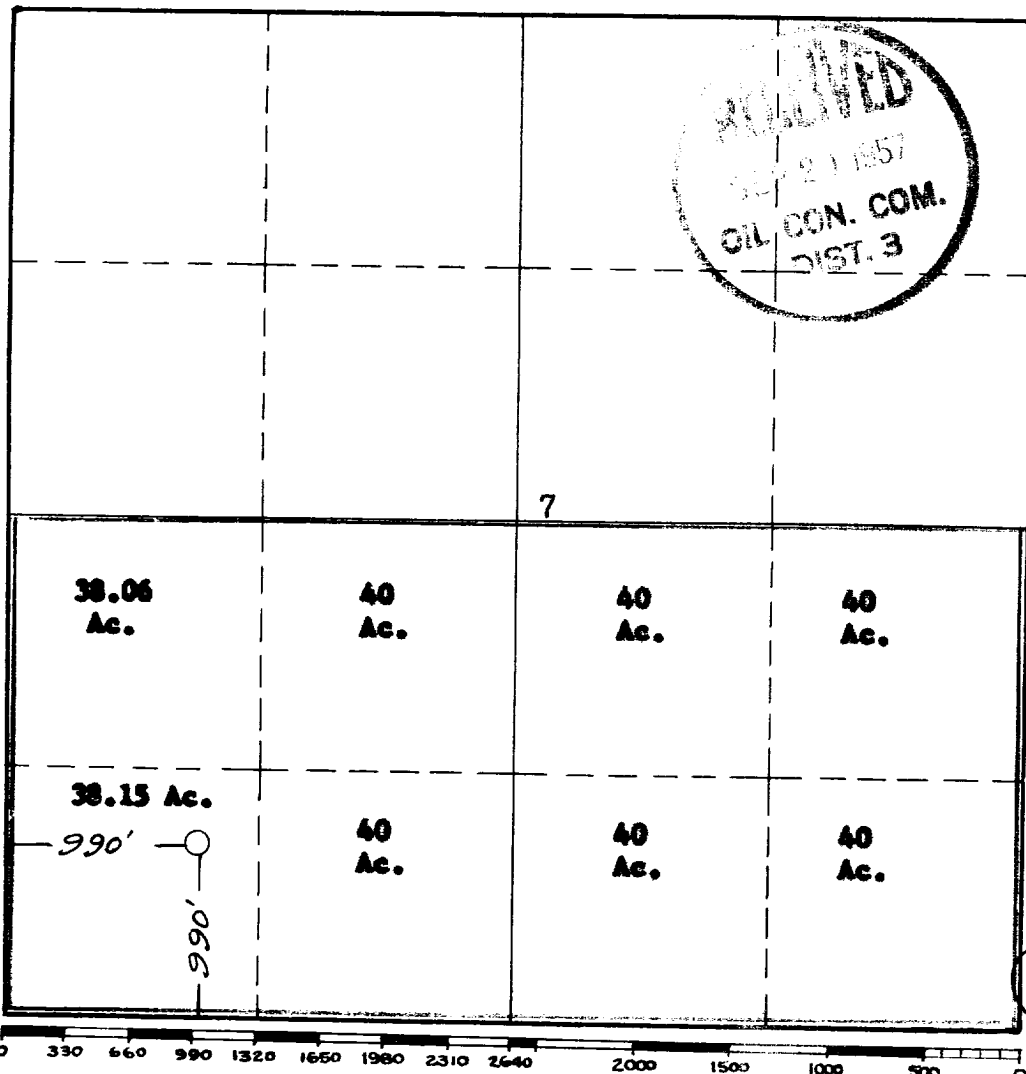

This is to certify that the information in Section A above is true and complete to the best of my knowledge and belief.

**COLORADO WESTERN EXPLORATION, INC.**

(Operator)  
James P. Lease  
312 U. S. National Bank Bldg.  
(Representative)  
Denver 2, Colorado

8-19-57

Address

This is to certify that the well location shown on the plat in Section B was plotted from field notes of actual surveys made by me or under my supervision and that the same is true and correct to the best of my knowledge and belief.

Date Surveyed 29 JUNE 1957

James P. Lease  
Registered Professional  
Engineer and/or Land Surveyor.

James P. Lease

Certificate No. 1463

(See instructions for completing this form on the reverse side)

INSTRUCTIONS FOR COMPLETION:

1. Operator shall furnish and certify to the information called for in Section A.
2. Operator shall outline the dedicated acreage for both oil and gas wells on the plat in Section B.
3. A registered professional engineer or land surveyor registered in the State of New Mexico or approved by the Commission shall show on the plat the location of the well and certify this information in the space provided.
4. All distances shown on the plat must be from the outer boundaries of Section.
5. If additional space is needed for listing owners and their respective interests as required in question 3, Section A, please use space below

OIL CONSERVATION COMMISSION		
AZTEC DISTRICT OFFICE		
No. Copies Received <u>2</u>		
DISTRIBUTION		
Operator		
County Clerk	<u>1</u>	
County Engineer		
County Surveyor		
County Assessor		
County Auditor		
County Treasurer		
County Clerk		
County Engineer		
County Surveyor		
County Assessor		
County Auditor		
County Treasurer		
County Clerk	<u>1</u>	<u>✓</u>

\* "Owner" means the person who has the right to drill into and to produce from any pool and to appropriate the production either for himself or for himself and another. (65-3-29 (e) NMSA 1953 Comp.)