

(SUBMIT IN TRIPLICATE)

Indian Agency Navajo

UNITED STATES
DEPARTMENT OF THE INTERIOR
GEOLOGICAL SURVEY

Allottee _____

Lease No. 14-20-002-2023
Co. Les. No. 234870

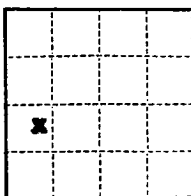

See Attached Plat

SUNDRY NOTICES AND REPORTS ON WELLS

NOTICE OF INTENTION TO DRILL	<input checked="" type="checkbox"/>	SUBSEQUENT REPORT OF WATER SHUT-OFF	
NOTICE OF INTENTION TO CHANGE PLANS		SUBSEQUENT REPORT OF SHOOTING OR ACIDIZING	
NOTICE OF INTENTION TO TEST WATER SHUT-OFF		SUBSEQUENT REPORT OF ALTERING CASING	
NOTICE OF INTENTION TO REDRILL OR REPAIR WELL		SUBSEQUENT REPORT OF REDRILLING OR REPAIR	
NOTICE OF INTENTION TO SHOOT OR ACIDIZE		SUBSEQUENT REPORT OF ABANDONMENT	
NOTICE OF INTENTION TO PULL OR ALTER CASING		SUPPLEMENTARY WELL HISTORY	
NOTICE OF INTENTION TO ABANDON WELL			

(INDICATE ABOVE BY CHECK MARK NATURE OF REPORT, NOTICE, OR OTHER DATA)

Navajo Tribe of Indians

"G"

May 4,

19 59

Well No. 2 is located 1800 ft. from N line and 500 ft. from W line of sec. 11

SW/4 of SW/4 11

(1/4 Sec. and Sec. No.)

31-N

(Twp.)

17-W

(Range)

(Meridian)

Guadalupe
(Field)

San Juan

(County or Subdivision)

New Mexico

(State or Territory)

The elevation of the derrick floor above sea level is later ft.

DETAILS OF WORK

(State names of and expected depths to objective sands; show sizes, weights, and lengths of proposed casings; indicate mudding jobs, cementing points, and all other important proposed work)

CASING PROGRAM
Size Wt. Depth
7" 23# 35'
4" 14# 1500'

CEMENT PROGRAM
Circulate to surface.
Sufficient volume to cement at least
500' above pay zone.

Completion Method: Sand oil fracture with 20,000 gal oil and 30,000# sand.
Halliburton method of cementing to be used.
Proposed total depth 1500' to test Gallup.

I understand that this plan of work must receive approval in writing by the Geological Survey before operations may be commenced.

Company Humble Oil & Refining Company

Address Box 1800

Midland, Texas

By [Signature]

Title Asst. Div. Chief Clerk

OK NSL for gas
ee

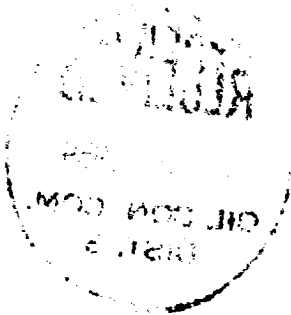

NEW MEXICO OIL CONSERVATION COMMISSION

Well Location and Acreage Dedication Plat

Section A.

Date 5-4-59

Operator HUMBLE OIL & REFG. CO Lease Navajo Tribe of Indians "G"
Well No. 2 Unit Letter "L" Section 11 Township 31 N Range 17 W NMPM
Located 500 Feet From West Line, 1800 Feet From South Line
County San Juan G. L. Elevation _____ Dedicated Acreage 40 Acres
Name of Producing Formation Gallup Sand Pool Chimney Rock

1. Is the Operator the only owner* in the dedicated acreage outlined on the plat below?
Yes ✓ No _____.
2. If the answer to question one is "no," have the interests of all the owners been consolidated by communitization agreement or otherwise? Yes _____ No _____. If answer is "yes," Type of Consolidation _____
3. If the answer to question two is "no," list all the owners and their respective interests below:

Owner

Land Description

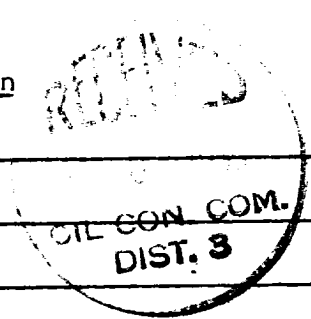

Section B

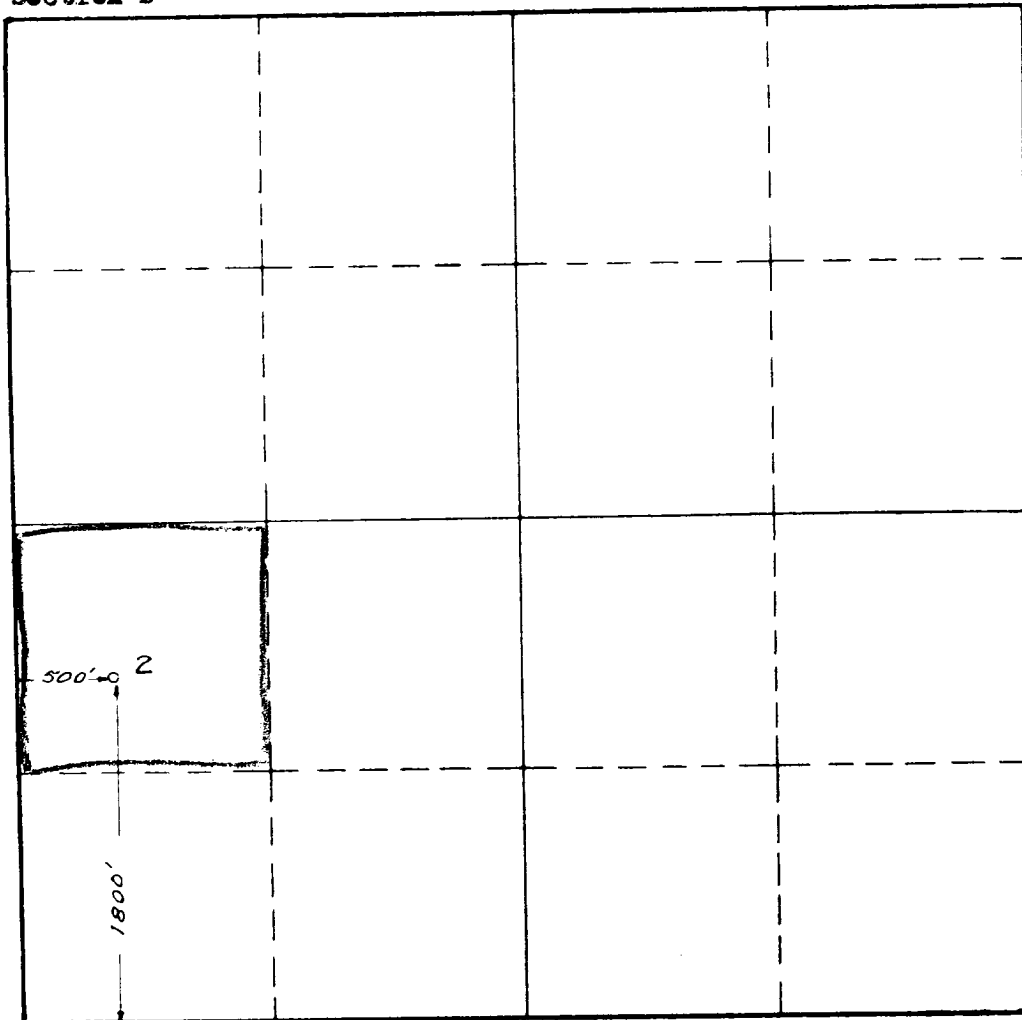

This is to certify that the information in Section A above is true and complete to the best of my knowledge and belief.

HUMBLE OIL & REFG. CO
(Operator)

Kenneth E. Hendricks
(Representative)

Assistant Division Supt.
Box 1600 Midland, Texas
Address

This is to certify that the well location shown on the plat in Section B was plotted from field notes of actual surveys made by me or under my supervision and that the same is true and correct to the best of my knowledge and belief.

Date Surveyed 5-4-59

H. S. Waterfield
Registered Professional
Engineer and/or Land Surveyor.

Certificate No. 1382

LEASE NO. 234870

W-L-A - 2662