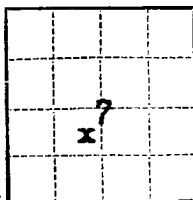

copy

(SUBMIT IN TRIPLICATE)

Indian Agency Navajo TribalUNITED STATES
DEPARTMENT OF THE INTERIOR
GEOLOGICAL SURVEY

Allottee _____

Lease No. Cont. # 14-20-600-3530

SUNDRY NOTICES AND REPORTS ON WELLS

NOTICE OF INTENTION TO DRILL	<input checked="" type="checkbox"/>	SUBSEQUENT REPORT OF WATER SHUT-OFF	
NOTICE OF INTENTION TO CHANGE PLANS		SUBSEQUENT REPORT OF SHOOTING OR ACIDIZING	
NOTICE OF INTENTION TO TEST WATER SHUT-OFF		SUBSEQUENT REPORT OF ALTERING CASING	
NOTICE OF INTENTION TO REDRILL OR REPAIR WELL		SUBSEQUENT REPORT OF REDRILLING OR REPAIR	
NOTICE OF INTENTION TO SHOOT OR ACIDIZE		SUBSEQUENT REPORT OF ABANDONMENT	
NOTICE OF INTENTION TO PULL OR ALTER CASING		SUPPLEMENTARY WELL HISTORY	
NOTICE OF INTENTION TO ABANDON WELL			

(INDICATE ABOVE BY CHECK MARK NATURE OF REPORT, NOTICE, OR OTHER DATA)

U. S. GEOLOGICAL SURVEY
FARMINGTON, NEW MEXICOMarch 11, 1963Well No. 23-7 is located 1880 ft. from S line and 1980 ft. from W line of sec. 7SW 1/4 Sec. 7
(1/4 Sec. and Sec. No.)31N
(Twp.)16W
(Range)NMPM
(Meridian)

(Field)

San Juan
(County or Subdivision)New Mexico
(State or Territory)

Gnd.

The elevation of the ~~surface~~ surface above sea level is 5766 ft.

DETAILS OF WORK

(State names of and expected depths to objective sands; show sizes, weights, and lengths of proposed casings; indicate mudding jobs, cementing points, and all other important proposed work)

1. Drill 13-3/4" hole to 100'. Cement 9-5/8" casing at Plus or Minus 100 feet. Bring cement to surface. Press. test to 600 PSI.
2. Drill 7-7/8" hole to 1800'. Note all oil & gas shows 1500' to 1800'.
3. Run Induction-Gamma & Formation Density logs 1800'/100'. Cement 5-1/2" casing at 1800' with the float valve at 1770'. Bring cement above 1300'. Press. test to 3000 PSI. Clean out to float valve.
4. Jet perf. Juana Lopez at 1760' Plus or Minus (and possibly U. Horseshoe) with 2-1/2" crack jets. Perf. depth determined after logging.
5. Sand-oil frac. if required.
6. Run rods, tubing and pump and put well on production.

I understand that this plan of work must receive approval in writing by the Geological Survey before operation may be commenced.

Company Socony Mobil Oil Company, Inc.Address P. O. Box 3371Durango, ColoradoBy M. J. MeyerTitle Sr. Production Foreman

NEW MEXICO OIL CONSERVATION COMMISSION
WELL LOCATION AND ACREAGE DEDICATION PLAT
SEE INSTRUCTIONS FOR COMPLETING THIS FORM ON THE REVERSE SIDE

FORM C-128
Revised 5/1/57

SECTION A

Operator Socony Mobil Oil Company, Inc.		Lease Chimney Rock		Well No. 23-7	
Unit Letter K	Section 7	Township 31 N	Range 16 W	County San Juan	
Actual Footage Location of Well: 1880 feet from the South line and 1980 feet from the West line					
Ground Level Elev. 5766'	Producing Formation Gallup		Pool unnamed	Dedicated Acreage: 40 Acres	

1. Is the Operator the only owner in the dedicated acreage outlined on the plat below? YES ☒ NO ☐ ("Owner" means the person who has the right to drill into and to produce from any pool and to appropriate the production either for himself or for himself and another. (65-3-29 (e) NMSA 1935 Comp.)
2. If the answer to question one is "no," have the interests of all the owners been consolidated by communitization agreement or otherwise? YES ☐ NO ☐ If answer is "yes," Type of Consolidation _____
3. If the answer to question two is "no," list all the owners and their respective interests below: _____

Owner	Land Description

SECTION B

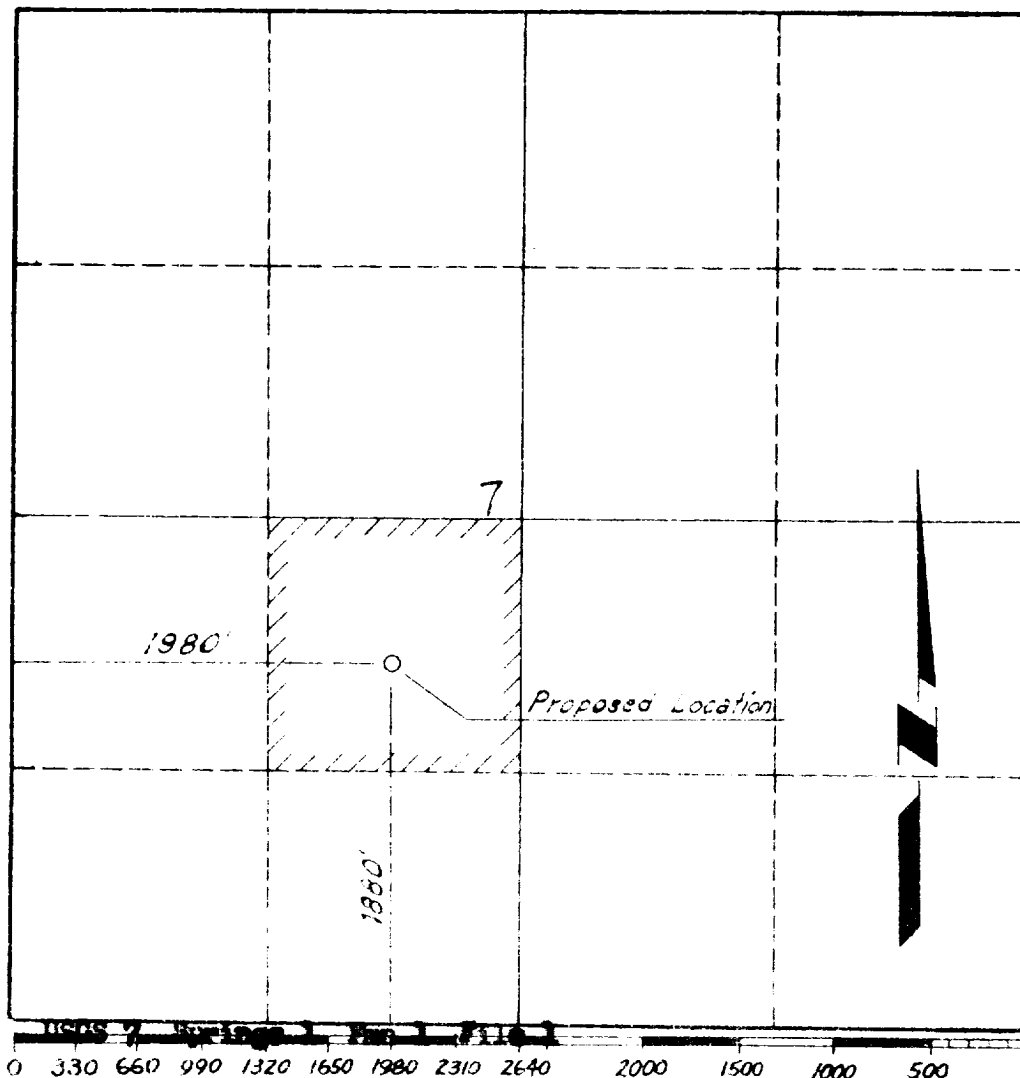

CERTIFICATION

I hereby certify that the information in SECTION A above is true and complete to the best of my knowledge and belief.

Name
M. J. Meyer *M. J. Meyer*
Position
Sr. Production Foreman
Company
Socony Mobil Oil Co., Inc.
Date
March 11, 1963

I hereby certify that the well location shown on the plat in SECTION B was plotted from field notes of actual surveys made by me or under my supervision, and that the same is true and correct to the best of my knowledge and belief.

Date Surveyed
January 23, 1963
Registered Professional Engineer
and/or Land Surveyor
Reynold L. Pedersen
Reynold L. Pedersen
Certificate No.
L. S. 3530