

(SUBMIT IN TRIPLICATE)

Indian Agency

UNITED STATES
DEPARTMENT OF THE INTERIOR
GEOLOGICAL SURVEY

Allettee

Lease No.

SUNDRY NOTICES AND REPORTS ON WELLS

NOTICE OF INTENTION TO DRILL	<input checked="" type="checkbox"/>	SUBSEQUENT REPORT OF WATER SHUT-OFF	<input type="checkbox"/>
NOTICE OF INTENTION TO CHANGE PLANS	<input type="checkbox"/>	SUBSEQUENT REPORT OF SHOOTING OR ACIDIZING	<input type="checkbox"/>
NOTICE OF INTENTION TO TEST WATER SHUT-OFF	<input type="checkbox"/>	SUBSEQUENT REPORT OF ALTERING CASING	<input type="checkbox"/>
NOTICE OF INTENTION TO REDRILL OR REPAIR WELL	<input type="checkbox"/>	SUBSEQUENT REPORT OF REDRILLING OR REPAIR	<input type="checkbox"/>
NOTICE OF INTENTION TO SHOOT OR ACIDIZE	<input type="checkbox"/>	SUBSEQUENT REPORT OF ABANDONMENT	<input type="checkbox"/>
NOTICE OF INTENTION TO PULL OR ALTER CASING	<input type="checkbox"/>	SUPPLEMENTARY WELL HISTORY	<input type="checkbox"/>
NOTICE OF INTENTION TO ABANDON WELL	<input type="checkbox"/>		

(INDICATE ABOVE BY CHECK MARK NATURE OF REPORT, NOTICE, OR OTHER DATA)

RECEIVED
JUN 28 1963
U. S. GEOLOGICAL SURVEY
FARMINGTON, NEW MEXICO

Well No. 27 is located 2500 ft. from [N] line and 500 ft. from [E] line of sec. 22
22 (4 Sec. and Sec. No.) 22E (Twp.) 27W (Range) 109W (Meridian)
San Juan (County or Subdivision) New Mexico (State or Territory)

The elevation of the derrick floor above sea level is 5143 ft. Reported

DETAILS OF WORK

(State names of and expected depths to objective sands; show sizes, weights, and lengths of proposed casings; indicate mudding jobs, cementing points, and all other important proposed work)

Rotary drilling equipment will be used to drill to approximately 2200', a 5" casing will be run and cemented to surface. If production is encountered the required amount of 4" casing will be run and cemented with sufficient cement to cover the highest potentially productive zone. Water and mud will be used for circulation. All zones will be tested and logs will be run prior to setting casing or abandonment. Stimulation treatments may be used in completion.
This is not a true location due to terrain.

I understand that this plan of work must receive approval in writing by the Geological Survey before operations may be commenced.

Company Bumble Oil & Refining Company

Address P. O. Box 2082

Durango, Colorado

By B. M. BRADLEY
COPY (ORIGINAL SIGNED) H. L. FARRIS

Title Dist. Eng.

NEW MEXICO OIL CONSERVATION COMMISSION

Well Location and Acreage Dedication Plat

Section A.

Date

Operator HUMBLE OIL & REFINING COMPANY Lease NAVAJO TRIBE OF INDIANS "G"
 Well No. _____ Unit Letter H Section 12 Township 31 North Range 17 West NMPM
 Located 1820 Feet From North Line 500 Feet From East Line
 County San Juan G. I. Elevation 5343' ungraded Dedicated Acreage 40 Acres
 Name of Producing Formation Gallup Pool unnamed

1. Is the Operator the only owner in the dedicated acreage outlined on the plat below?

Yes ☒ No _____

2. If the answer to question one is "no", have the interests of all the owners been consolidated by communitization agreement or otherwise? Yes _____ No _____. If answer is "yes", Type of Consolidation _____

3. If the answer to question two is "no", list all the owners and their respective interests below:

Owner

Land Description

RECEIVED

JUL 1 1963

CON. COM.
ST. 3

Section B.

Note: All distances must be from outer boundaries of section.

This is to certify that the information
 in Section A above is true and complete
 to the best of my knowledge and belief

HUMBLE OIL & REFINING COMPANY

B. M. BRADLEY (Operator)

BY COPY (ORIGINAL SIGNED) H. L. FARRIS
(Representative)

P. O. BOX 3082

(Address)

Durango, Colorado

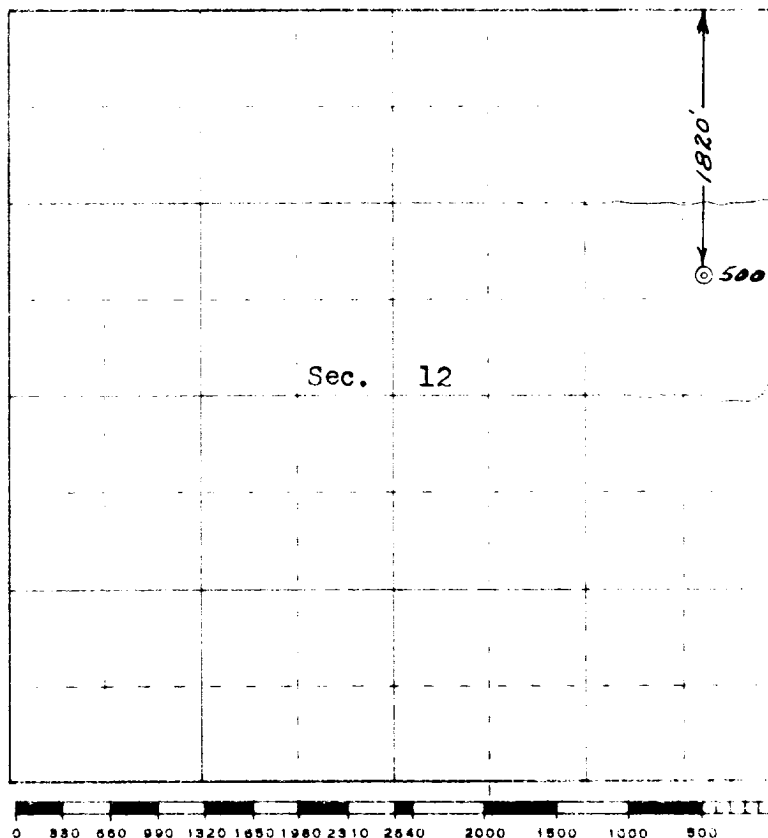

Scale 4 inches equal 1 mile

This is to certify that the above plat was prepared from field notes of actual surveys
 made by me or under my supervision and that the same are true and correct to the best
 of my knowledge and belief.

(Seal)

Date Surveyed 26 June 1963

Robert H. ...
 Registered Professional Engineer and/or Land Surveyor
 Robert H. ...

Farmington, New Mexico
 San Juan Engineering Co.

31. 3. 47

1947

1947