

(SUBMIT IN TRIPLICATE)

Indian Agency Navajo

UNITED STATES
DEPARTMENT OF THE INTERIOR
GEOLOGICAL SURVEY

Allottee _____

Lease No. 14-20-403-2034
Co. Les. No. 234871

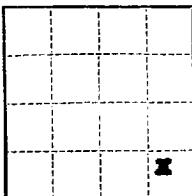

See Attached Plat

SUNDRY NOTICES AND REPORTS ON WELLS

NOTICE OF INTENTION TO DRILL.....	<input checked="" type="checkbox"/>	SUBSEQUENT REPORT OF WATER SHUT-OFF.....	
NOTICE OF INTENTION TO CHANGE PLANS.....		SUBSEQUENT REPORT OF SHOOTING OR ACIDIZING.....	
NOTICE OF INTENTION TO TEST WATER SHUT-OFF.....		SUBSEQUENT REPORT OF ALTERING CASING.....	
NOTICE OF INTENTION TO REDRILL OR REPAIR WELL.....		SUBSEQUENT REPORT OF REDRILLING OR REPAIR.....	
NOTICE OF INTENTION TO SHOOT OR ACIDIZE.....		SUBSEQUENT REPORT OF ABANDONMENT.....	
NOTICE OF INTENTION TO PULL OR ALTER CASING.....		SUPPLEMENTARY WELL HISTORY.....	
NOTICE OF INTENTION TO ABANDON WELL.....			

(INDICATE ABOVE BY CHECK MARK NATURE OF REPORT, NOTICE, OR OTHER DATA)

Navajo Tribe of Indians F

May 7, 19 59

Well No. 24 is located 660 ft. from S line and 660 ft. from E line of sec. 4
SE/4 of SE/4 4 31-N 17-W MEM
 (1/4 Sec. and Sec. No.) (Twp.) (Range) (Meridian)
Chimney Rock (Gallup) San Juan New Mexico
 (Field) (County or Subdivision) (State or Territory)

The elevation of the derrick floor above sea level is later ft.

DETAILS OF WORK

(State names of and expected depths to objective sands; show sizes, weights, and lengths of proposed casings; indicate mudding jobs, cementing points, and all other important proposed work)

CASING PROGRAM

CEMENT PROGRAM

CORING PROGRAM

Size Wt. Depth
7-5/8" 25.4# 35'
5" 18# 1100'

Circulate to surface.
Sufficient volume to cement at least
500' above pay zone.

None

Completion Method: Sand oil fracture with 20,000 gal oil and 30,000# sand.
Halliburton method of cementing to be used.
Proposed total depth 1100' to test Gallup.



I understand that this plan of work must receive approval in writing by the Geological Survey before operations may be commenced.

Company Humble Oil & Refining Co.

Address Box 1800
Midland, Texas

By

Title Asst. Div. Chief Clerk



NEW MEXICO OIL CONSERVATION COMMISSION
Well Location and Acreage Dedication Plat

Section A.

Date May 6, 1959

Operator HUMBLE OIL & REFG. CO Lease Navajo Tribe of Indians "F"
Well No. 24 Unit Letter "P" Section 4 Township 31-N Range 17-W NMPM
Located 660 Feet From South Line, 660 Feet From East Line
County San Juan G. L. Elevation _____ Dedicated Acreage 40 Acres
Name of Producing Formation Gallup Sand Pool Chimney Rock

1. Is the Operator the only owner* in the dedicated acreage outlined on the plat below?
Yes ☒ No ☐.
2. If the answer to question one is "no," have the interests of all the owners been consolidated by communitization agreement or otherwise? Yes ☐ No ☐. If answer is "yes," Type of Consolidation _____
3. If the answer to question two is "no," list all the owners and their respective interests below:

Owner

Land Description

Section B

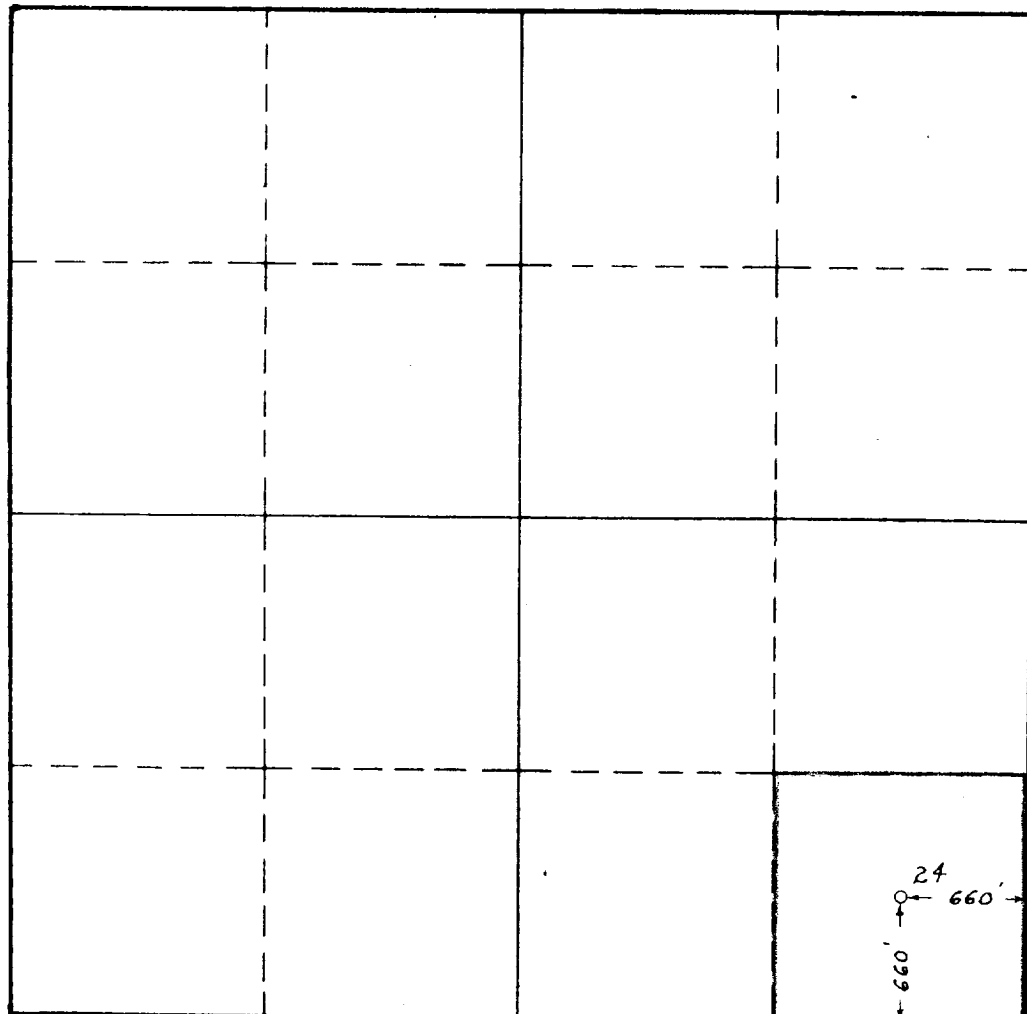

This is to certify that the information in Section A above is true and complete to the best of my knowledge and belief.

HUMBLE OIL & REFG. CO
(Operator)

(Representative)
Assistant Division Supt.
Box 1600 Midland, Texas
Address

This is to certify that the well location shown on the plat in Section B was plotted from field notes of actual surveys made by me or under my supervision and that the same is true and correct to the best of my knowledge and belief.

Date Surveyed 5-5-59

W. S. Minter
Registered Professional
Engineer and/or Land Surveyor.

Certificate No. 1382

LEASE NO. 234871

W-A - 2580