

(SUBMIT IN TRIPLICATE)

Indian Agency Navajo

UNITED STATES
DEPARTMENT OF THE INTERIOR
GEOLOGICAL SURVEY

Allettee _____

Lease No. 21-00-003-003

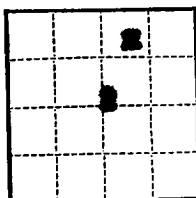

SUNDRY NOTICES AND REPORTS ON WELLS

NOTICE OF INTENTION TO DRILL	<input checked="" type="checkbox"/>	SUBSEQUENT REPORT OF WATER SHUT-OFF	
NOTICE OF INTENTION TO CHANGE PLANS		SUBSEQUENT REPORT OF SHOOTING OR ACIDIZING	
NOTICE OF INTENTION TO TEST WATER SHUT-OFF		SUBSEQUENT REPORT OF ALTERING CASING	
NOTICE OF INTENTION TO REDRILL OR REPAIR WELL		SUBSEQUENT REPORT OF REDRILLING OR REPAIR	
NOTICE OF INTENTION TO SHOOT OR ACIDIZE		SUBSEQUENT REPORT OF ABANDONMENT	
NOTICE OF INTENTION TO PULL OR ALTER CASING		SUPPLEMENTARY WELL HISTORY	
NOTICE OF INTENTION TO ABANDON WELL			

(INDICATE ABOVE BY CHECK MARK NATURE OF REPORT, NOTICE, OR OTHER DATA)

June 24, 1963

Navajo Tribe of Indians
Well No. 25 is located 200 ft. from N line and 200 ft. from E line of sec.

NE 1/4 Section 2 (1/4 Sec. and Sec. No.)
SW 1/4 (Twp.)
SW 1/4 (Range)
SW 1/4 (Meridian)
Navajo Nation (Field)
San Juan (County or Subdivision)
New Mexico (State or Territory)

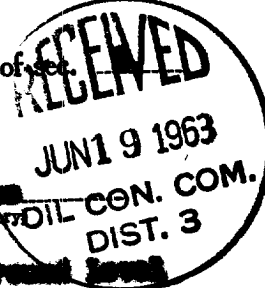

The elevation of the derrick floor above sea level is 2000 ft. 2000' Elevation Ground Level

DETAILS OF WORK

(State names of and expected depths to objective sands; show sizes, weights, and lengths of proposed casings; indicate mudding jobs, cementing points, and all other important proposed work)

Rotary drilling equipment will be used to drill to approximately 1300', a
Saturated test. One joint of either 7" or 8-5/8" surface casing will be run
and cemented to surface. If production is encountered the required amount of
1 1/2" casing will be run and cemented with sufficient cement to cover the highest
potentially productive zone. Air will be used for circulation to top of pay,
converting to mud to total depth. All zones will be tested and logs will be
run prior to setting casing or abandonment. Stimulation treatments may be used
in completion.

Note: Location moved as true location falls on side of steep bluff.

I understand that this plan of work must receive approval in writing by the Geological Survey before operations may be commenced.

Company Navajo Oil & Refining Company

Address P. O. Box 3000

Durango, Colorado

By COPY (ORIGINAL SIGNED) B. M. BRADLEY

Title Dist. Eng.

NUMBER OF COPIES RECEIVED	
DISTRIBUTION	
SANITARY	
FILE	
U.S.G.S.	
LAND OFFICE	
TRANSPORTER	OIL GAS
PRODUCTION OFFICE	
OPERATOR	

NEW MEXICO OIL CONSERVATION COMMISSION
WELL LOCATION AND ACREAGE DEDICATION PLAT
 SEE INSTRUCTIONS FOR COMPLETING THIS FORM ON THE REVERSE SIDE

FORM C-128
 Revised 5/1/57

SECTION A

Operator HUMBLE OIL & REFINING COMPANY		Lease NAVAJO TRIBE OF INDIANS "G"		Well No. 15
Unit Letter B	Section 2	Township 31 North	Range 17 West	County San Juan
Actual Footage Location of Well: 805 feet from the North line and 1940 feet from the East line				
Ground Level Elev. 5429' ungraded	Producing Formation Gallup	Pool unnamed	Dedicated Acreage: 40 Acres	

1. Is the Operator the only owner in the dedicated acreage outlined on the plat below? YES ☒ NO ____ . ("Owner" means the person who has the right to drill into and to produce from any pool and to appropriate the production either for himself or for himself and another. (65-3-29 (e) NMSA 1935 Comp.)
2. If the answer to question one is "no," have the interests of all the owners been consolidated by community agreement or otherwise? YES ____ NO ____ . If answer is "yes," Type of Consolidation ____
3. If the answer to question two is "no," list all the owners and their respective interests below:

Owner	Land Description

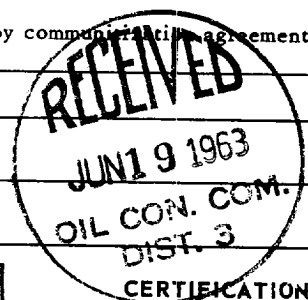

SECTION B

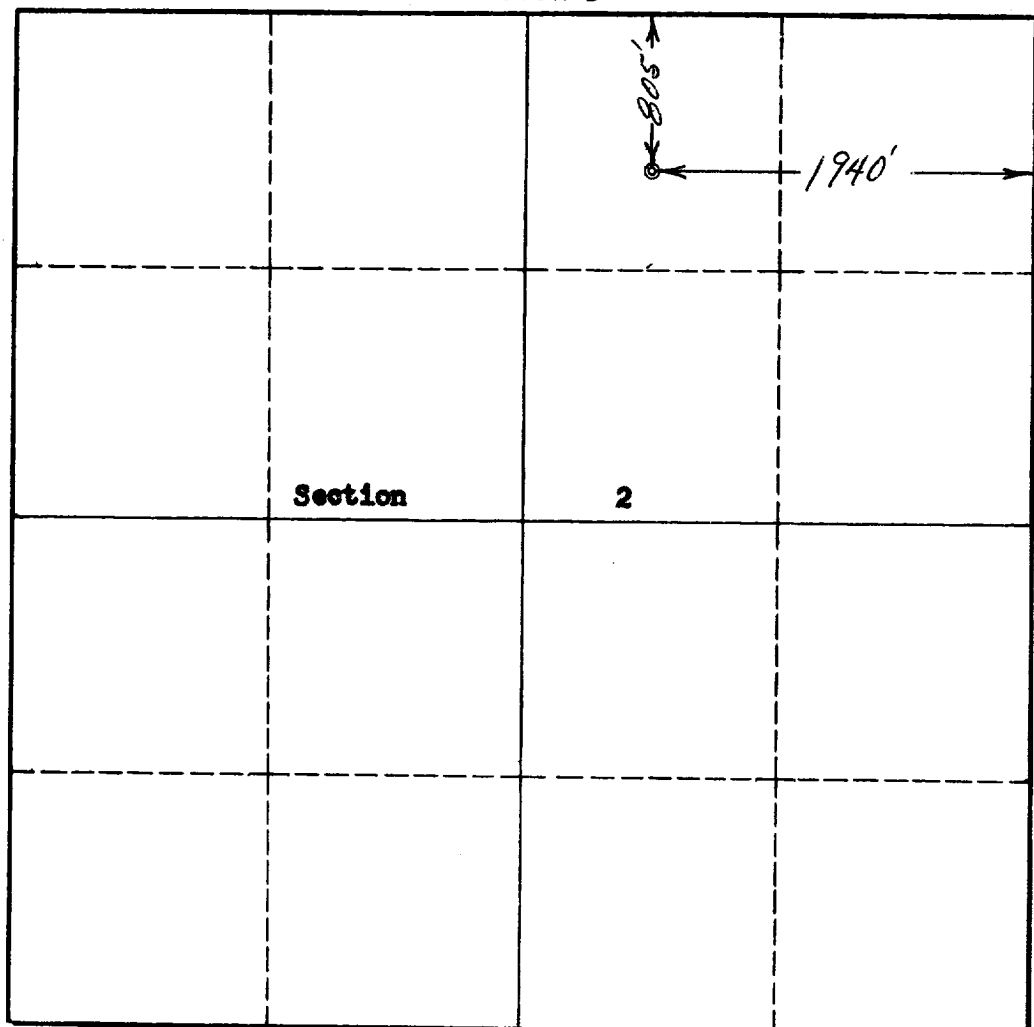

I hereby certify that the information in SECTION A above is true and complete to the best of my knowledge and belief.

Name COPY (ORIGINAL SIGNED) B. M. BRADLEY
Position Dist. Supt.
Company HUMBLE OIL & REFINING CO.
Date JUN 14 1963

I hereby certify that the well location shown on the plat in SECTION B was plotted from field notes of actual surveys made by me or under my supervision, and that the same is true and correct to the best of my knowledge and belief.

Date Surveyed 13 June 1963
Registered Professional Engineer and/or Land Surveyor
Certificate No. N. Mex. PE & LS 2463

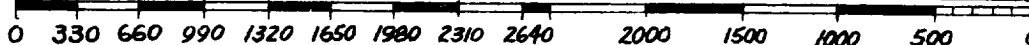

San Juan Engineering Co.

INSTRUCTIONS FOR COMPLETION OF FORM C-128

1. Operator shall furnish and certify to the information called for in Section A.
2. Operator shall outline the dedicated acreage for *both* oil and gas wells on the plat in Section B.
3. A registered professional engineer or land surveyor registered in the State of New Mexico or approved by the Commission shall show on the plat the location of the well and certify this information in the space provided.
4. All distances shown on the plat must be from the outer boundaries of the Section.
5. If additional space is needed for listing owners and their respective interests as required in question 3 of Section A, please use space below.