



(SUBMIT IN TRIPLICATE)

UNITED STATES  
DEPARTMENT OF THE INTERIOR  
GEOLOGICAL SURVEY

Land Office Santa Fe

Lease No. 07692

Unit 8 1/2 of Sec. 30 is  
Designated Drilling Unit.

SUNDRY NOTICES AND REPORTS ON WELLS

NOTICE OF INTENTION TO DRILL	<input checked="" type="checkbox"/>	SUBSEQUENT REPORT OF WATER SHUT-OFF	
NOTICE OF INTENTION TO CHANGE PLANS		SUBSEQUENT REPORT OF SHOOTING OR ACIDIZING	
NOTICE OF INTENTION TO TEST WATER SHUT-OFF		SUBSEQUENT REPORT OF ALTERING CASING	
NOTICE OF INTENTION TO RE-DRILL OR REPAIR WELL		SUBSEQUENT REPORT OF REDRILLING OR REPAIR	
NOTICE OF INTENTION TO SHOOT OR ACIDIZE		SUBSEQUENT REPORT OF ABANDONMENT	
NOTICE OF INTENTION TO PULL OR ALTER CASING		SUPPLEMENTARY WELL HISTORY	
NOTICE OF INTENTION TO ABANDON WELL			

(INDICATE ABOVE BY CHECK MARK NATURE OF REPORT, NOTICE, OR OTHER DATA)

June 17, 1952

Hamilton Federal  
Well No. No. 1 is located 290 ft. from N line and 290 ft. from E line of sec. 30

34 3/4 Section 30 32N 10W R2E  
(1/4 Sec. and Sec. No.) (Twp.) (Range) (Meridian)  
Blanco Mesa Verde San Juan County New Mexico  
(Field) (County or Subdivision) (State or Territory)

The elevation of the derrick floor above sea level is 6,124 ft.

DETAILS OF WORK

(State names of and expected depths to objective sands; show sizes, weights, and lengths of proposed casings; indicate mudding jobs, cementing points, and all other important proposed work)

It is proposed to drill with Rotary mud to the top of the Mesa Verde formation estimated to be at a depth of 4,600' and thereafter to drill with gas through the Mesa Verde formation or the top of the Mancos shale. Final TD estimated 5,500'. It is further proposed to shoot the entire Mesa Verde section with solid nitro glycerine. Tentative casing program is as follows:

10 3/4 surface casing 150-250' cement w/ 150-200 size  
7" casing 4,600' cement w/ 250-300 size

I understand that this plan of work must receive approval in writing by the Geological Survey before operations may be commenced.

Company Pubco Development, Inc.

Address P.O. Box 1360

Albuquerque, New Mexico

By Frank J. Gorham, Jr.

Title Vice President

Company Pubco Development, Inc.

Lease \_\_\_\_\_ Well No. \_\_\_\_\_

Sec 30 T. 32 N. R. 10 W. N.M.P.M.

Location 990' from the South line and 990' from the West line.



San Juan County

New Mexico

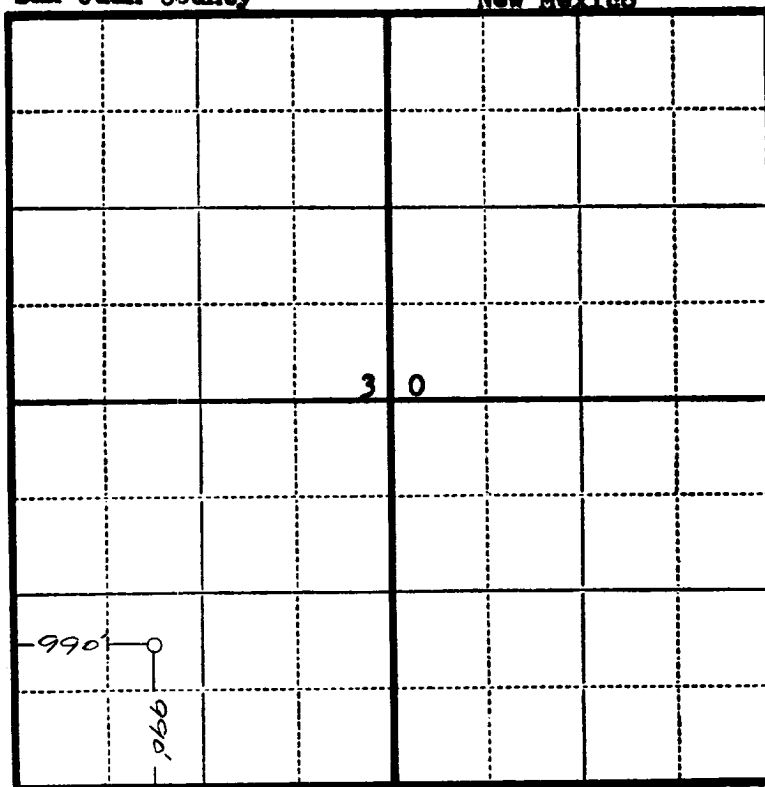

Scale—4 inches equals 1 mile.

This is to certify that the above plat was prepared from field notes of actual surveys made by me or under my supervision and that the same are true and correct to the best of my knowledge and belief.

Seal:

Registered Professional  
Engineer and Land Surveyor.

Charles J. Finklea  
N. Mex. Reg. No. 1302

Surveyed June 12, 1952