

Well Location and Acreage Dedication Plat

Section A.

Date **February 25, 1963**

Operator *Tenneco Oil Co.*
DELHI TAYLOR OIL CORPORATION Lease Barnes
 Well No. 1 Unit Letter A Section 26 Township 32 NORTH Range 11 WEST NMPM
 Located 850 Feet From the NORTH Line, 840 Feet From the EAST Line
 County SAN JUAN G. L. Elevation 6329. Dedicated Acreage 320 Acres
 Name of Producing Formation Dakota Pool Basin Dakota

1. Is the Operator the only owner in the dedicated acreage outlined on the plat below?

Yes XXX No

2. If the answer to question one is "no", have the interests of all the owners been consolidated by community agreement or otherwise? Yes No. If answer is "yes", Type of Consolidation.

3. If the answer to question two is "no", list all the owners and their respective interests below:

Land Description

RECEIVED

AUG 26 1965

U. S. GEOLOGICAL SURVEY
FARMINGTON, N. M.

RECEIVED

AUG 27 1965

OIL CON. COM.
DIST. 3

CORRECTED DEDICATED ACREAGE

N/2

8.24-65

Section B.

This is to certify that the information
in Section A above is true and complete
to the best of my knowledge and belief.

Delhi-Taylor Oil Corporation

(Operator)

A. Gibson

(Representative)

P. O. Drawer 1198

(Address)

Farmington, New Mexico

Ref: BLM plat dated 22 Jan. 1957

Note: All distances must be from outer boundaries of section.

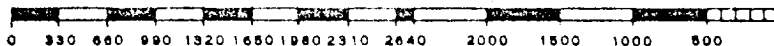
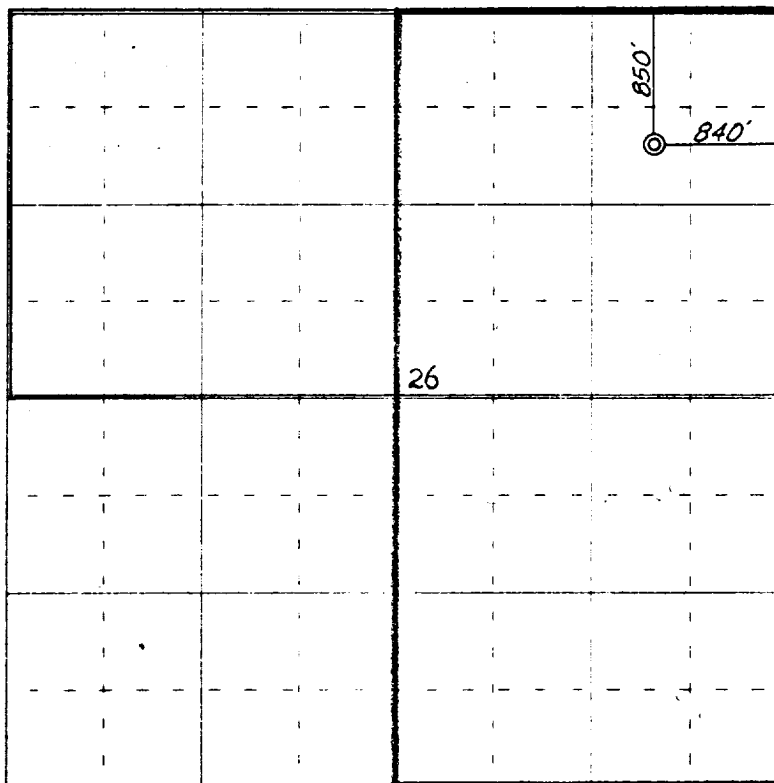

Scale 4 inches equal 1 mile

This is to certify that the above plat was prepared from field notes of actual surveys
made by me or under my supervision and that the same are true and correct to the best
of my knowledge and belief.

(Seal)

Farmington, New Mexico

Date Surveyed 21 February 1963

James P. Reese
 Registered Professional Engineer and/or Land Surveyor
 James P. Reese, N. Mex. Reg. No. 1463
 San Juan Engineering Company