

(SUBMIT IN TRIPLICATE)

UNITED STATES
DEPARTMENT OF THE INTERIOR
GEOLOGICAL SURVEY

Land Office **New Mexico**

Lease No. **03189**

Unit **Cox Canyon**

RECEIVED

JAN 26 1953

SUNDRY NOTICES AND REPORTS ON WELLS
U. S. GEOLOGICAL SURVEY
FARMINGTON, N. M.

NOTICE OF INTENTION TO DRILL.....	SUBSEQUENT REPORT OF WATER SHUT-OFF.....
NOTICE OF INTENTION TO CHANGE PLANS.....	SUBSEQUENT REPORT OF SHOOTING OR ACIDIZING.....
NOTICE OF INTENTION TO TEST WATER SHUT-OFF.....	SUBSEQUENT REPORT OF ALTERING CASING.....
NOTICE OF INTENTION TO RE-DRILL OR REPAIR WELL.....	SUBSEQUENT REPORT OF RE-DRILLING OR REPAIR.....
NOTICE OF INTENTION TO SHOOT OR ACIDIZE.....	SUBSEQUENT REPORT OF ABANDONMENT.....
NOTICE OF INTENTION TO PULL OR ALTER CASING.....	SUPPLEMENTARY WELL HISTORY.....
NOTICE OF INTENTION TO ABANDON WELL.....	Subsequent Report of Spudding
Notice of Changed Location	I

(INDICATE ABOVE BY CHECK MARK NATURE OF REPORT, NOTICE, OR OTHER DATA)

January 26, 19**53**

Well No. **1** is located **950** ft. from **111** line and **1600** ft. from **E** line of sec. **20**

Sec. 20 (Sec. and Sec. No.) **32 N.** (Twp.) **21 W.** (Range) **N.M.P.M.** (Meridian)
Blanco (Field) **San Juan** (County or Subdivision) **New Mexico** (State or Territory)

The elevation of the derrick floor above sea level is **6694** ft. (**Ground Level**)

DETAILS OF WORK

(State names of and expected depths to objective sands; show sizes, weights, and lengths of proposed casings; indicate mudding jobs, cementing points, and all other important proposed work)

Well was spudded on January 26, 1953.

Location changed from 970' S to 950' S and from 1650' E to 1600' E lines of section 20.

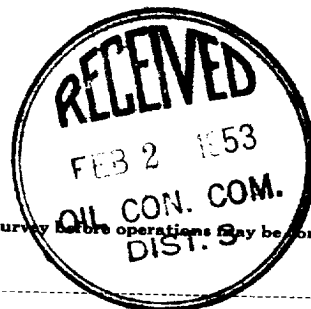

I understand that this plan of work must receive approval in writing by the Geological Survey before operations may be commenced.

Company **DENA RIDDLE**

Address **P. O. Box 1055**

Albuquerque, New Mexico

By

Title

J. E. Connors
Agent.

Company.....H. K. Riddle.....

Lease.....Dena Riddle.....Well No.....1.....

Sec. 20, T. 32 N., R. 11 W., N.M.P.M.

Location 950' from the South line and 1600' from
the East line.

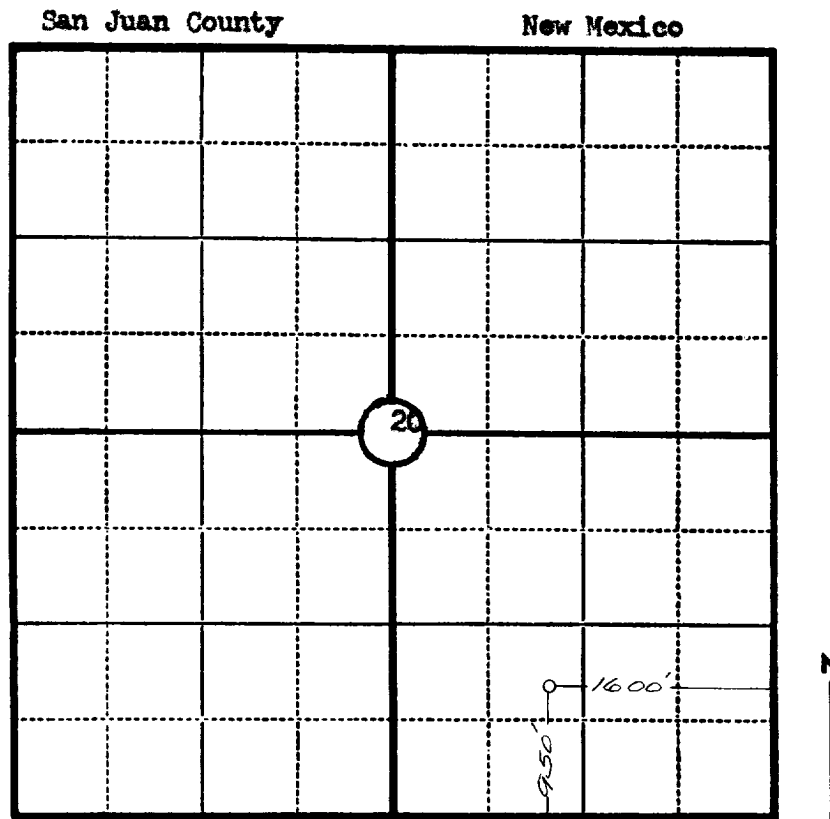

Scale—4 inches equal 1 mile.

This is to certify that the above plat was prepared from field notes of actual surveys made by me or under my supervision and that the same are true and correct to the best of my knowledge and belief.

Seal:

James P. Leese
Registered Professional
Engineer and Land Surveyor.

James P. Leese
N. Mex. Reg. No. 1463

Surveyed January 15, 1953