

NEW MEXICO OIL CONSERVATION COMMISSION
Santa Fe, New Mexico

NOTICE OF INTENTION TO DRILL OR RECOMPLETE

Notice must be given to the District Office of the Oil Conservation Commission and approval obtained before drilling or recompletion begins. If changes in the proposed plan are considered advisable, a copy of this notice showing such changes will be returned to the sender. Submit this notice in QUINTUPLICATE. One copy will be returned following approval. See additional instructions in Rules and Regulations of the Commission.

Farmington, New Mexico
(Place)

May 27, 1954
(Date)

OIL CONSERVATION COMMISSION
SANTA FE, NEW MEXICO

Gentlemen:

You are hereby notified that it is our intention to commence the (Drilling) (Recompletion) of a well to be known as

Stanolind Oil and Gas Company

(Company or Operator)

Sullivan Gas Unit "A"

(Lease)

Well No. **1**, in **M** (Unit) The well is

located **935** feet from the **South** line and **1125** feet from the

West line of Section **22**, T. **32-N**, R. **10-W**, NMPM.

(GIVE LOCATION FROM SECTION LINE) **Blanco-Mesaverte** Pool, **San Juan** County

D	C	B	A
E	F	G	H
L	K	J	I
M	N	O	P

If State Land the Oil and Gas Lease is No.

If patented land the owner is **Mrs. Jessie Keys**

Address **Artes, New Mexico**

We propose to drill well with drilling equipment as follows: **Rotary tools from surface to proposed total depth of 5100'.**

The status of plugging bond is **On file with Commission**

Drilling Contractor **Iron Drilling Company**

1206 Philhower Building

Tulsa, Oklahoma

We intend to complete this well in the **Mesaverte**

formation at an approximate depth of **5100**

CASING PROGRAM

We propose to use the following strings of Casing and to cement them as indicated:

Size of Hole	Size of Casing	Weight per Foot	New or Second Hand	Depth	Sacks Cement
12-1/4"	9-5/8"	32.3#	New	250	200
8-3/4"	7"	20#	New	4400	150

If changes in the above plans become advisable we will notify you immediately.

ADDITIONAL INFORMATION (If recompletion give full details of proposed plan of work.)

Designated drilling unit, W/2 of Section 22. Lease plats to be submitted at a later date. Copies of location plats attached. Ground level elevation to be reported later. A copy of any survey taken will be submitted upon completion of well.

Approved.....**5-29**, 19**54**
Except as follows:

Sincerely yours,

Stanolind Oil and Gas Company
(Company or Operator)

By **[Signature]**

Position **Field Superintendent**

Send Communications regarding well to

Name **Mr. L. O. Speer, Jr.**

Address **Box 487**

Farmington, New Mexico

OIL CONSERVATION COMMISSION

By **[Signature]**

Title **Oil and Gas Inspector Dist. #3.**

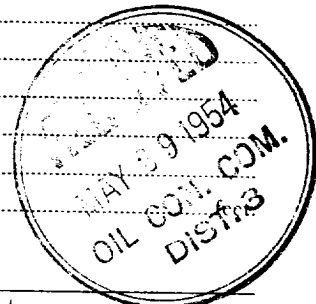

Con. (I.P.) Established by surveying
 from E. Line of Twp. S. 85° 10' 25" E.

T. 32 N. R. 10 W.
 16. 15
 21. 22

N 2° 00' 30" W
 5263.65

4807.65 E.
 S. 11° 32' E.

22

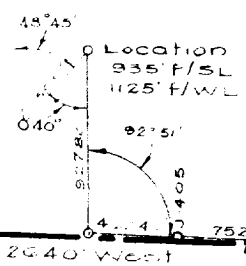

Stationed
 Survey Point
 Field Stone

4 22
 27

RECEIVED
 MAY 29 1954
 OIL CON. COM.
 DIST. 3

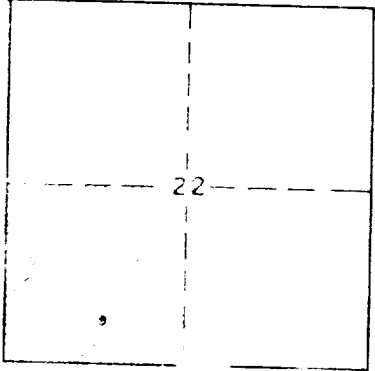

Sullivan Gas Unit "A" No. 1

STANOLIND OIL & GAS CO.

WELL LOCATION, SW 1/4, SEC. 22
 T. 32 N., R. 10 W., SAN JUAN COUNTY,
 NEW MEXICO - N.M.P.M.

MARCH 27, 1954 SCALE: 1"=1000'

DRAWN BY: *[Signature]*

This is to certify, that the above
 plat was prepared from field
 notes of actual surveys made by
 me and that same are true and
 correct to the best of my know-
 ledge and belief.

James P. Leese
 James P. Leese
 Registered Surveyor
 Reg. No. 1463

OIL CONSERVATION COMMISSION
 AZTEC DISTRICT OFFICE

No. Copies Received 5

DISTRIBUTION

	NO. FURNISHED	
Operator	1	
Santa Fe	1	
Proration Office		
State Land Office		
U. S. G. S.	2	
Transporter	1	✓
File		