

(SUBMIT IN TRIPLICATE)

UNITED STATES  
DEPARTMENT OF THE INTERIOR  
GEOLOGICAL SURVEY

Land Office **Santa Fe**

Lease No. **078499**

Unit **San Juan 32-7 Unit**  
**14-08-001-441**

SUNDRY NOTICES AND REPORTS ON WELLS

NOTICE OF INTENTION TO DRILL.....	<input checked="" type="checkbox"/>	SUBSEQUENT REPORT OF WATER SHUT-OFF.....	
NOTICE OF INTENTION TO CHANGE PLANS.....		SUBSEQUENT REPORT OF SHOOTING OR ACIDIZING.....	
NOTICE OF INTENTION TO TEST WATER SHUT-OFF.....		SUBSEQUENT REPORT OF ALTERING CASING.....	
NOTICE OF INTENTION TO RE-DRILL OR REPAIR WELL.....		SUBSEQUENT REPORT OF RE-DRILLING OR REPAIR.....	
NOTICE OF INTENTION TO SHOOT OR ACIDIZE.....		SUBSEQUENT REPORT OF ABANDONMENT.....	
NOTICE OF INTENTION TO PULL OR ALTER CASING.....		SUPPLEMENTARY WELL HISTORY.....	
NOTICE OF INTENTION TO ABANDON WELL.....			

(INDICATE ABOVE BY CHECK MARK NATURE OF REPORT, NOTICE, OR OTHER DATA)

June 17, 1955, 19

Well No. **9-22** is located **2690** ft. from **N** line and **1690** ft. from **E** line of sec. **22**

**3N 22E Sec 22** **32N** **7W** **N. M. P. M.**  
(1/4 Sec. and Sec. No.) (Twp.) (Range) (Meridian)

**Klamath** **San Juan County** **New Mexico**  
(Field) (County or Subdivision) (State or Territory)

The elevation of the ~~ungraded ground~~ above sea level is **6601.8**.

DETAILS OF WORK

(State names of and expected depths to objective sands; show sizes, weights, and lengths of proposed casings; indicate mudding jobs, cementing points, and all other important proposed work)

Propose to drill 15" hole to 200' and set 10-3/4" casing at that point, cementing with 200 sacks 4% gal. Drill w/ mud to approximately 3630', set and cement 7-5/8" OD casing w/ 200 sacks 8% gal cement. Then drill w/ gas to approximately 3630, set and cement 5-1/2" casing w/ 200 sacks 8% gal cement. Treat the Point Lockout w/ 10,000 gal sand-free treatment and test. Following this, perforate the Henshaw and Cliffhouse and treat each separately w/ 10,000 gal, test, clean out, run 2-3/8" tubing and complete.



I understand that this plan of work must receive approval in writing by the Geological Survey before operations may be commenced.

Company **Pacific Northwest Pipe Line Corp.**

Address **413-1/2 N. Main**

**Fernington, N. M.**

By **J. H. Muga**

Title **Engineer**

Company PACIFIC NORTHWEST PIPELINE CORPORATION

Lease..... Well No.....

Sec. 22, T. 32 N., R. 7 W., N.M.P.M.

Location 1650' FROM THE NORTH LINE AND 1650' FROM THE EAST LINE.

Elevation 6601.8 UNGRADED GROUND.

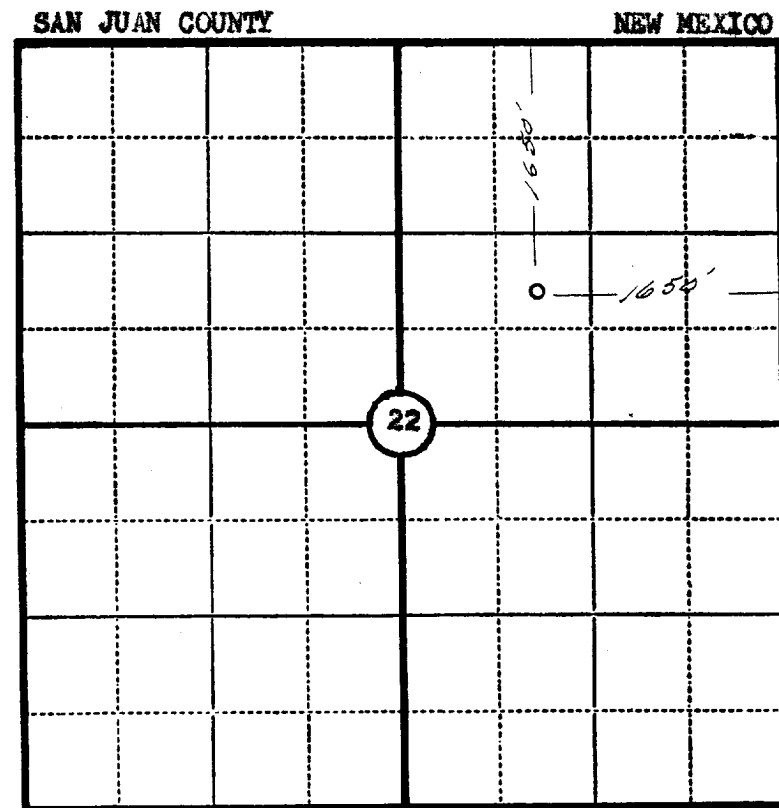

Scale—4 inches equal 1 mile.

This is to certify that the above plat was prepared from field notes of actual surveys made by me or under my supervision and that the same are true and correct to the best of my knowledge and belief.

Seal:

*James P. Lierse*  
Registered [REDACTED]  
[REDACTED] Land Surveyor.

JAMES P. LIERSE  
N. MEX. REG. NO. 1463

Surveyed 15 JUNE, 19 55