

COPY TO O. C. C.

P. O. Box 965
Farmington, New Mexico

December 15, 1955

Pacific Northwest Pipeline Corporation
413 1/2 West Main Street
Farmington, New Mexico

Re: New Mexico 03189

Gentlemen:

Receipt is acknowledged of your "Notice of Intention to Drill" dated December 7, 1955 covering your well No. 4-21 Cox Canyon 32-11 in NE 1/4 NE 1/4 sec. 21, T. 32 N., R. 11 W., N. M. P. M., San Juan County, New Mexico, Blanco Mesa Verde pool.

Your proposed work is hereby approved subject to compliance with the provisions of the "Oil and Gas Operating Regulations" revised May 25, 1942, a copy of which will be sent to you on request, and subject to the following conditions:

1. Drilling operations so authorized are subject to the attached sheet for general conditions of approval.
2. Furnish copies of all logs.

Very truly yours,

(Orig. Sgd.) J. W. Long

Jerry W. Long
Acting District Engineer

JWL:ag

Approved
12/15/55

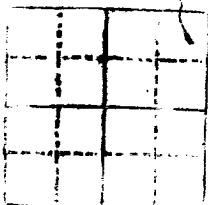

SECRET

U. S. Box 400
Washington, D. C.

December 11, 1955

Enclosed for the Bureau are two copies of the report of the Special Agent in Charge, New York, dated December 10, 1955, and captioned as above.

Very truly yours,

Director

Enclosed for the Bureau are two copies of the report of the Special Agent in Charge, New York, dated December 10, 1955, and captioned as above. The report contains information regarding the activities of the "Black Panther Party" in New York City.

For information of the Bureau, the New York Office is currently conducting an investigation of the activities of the "Black Panther Party" in New York City. The results of this investigation will be reported to the Bureau as soon as they are available.

Very truly yours,

Special Agent in Charge

Very truly yours,

Special Agent in Charge

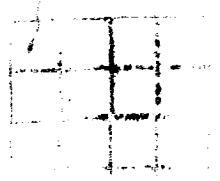
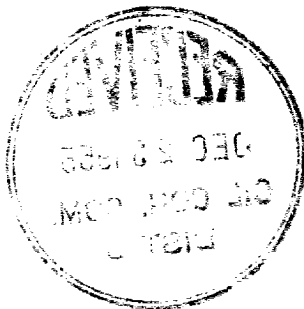

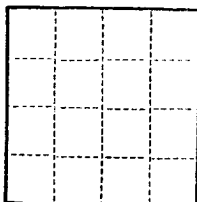

3-2005
1-W. R. Johnson (SUBMIT IN TRIPLICATE)
1-file

UNITED STATES
DEPARTMENT OF THE INTERIOR
GEOLOGICAL SURVEY

Land Office New Mexico
Lease No. 93189
Unit Cox Canyon 32-11

SUNDRY NOTICES AND REPORTS ON WELLS

| | | | |
|--|-------------------------------------|--|--|
| NOTICE OF INTENTION TO DRILL | <input checked="" type="checkbox"/> | SUBSEQUENT REPORT OF WATER SHUT-OFF | |
| NOTICE OF INTENTION TO CHANGE PLANS | | SUBSEQUENT REPORT OF SHOOTING OR ACIDIZING | |
| NOTICE OF INTENTION TO TEST WATER SHUT-OFF | | SUBSEQUENT REPORT OF ALTERING CASING | |
| NOTICE OF INTENTION TO RE-DRILL OR REPAIR WELL | | SUBSEQUENT REPORT OF RE-DRILLING OR REPAIR | |
| NOTICE OF INTENTION TO SHOOT OR ACIDIZE | | SUBSEQUENT REPORT OF ABANDONMENT | |
| NOTICE OF INTENTION TO PULL OR ALTER CASING | | SUPPLEMENTARY WELL HISTORY | |
| NOTICE OF INTENTION TO ABANDON WELL | | | |

(INDICATE ABOVE BY CHECK MARK NATURE OF REPORT, NOTICE, OR OTHER DATA)

December 7, 19 55

Well No. 4-21 is located 990 ft. from N line and 990 ft. from E line of sec. 21

34/4 35/4 32 11
($\frac{1}{4}$ Sec. and Sec. No.) (Twp.) (Range) (Meridian)

Blanco San Juan New Mexico
(Field) (County or Subdivision) (State or Territory)

ungraded ground.

The elevation of the surface or above sea level is 537.4 ft.

DETAILS OF WORK

(State names of and expected depths to objective sands; show sizes, weights, and lengths of proposed casings; indicate mudding jobs, cementing points, and all other important proposed work)

Propose to drill 12" hole to 175' set. 9-5/8" csg. Cemented w/125 cu ft. gel, then drill w/water or minimum mud to 375' and set 7" csg cemented w/150 cu gal and 50 cu ft. mud on bottom. Then drill w/gas to total depth of 5000'. Set 5" casing cemented w/175 cu gal. Perf and sand frac the Ft. Lockout, Mesquite, and Cliff House separately each w/40,000 gal water w/appx. 11 cu gal.

320 acres dedicated to this well. E 1/2 sec. 21

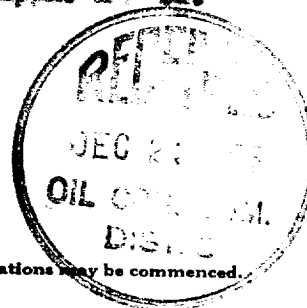

I understand that this plan of work must receive approval in writing by the Geological Survey before operations may be commenced.

Company Pacific Northwest Pipeline Corporation

Address 413 West Main Street

Wilmington, New Mexico

By J. A. Hagan

Title District Engineer

Company PACIFIC NORTHWEST PIPELINE CORPORATION

Lease..... Well No.....

Sec. 21, T. 32 N., R. 11 W., N.M.P.M.

Location 990' FROM THE NORTH LINE AND 990' FROM THE EAST LINE.

Elevation 6537.4 UNGRADED GROUND.

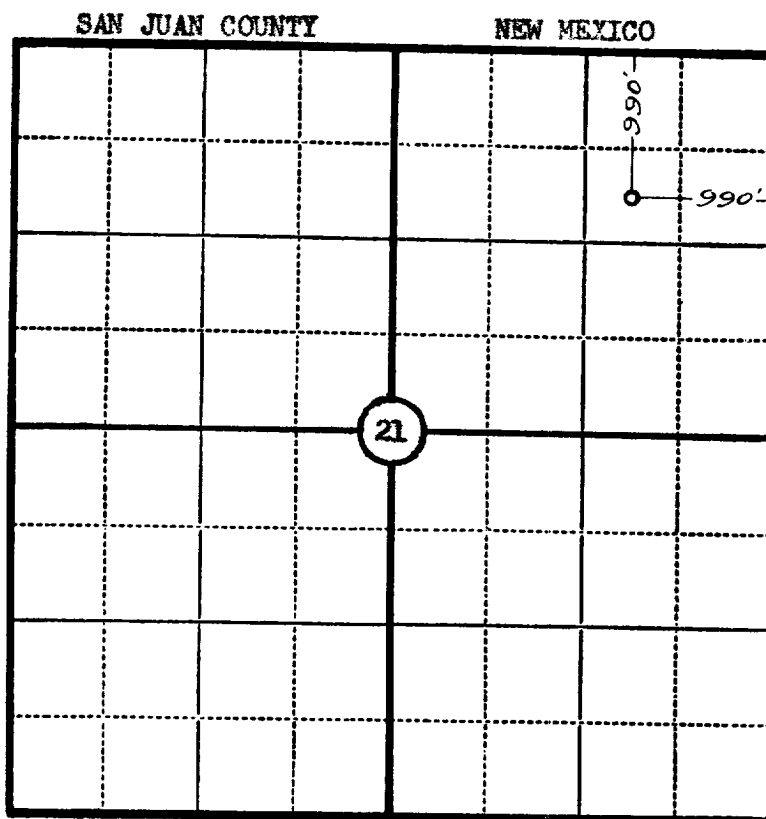

Scale—4 inches equal 1 mile.

This is to certify that the above plat was prepared from field notes of actual surveys made by me or under my supervision and that the same are true and correct to the best of my knowledge and belief.

Seal:

James P. Leese

Registered Land Surveyor.

James P. Leese

N. Mex. Reg. No. 1463

Surveyed 9. August....., 19..55.

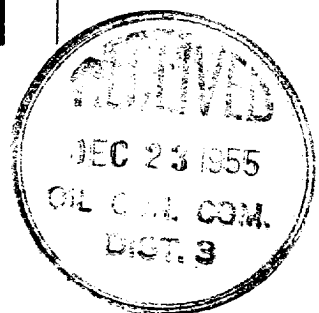

SAN JUAN ENGINEERING COMPANY, FARMINGTON, N. M.