

Form 9-331a
(Feb. 1961)

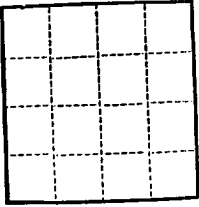

(SUBMIT IN TRIPLICATE)
UNITED STATES
DEPARTMENT OF THE INTERIOR
GEOLOGICAL SURVEY

Land Office Santa Fe
Lease No. 078504
Unit San Juan 32-9 Unit
14-08-001-569

SUNDRY NOTICES AND REPORTS ON WELLS

NOTICE OF INTENTION TO DRILL.....	<input checked="" type="checkbox"/>	SUBSEQUENT REPORT OF WATER SHUT-OFF.....	
NOTICE OF INTENTION TO CHANGE PLANS.....		SUBSEQUENT REPORT OF SHOOTING OR ACIDIZING.....	
NOTICE OF INTENTION TO TEST WATER SHUT-OFF.....		SUBSEQUENT REPORT OF ALTERING CASING.....	
NOTICE OF INTENTION TO RE-DRILL OR REPAIR WELL.....		SUBSEQUENT REPORT OF RE-DRILLING OR REPAIR.....	
NOTICE OF INTENTION TO SHOOT OR ACIDIZE.....		SUBSEQUENT REPORT OF ABANDONMENT.....	
NOTICE OF INTENTION TO PULL OR ALTER CASING.....		SUPPLEMENTARY WELL HISTORY.....	
NOTICE OF INTENTION TO ABANDON WELL.....			

(INDICATE ABOVE BY CHECK MARK NATURE OF REPORT, NOTICE, OR OTHER DATA)

March 16, 1959

Well No. 67 is located 1090 ft. from N line and 1630 ft. from E line of sec. 24

NE Sec. 24 32N 10W N.M.P.M.
($\frac{1}{4}$ Sec. and Sec. No.) (Twp.) (Range) (Meridian)
Blanco San Juan New Mexico
(Field) (County or Subdivision) (State or Territory)

The elevation of the derrick floor above sea level is 6825 ft.

DETAILS OF WORK

(State names of and expected depths to objective sands; show sizes, weights, and lengths of proposed casings; indicate mudding jobs, cementing points, and all other important proposed work)

It is intended to drill a well with rotary tools thru the Mesa Verde formation. Mud circulation will be used thru the Pictured Cliffs and set intermediate casing. Gas circulation will be used thru the Mesa Verde and production liner will be set. Possible productive intervals will be perforated and fractured. Est. T. D. 6150'.

Casing Program:

10 3/4" at 170' with 150 sacks cement circulated to the surface.
7 5/8" at 3660' with 250 sacks cement.
5 1/2" liner at 6150' with 300 sacks cement.

The E/2 of Section 24 is dedicated to this well.

E/2: SF 078504

I understand that this plan of work must receive approval in writing by the Geological Survey before operations may be commenced.

Company El Paso Natural Gas Company

Address Box 997
Farmington, New Mexico

By ORIGINAL SIGNED J.J. TILLERSON
Title Petroleum Engineer

NEW MEXICO OIL CONSERVATION COMMISSION

Well Location and Acreage Dedication Plat

Section A.

Date **MARCH 17, 1959**

Operator **EL PASO NATURAL GAS COMPANY** Lease **SAN JUAN 32-9 UNIT** SF **078504**
 Well No. **67** Unit Letter **B** Section **24** Township **32-N** Range **10-W** N.M.S.
 Located **1090** Feet From **NORTH** Line, **1630** Feet From **EAST** Line
 County **SAN JUAN** G. L. Elevation **6815** Dedication Area **320** Acres
 Name of Producing Formation **MESA VERDE** Pool **BLANCO MESA VERDE**

1. Is the Operator the only owner in the dedicated acreage outlined on this plat below?
 Yes ☒ No ☐
2. If the answer to question one is "no", have the interests of all the owners been consolidated by some written agreement or otherwise? Yes ☐ No ☐ If answer is "Yes", Type of Consolidation:
3. If the answer to question two is "no", list all the owners and their respective interests below:

Owner

Land Description



MAR 23 1959

Section B.

This is to certify that the information in Section A above is true and complete to the best of my knowledge and belief.

El Paso Natural Gas CompanyORIGINAL SIGNED **J.J. TILLERSON**

(Representative)

Box 997

(Address)

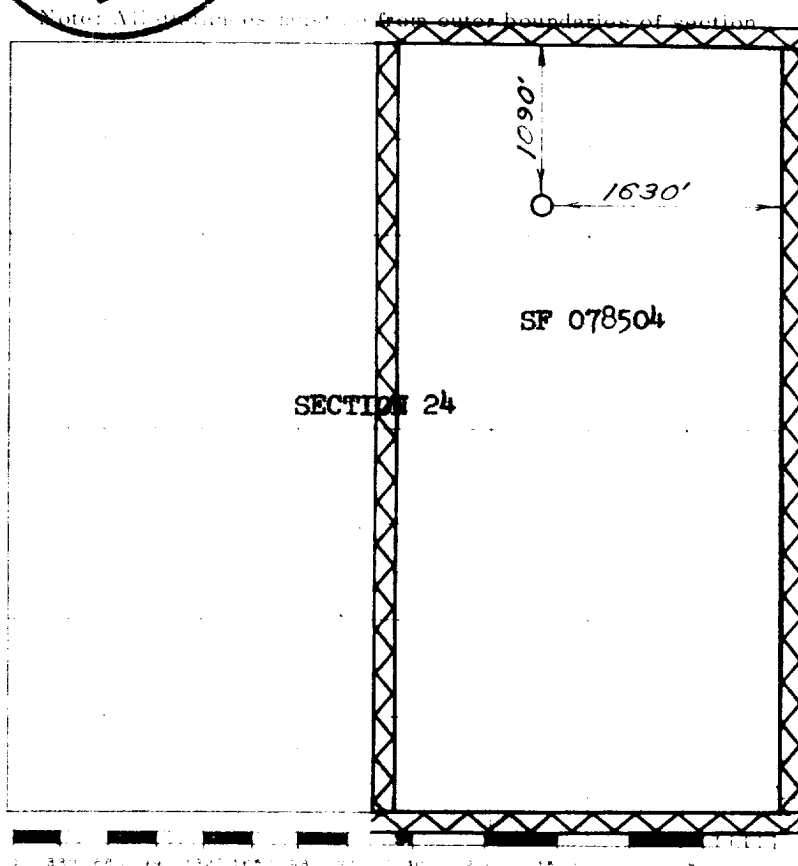
Farmington, New Mexico

Scale 1 inch = equal 1 mile

This is to certify that the above plat was prepared from field notes and records made by me or under my supervision and that the same are true and correct to the best of my knowledge and belief.

(Seal)

Date Surveyed **DECEMBER 4, 1958**

David A. Tillerson
 Registered Professional Engineer and/or Land Surveyor

Farmington, New Mexico

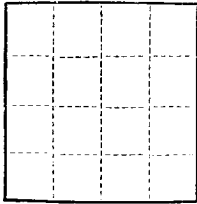

(SUBMIT IN TRIPLICATE)

UNITED STATES
DEPARTMENT OF THE INTERIOR
GEOLOGICAL SURVEY

Land Office **Santa Fe**
Lease No. **078504**
Unit **San Juan 32-9 Unit**
14-08-001-569

SUNDRY NOTICES AND REPORTS ON WELLS

NOTICE OF INTENTION TO DRILL.....	SUBSEQUENT REPORT OF WATER SHUT-OFF.....	X
NOTICE OF INTENTION TO CHANGE PLANS.....	SUBSEQUENT REPORT OF SHOOTING OR ACIDIZING.....	
NOTICE OF INTENTION TO TEST WATER SHUT-OFF.....	SUBSEQUENT REPORT OF ALTERING CASING.....	
NOTICE OF INTENTION TO RE-DRILL OR REPAIR WELL.....	SUBSEQUENT REPORT OF RE-DRILLING OR REPAIR.....	
NOTICE OF INTENTION TO SHOOT OR ACIDIZE.....	SUBSEQUENT REPORT OF ABANDONMENT.....	
NOTICE OF INTENTION TO PULL OR ALTER CASING.....	SUPPLEMENTARY WELL HISTORY.....	
NOTICE OF INTENTION TO ABANDON WELL.....		

(INDICATE ABOVE BY CHECK MARK NATURE OF REPORT, NOTICE, OR OTHER DATA)

April 8, 19**59**

Well No. **67** is located **1090** ft. from **[N]** line and **1630** ft. from **[E]** line of sec. **24**
NE **Sec. 24** **32N** **10W** **N.M. P.M.**
(¼ Sec. and Sec. No.) (Twp.) (Range) (Meridian)
Blanco **San Juan** **New Mexico**
(Field) (County or Subdivision) (State or Territory)

The elevation of the derrick floor above sea level is **6825** ft.

DETAILS OF WORK

(State names of and expected depths to objective sands; show sizes, weights, and lengths of proposed casings; indicate mudding jobs, cementing points, and all other important proposed work)

Spud date **4-3-59**.
On **4-6-59**. Total Depth **175'**.
Ran **4** joints **10 3/4"**, **32.75#**, spiral weld casing (**162'**) set at **172'**
with **110** sacks regular cement, **2% Gel**, **2% CaCl**, **50 cu. ft. Stratacrete**
"6" circulated to surface.
Held **500#** for **30** minutes.



I understand that this plan of work must receive approval in writing by the Geological Survey before operations may be commenced.

Company **El Paso Natural Gas Company**

Address **Box 997**

Farmington, New Mexico

By **Original Signed C. D. COX**

Title **Petroleum Engineer**