

submitted in lieu of Form 3160-5

UNITED STATES  
DEPARTMENT OF THE INTERIOR  
BUREAU OF LAND MANAGEMENT

Sundry Notices and Reports on Wells

1. Type of Well  
GAS

2. Name of Operator  
MERIDIAN OIL

3. Address & Phone No. of Operator  
PO Box 4289, Farmington, NM 87499 (505) 326-9700

4. Location of Well, Footage, Sec., T, R, M  
1090'FNL, 1630'FEL Sec.24, T-32-N, R-10-W, NMPM

5. Lease Number  
SF-078504

6. If Indian, All. or  
Tribe Name

7. Unit Agreement Name

San Juan 32-9 Unit  
8. Well Name & Number  
San Juan 32-9 U 67

9. API Well No.  
30-045-11376

10. Field and Pool *Blanco*  
Unders. Pic.Cliffs/  
Blanco Mesa Verde

11. County and State  
San Juan Co, NM

12. CHECK APPROPRIATE BOX TO INDICATE NATURE OF NOTICE, REPORT, OTHER DATA

Type of Submission

☒ Notice of Intent  
☐ Subsequent Report  
☐ Final Abandonment

Type of Action

☐ Abandonment ☐ Change of Plans  
☒ Recompletion ☐ New Construction  
☐ Plugging Back ☐ Non-Routine Fracturing  
☐ Casing Repair ☐ Water Shut off  
☐ Altering Casing ☐ Conversion to Injectio  
☒ Other - temporarily abandon MV

13. Describe Proposed or Completed Operations

It is intended to temporarily abandon the Mesa Verde formation, and recomple in the Pictured Cliffs per the attached procedure and wellbore diagram.

RECEIVED  
APR 18 1994  
OIL CON. DIV.  
DIST. 3

070 PM  
94 APR -5 PM 3:41

RECEIVED  
BLM  
04/20/94

14. I hereby certify that the foregoing is true and correct.

Signed *[Signature]* (JK) Title Regulatory Affairs Date 4/6/94

(This space for Federal or State Office use)  
APPROVED BY \_\_\_\_\_ Title \_\_\_\_\_  
CONDITION OF APPROVAL, if any:

APPROVED  
Date

APR 12 1994

*[Signature]*  
DISTRICT MANAGER

NMOC

THE UNIVERSITY OF CHICAGO  
LIBRARY

1000 S. MICHIGAN AVE.  
CHICAGO, ILL. 60607

3 0000000000000000

3

**N MEXICO OIL CONSERVATION COMMISSION  
WELL LOCATION AND ACREAGE DEDICATION PLAT**

Form C-122  
Supersedes C-122  
Effective 1-4-65

All distances must be from the outer boundaries of the Section.

Operator <b>Meridian Oil Inc.</b>			Lease <b>SAN JUAN 32-9 UNIT</b>		Well No. <b>67</b>
Unit Letter <b>B</b>	Section <b>24</b>	Township <b>32-N</b>	Range <b>10-W</b>	County <b>SAN JUAN</b>	
Actual Footage Location of Well: <div style="display: flex; justify-content: space-between;"> <span><b>1090</b> feet from the <b>NORTH</b> line and</span> <span><b>1630</b> feet from the <b>EAST</b> line</span> </div>					
Ground Level Elev. <b>6815</b>	Producing Formation <b>Pictured Cliffs/Mesa Verde</b>		Pool <b>Undesignated/Blanco</b>		Dedicated Acreage: <b>150.46</b> <b>301.02 / 160 Acres</b>

1. Outline the acreage dedicated to the subject well by colored pencil or hachure marks on the plat below.
2. If more than one lease is dedicated to the well, outline each and identify the ownership thereof (both working interest and royalty).
3. If more than one lease of different ownership is dedicated to the well, have the interests of all owners been consolidated by communitization, unitization, force-pooling, etc?

☒ Yes    ☐ No    If answer is "yes," type of consolidation unitization

If answer is "no," list the owners and tract descriptions which have actually been consolidated. (Use reverse side of this form if necessary.)

No allowable will be assigned to the well until all interests have been consolidated (by communitization, unitization, forced-pooling, or otherwise) or until a non-standard unit, eliminating such interests, has been approved by the Commission. **NOTE: CORRECTED ACREAGE PER DEPENDENT RESURVEY.**

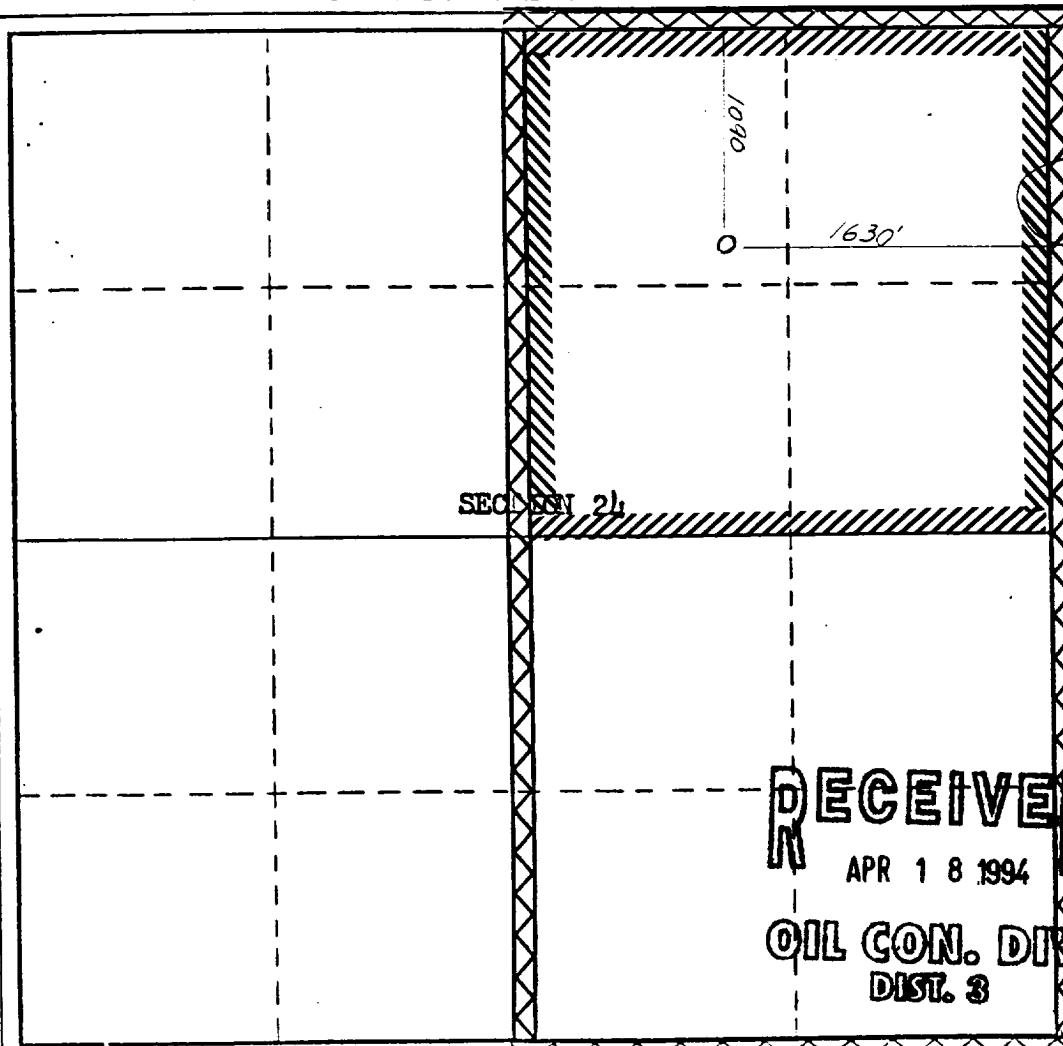

**CERTIFICATION**

I hereby certify that the information contained herein is true and complete to the best of my knowledge and belief.

*Peggy Bradfield*  
 (Name)  
 Peggy Bradfield  
 Position  
 Regulatory Representative  
 Company  
 Meridian Oil Inc.  
 Date 4-6-94

I hereby certify that the well location shown on this plat was plotted from field notes of actual surveys made by me or under my supervision, and that the same is true and correct to the best of my knowledge and belief.

**RECEIVED**  
**APR 18 1994**  
**OIL CON. DIV.**  
**DIST. 3**

Date Surveyed 1958  
 Registered Professional Engineer and/or Land Surveyor

Certificate No.

0 330 660 990 1320 1650 1980 2310 2540 2000 1500 1000 500 0

RECEIVED  
JAN 10 1961

1961 JAN 10 1961  
1961

**Pertinent Data Sheet - San Juan 32-9 Unit #67**

**Location:** 1090' FNL, 1630' FEL, Section 24, T-32-N R-10-W, San Juan County, NM

**Field:** Blanco Mesaverde

**Elevation:** 6815' GR  
6025' DF

**TD:** 6172'  
6058'

**Spud Date:** 4/3/59

**DP Number:** 23423A

**Casing Record:**

<u>Hole Size</u>	<u>Casing Size</u>	<u>Weight &amp; Grade</u>	<u>Depth Set</u>	<u>Cement</u>	<u>Top/Cement</u>
13"	10-3/4"	32.75#	172'	160 sx	Surface
9-5/8"	7-5/8"	26.4# J-55	3888'	188 sx	3135' (TS)
	5-1/2" liner	15.5# J-55	3486'-6168'	386 sx	Sq top w/100 sx

**Tubing Record:**

<u>Tubing Size</u>	<u>Weight &amp; Grade</u>	<u>Depth Set</u>
2"	EUE 4.7# J-55	6034'

**Formation Tops:**

Fruitland	3207'
Pictured Cliffs	3612'
Lewis	3775'
Cliff House	5567'
Menefee	5812'
Point Lookout	5925'

**Logging Record:** Temperature Survey, ES, GRN, IND, ML

**Stimulation:** 5804'-14', 5878'-92', 5928'-40', 5956'-66', 5982'-92', 6002'-16', 6038'-44'  
Frac #1 (all perms) 47,000 gal water, 52,000# sand, 39 BPM  
Frac #2 (5804'-5992') 62,280 gal water, 65,000# sand, 85 BPM, over flushed

# SAN JUAN 32-9 UNIT #67

CURRENT

BLANCO MESAVERDE

UNIT B, SEC 24, T32N, R10W, SAN JUAN COUNTY, NM

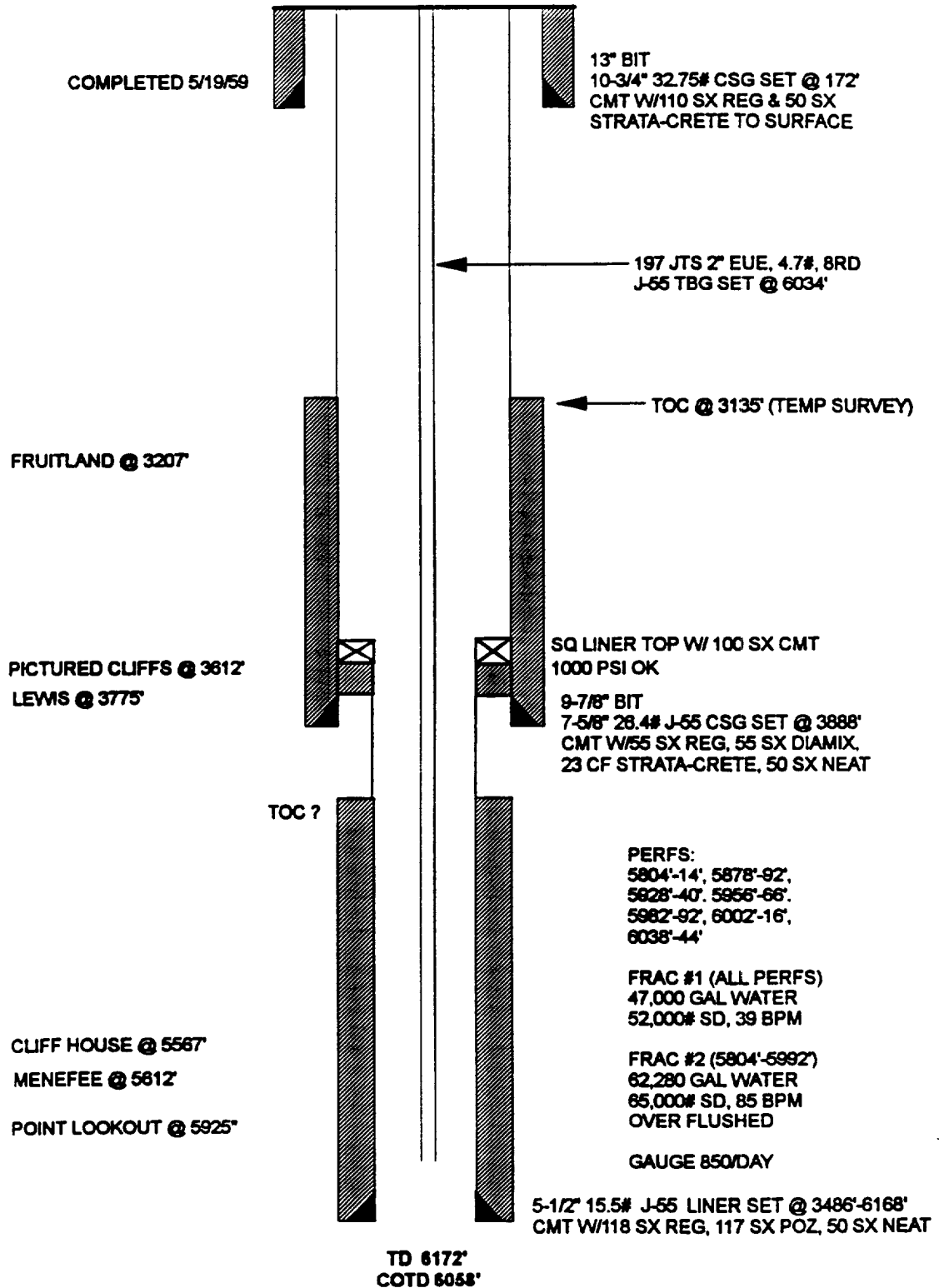

**San Juan 32-9 Unit #67**  
**Mesaverde T&A**  
**Pictured Cliffs Recompletion**  
**NE/4 Section 24, T32N-R10W**

1. MIRU. Hole safety meeting. Place fire and safety equipment in strategic locations. Comply with all MOI, NMOCD and BLM rules and regulations.
2. Kill well with water if necessary. ND WH, NU BOP's. TOOH with 197 joints 2-3/8" 4.7# EUE 8rd J-55 tbg (6024' of tbg. set @ 6034'). Visually inspect tubing and replace bad joints as needed.
3. PU 7-5/8" casing scraper and TIH. Make scraper run to liner top @ 3486'. TOOH and LD casing scraper. PU 5-1/2" casing scraper. Make scraper run to 3900'. TOOH. Laydown casing scraper.
3. PU CIBP and TIH. Set 5-1/2" CIBP at 3800'. Load hole with water and pressure test casing. TOOH.
4. Run CBL-CCL-GR from PBTD' to surface. RD wireline.
5. If pressure test failed in step 3, PU 7-5/8" packer and TIH. Locate failure and report to engineering. In addition to repairing any casing failures, an attempt will be made to bring cement up the backside of the 7-5/8" casing. Also, the liner top will need to be squeezed if cement coverage below the liner top is not adequate to isolate the Pictured Cliffs. Engineering will supply squeeze procedures after receiving CBL.
6. When squeeze cementing is completed, CO to CIBP @ 3800'. Unload hole with air. Spot filtered 2% KCl water from PBTD to 2500'. TOOH.
7. Contact engineering and geology 2 hours before proceeding with next step. RU wireline. Run TDT-GR from PBTD to 2900'. Provide engineering with copy of TDT immediately.
8. Perforate Pictured Cliffs formation. Engineering will supply perforation information after reviewing TDT log.
9. PU 3-1/2" frac string and packer. TIH to 3300' and set packer. Breakdown perforations with acid and balls. Nitrogen foam stimulate Pictured Cliffs. Detailed procedure and maximum allowable pressures will be provided by engineering after reviewing TDT log.
10. Flow well naturally as long as possible. When sand and fluid returns have diminished, release packer and TOOH. LD frac string and packer.
11. TIH with tubing and clean up well with air. When fluid and sand returns have diminished, SI well. RIH with pressure bomb to 3600'. SI well for 12 hours. TOOH with pressure bomb.
12. Land tubing at mid-perf. ND BOP's, NU WH. Obtain final gauge. RDMO.

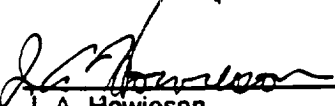
  
J. A. Howieson

**Vendors:**

Perforating: Petro Wireline (326-6669)  
Stimulation: Western Co. of NA (327-6222)