

NEW MEXICO OIL CONSERVATION COMMISSION  
Santa Fe, New Mexico

NOTICE OF INTENTION TO DRILL OR RECOMPLETE

Notice must be given to the District Office of the Oil Conservation Commission and approval obtained before drilling or recomplection begins. If changes in the proposed plan are considered advisable, a copy of this notice showing such changes will be returned to the sender. Submit this notice in **QUINTUPLICATE**. One copy will be returned following approval. See additional instructions in Rules and Regulations of the Commission. **If State Land submit 6 Copies**

**Farmington, New Mexico**  
(Place)

**August 9, 1956**  
(Date)

OIL CONSERVATION COMMISSION  
SANTA FE, NEW MEXICO

Gentlemen:

You are hereby notified that it is our intention to commence the (Drilling) ~~(Recompletion)~~ of a well to be known as

**El Paso Natural Gas Company**  
(Company or Operator)

**R.P.N.G. State**  
(Lease)

Well No. **4**

in **N** (Unit)

The well is

located **843** feet from the **South** line and **1516** feet from the

**West**

line of Section **16**, T. **32N**, R. **10W**, NMPM.

(GIVE LOCATION FROM SECTION LINE)

**Blanco** Pool,

**San Juan** County

County

If State Land the Oil and Gas Lease is No. **B-11127-1**

If patented land the owner is

Address

We propose to drill well with drilling equipment as follows: **Rotary tools, using gas circulation to drill from the Lewis thru the Mesa Verde form.**

The status of plugging bond is **Statewide**

Drilling Contractor **Garrell Drilling Company**

We intend to complete this well in the **Mesa Verde** formation at an approximate depth of **5637** feet.



D	C	B	A
E	F	G	H
L	K	J	I
M	X <sub>N</sub>	O	P

Elev 6431 GR, 6441 DF

**CASING PROGRAM**

We propose to use the following strings of Casing and to cement them as indicated:

Size of Hole	Size of Casing	Weight per Foot	New or Second Hand	Depth	Sacks Cement
<b>15"</b>	<b>10 3/4"</b>	<b>32.75</b>	<b>New</b>	<b>170'</b>	<b>125</b>
<b>9 5/8"</b>	<b>7 5/8"</b>	<b>26.4</b>	<b>New</b>	<b>3509'</b>	<b>250</b>
<b>6 3/4"</b>	<b>5 1/2"</b>	<b>15.5</b>	<b>New</b>	<b>5637'</b>	<b>150</b>

If changes in the above plans become advisable we will notify you immediately.

ADDITIONAL INFORMATION (If recomplection give full details of proposed plan of work.) **Possible productive zones in the Mesa Verde will be perforated and fractured.**

- B-11318-26 (NE SW)**
- E-3150-1 (NW NW, NW SW)**
- W/2 E-286-22 (SW SW)**
- B-11127-1 (S/2 NW, SE SW)**
- E-1056 (NE NW)**

**The W/2 of Section 16 is dedicated to this well.**

Approved  
Except as follows:

*F-10*, 19 *56*

Sincerely yours,

**El Paso Natural Gas Company**  
(Company or Operator)

By

*Garrell Drilling Company*

Position **Petroleum Engineer**

Send Communications regarding well to

Name **H. J. Cool**

Address **Box 987, Farmington, New Mexico**

OIL CONSERVATION COMMISSION

By *Ernest C. Arnold*

WELL LOCATION AND/OR GAS PRODUCTION PLAT

AUGUST 6, 1956

OWNER EL PASO NATURAL GAS COMPANY STATE EPNG-STATE PLAT B-11127-1

WELL NO. 4 SECTION 16 TOWNSHIP 32 N RANGE 10 W N.M.P.M.

WELL NO. 843 DEPTH FROM SOUTH LINE 1516 DEPTH FROM WEST LINE

SAN JUAN COUNTY BLANCO DISTRICT 6431

NAME OF LAND INTEREST MESA VERDE ACRES 320 AC.

(1800 PLAT)

Note: All distances must be from outer to an inner of section.

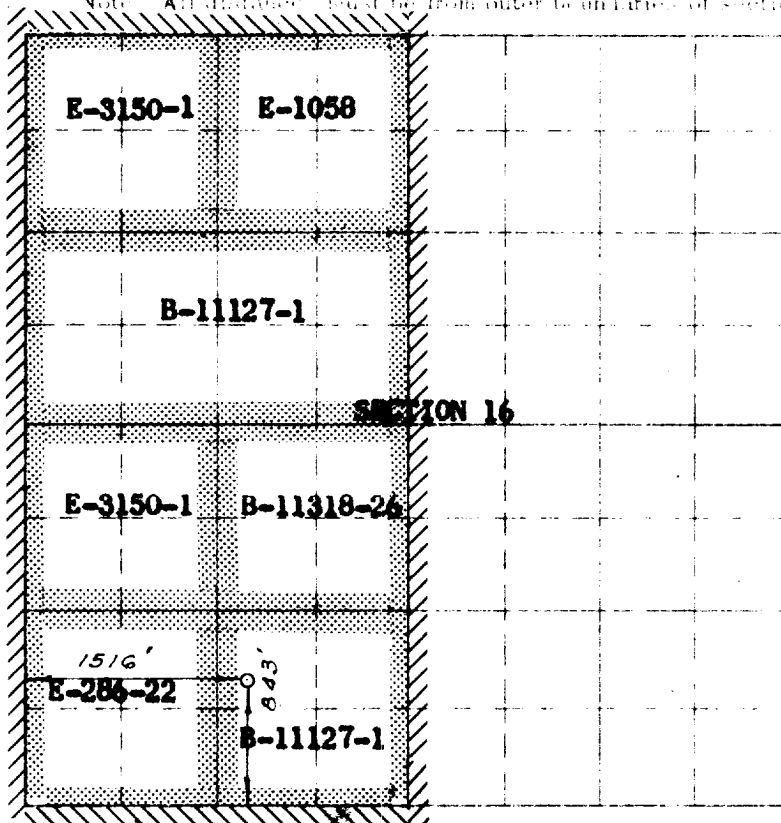

Scale: 1 inch equals 1 mile



NOTE

This section of form is to be used for gas wells only

This is to certify that the above plat was prepared from field notes of actual surveys made by me or under my supervision and that the same are true and correct to the best of my knowledge and belief.

Date Surveyed FEBRUARY 21, 1956

W. O. Walker  
Registered Professional Engineer and/or Land Surveyor

1. Is this well a Dual Comp. Yes  No

2. If the answer to Question 1 is yes, are there any other dually completed wells within the dedicated acreage. Yes  No

Name W. O. Walker

Position Petroleum Engineer

Representing El Paso Natural Gas Co.

Address Box 997, Farmington, N.M.

(Seal)

OIL CONSERVATION COMMISSION

AZTEC DISTRICT OFFICE

No. Copies Received 6

DISTRIBUTION

	NO. FURNISHED	
Operator	1	
Santa Fe	1	
Proration Office		
State Land Office	1	
U. S. G. S.	2	
Transporter		
File	1	<input checked="" type="checkbox"/>