

(SUBMIT IN TRIPLICATE)

UNITED STATES
DEPARTMENT OF THE INTERIOR
GEOLOGICAL SURVEY

Land Office State Pa

Lease No. 070513

Unit San Juan X-2 Unit
14-00-001-569

SUNDRY NOTICES AND REPORTS ON WELLS

NOTICE OF INTENTION TO DRILL.....	<input checked="" type="checkbox"/>	SUBSEQUENT REPORT OF WATER SHUT-OFF.....	
NOTICE OF INTENTION TO CHANGE PLANS.....		SUBSEQUENT REPORT OF SHOOTING OR ACIDIZING.....	
NOTICE OF INTENTION TO TEST WATER SHUT-OFF.....		SUBSEQUENT REPORT OF ALTERING CASING.....	
NOTICE OF INTENTION TO RE-DRILL OR REPAIR WELL.....		SUBSEQUENT REPORT OF RE-DRILLING OR REPAIR.....	
NOTICE OF INTENTION TO SHOOT OR ACIDIZE.....		SUBSEQUENT REPORT OF ABANDONMENT.....	
NOTICE OF INTENTION TO PULL OR ALTER CASING.....		SUPPLEMENTARY WELL HISTORY.....	
NOTICE OF INTENTION TO ABANDON WELL.....			

(INDICATE ABOVE BY CHECK MARK NATURE OF REPORT, NOTICE, OR OTHER DATA)

June 13, 1960

Well No. 70 is located 990 ft. from S line and 990 ft. from W line of sec. 17

SW/4 Sec. 17 (1/4 Sec. and Sec. No.) 32N (Twp.) 9E (Range) N.M.P.M. (Meridian)

Blanco N. V. (Field) San Juan (County or Subdivision) New Mexico (State or Territory)

The elevation of the derrick floor above sea level is 6035 ft.

DETAILS OF WORK

(State names of and expected depths to objective sands; show sizes, weights, and lengths of proposed casings; indicate mudding jobs, cementing points, and all other important proposed work)

It is intended to drill a well with rotary tools thru the Mesa Verde formation. Mud circulation will be used thru the Pictured Cliffs and set intermediate casing. Gas circulation will be used thru the Mesa Verde and production liner will be set. Possible productive intervals will be perforated and fractured. Est. T. D. 6030'.

Casing Program:

- 10 3/4" at 170' with 150 sacks cement circulated to the surface.
- 7 1/2" at 300' with 250 sacks cement.
- 5 1/2" liner at 6030' with 300 sacks cement.

The 1/2 of Section 17 is dedicated to this well.
1/2: SF 070513

I understand that this plan of work must receive approval in writing by the Geological Survey before operation.

Company San Juan Natural Gas Company

Address Box 990

Farmington, New Mexico

By ORIGINAL SIGNED B.H. MEANS

Title Petroleum Engineer

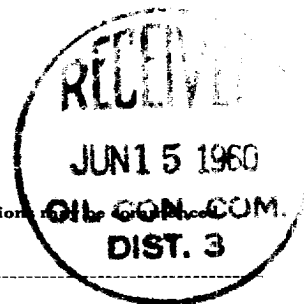

NEW MEXICO OIL CONSERVATION COMMISSION

Well Location and Acreage Dedication Plat

Section A.

Date **JUNE 7, 1960**

Operator **EL PASO NATURAL GAS COMPANY** Lease **SAN JUAN 32-9 UNIT** SF **078513**
 Well No. **78** Unit Letter **M** Section **17** Township **32-N** Range **9-W** N 1/4 PM
 Located **990** Feet From **SOUTH** Line, **990** Feet From **WEST** Line
 County **SAN JUAN** G. L. Elevation **6623** Dedicated Acreage **320 41/317.44/acs**
 Name of Producing Formation **MESA VERDE** Pool **BLANCO MESA VERDE**

1. Is the Operator the only owner in the dedicated acreage outlined on the plat below?
 Yes **A** No
2. If the answer to question one is "no", have the interests of all the owners been consolidated by community agreement or otherwise? Yes No If answer is "yes", Type of Consolidation.
3. If the answer to question two is "no", list all the owners and their respective interests below:

Owner

Land Description

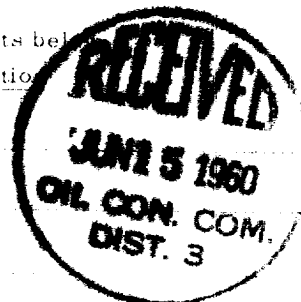

Section B.

Note: All distances must be from outer boundaries of section.

This is to certify that the information in Section A above is true and complete to the best of my knowledge and belief.

El Paso Natural Gas Company

(Operator)

ORIGINAL SIGNED B.H. MEANS

(Representative)

Box 990

(Address)

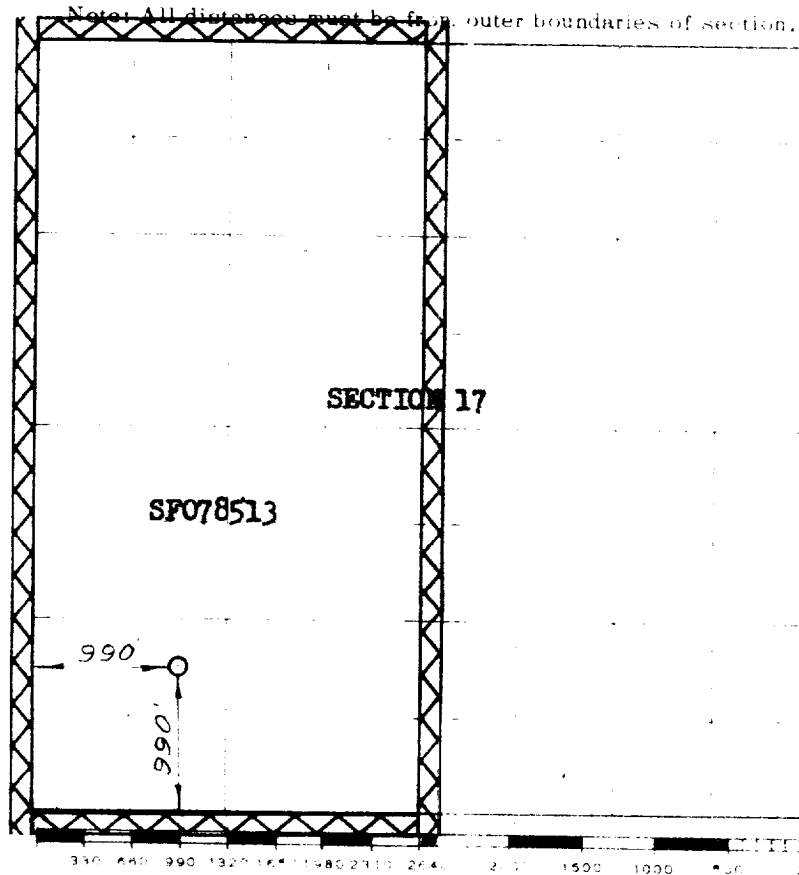
Farmington, New Mexico

Scale 1 inch equals 1 mile

This is to certify that the above plat was prepared from field notes of actual surveys made by me or under my supervision and that the same are true and correct to the best of my knowledge and belief.

(Seal)

Farmington, New Mexico

Date Surveyed **MAY 26, 1960**

David O. Kilmer
 Registered Professional Surveyor and/or Land Surveyor