

(SUBMIT IN TRIPLICATE)

Land Office Santa Fe

Lease No. SF 078118

Unit _____

UNITED STATES
DEPARTMENT OF THE INTERIOR
GEOLOGICAL SURVEY

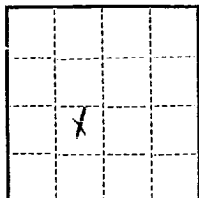

SUNDRY NOTICES AND REPORTS ON WELLS

NOTICE OF INTENTION TO DRILL	<input checked="" type="checkbox"/>	SUBSEQUENT REPORT OF WATER SHUT-OFF	
NOTICE OF INTENTION TO CHANGE PLANS		SUBSEQUENT REPORT OF SHOOTING OR ACIDIZING	
NOTICE OF INTENTION TO TEST WATER SHUT-OFF		SUBSEQUENT REPORT OF ALTERING CASING	
NOTICE OF INTENTION TO RE-DRILL OR REPAIR WELL		SUBSEQUENT REPORT OF RE-DRILLING OR REPAIR	
NOTICE OF INTENTION TO SHOOT OR ACIDIZE		SUBSEQUENT REPORT OF ABANDONMENT	
NOTICE OF INTENTION TO PULL OR ALTER CASING		SUPPLEMENTARY WELL HISTORY	
NOTICE OF INTENTION TO ABANDON WELL			

(INDICATE ABOVE BY CHECK MARK NATURE OF REPORT, NOTICE, OR OTHER DATA)

September 8, 1953

Johns Federal

Well No. #2 is located 1650' ft. from S line and 1650' ft. from W line of sec. 18

SW 1/4 Section 18 32N 11W N.M.P.M.
(1/4 Sec. and Sec. No.) (Twp.) (Range) (Meridian)

Blanco San Juan New Mexico
(Field) (County or Subdivision) (State or Territory)

The elevation of the ~~drilling~~ drilling above sea level is 6596.0 ft.

DETAILS OF WORK

(State names of and expected depths to objective sands; show sizes, weights, and lengths of proposed casings; indicate mudding jobs, cementing points, and all other important proposed work)

It is proposed to drill with rotary mud to the top of the Mesa Verde formation, estimated to be at a depth of 500 + feet, and thereafter to drill with gas through the Mesa Verde formation or the top of the Mancos shale. Final TD estimated to be 5600 + feet. It is further proposed to shoot the entire Mesa Verde section with solid nitroglycerine. Tentative casing program is as follows:

10-3/4" surface casing 190' - 250' circulate cement to surface
7" casing 5000 + Cement w/200 - 300 sacks

The S $\frac{1}{2}$ of Section 18-32N-11W is the designated drilling unit. Blanket drilling bond approved December 8, 1952 (refer to SF-178215-B)

I understand that this plan of work must receive approval in writing by the Geological Survey before operations may be commenced.

Company PUBCO DEVELOPMENT, INC.

Address P.O. Box 1360

Albuquerque, New Mexico

By Frank D. Gorham, Jr.

Title Vice President

Company PUBCO DEVELOPMENT INC.

Lease Pubco Johns Federal Well No. 2

Sec. 18, T. 32 N, R. 11 W. N.M.P.M.

Location 1650' from the South line and 1650' from
the West line.

Elevation: 6596.0 Ungraded ground.

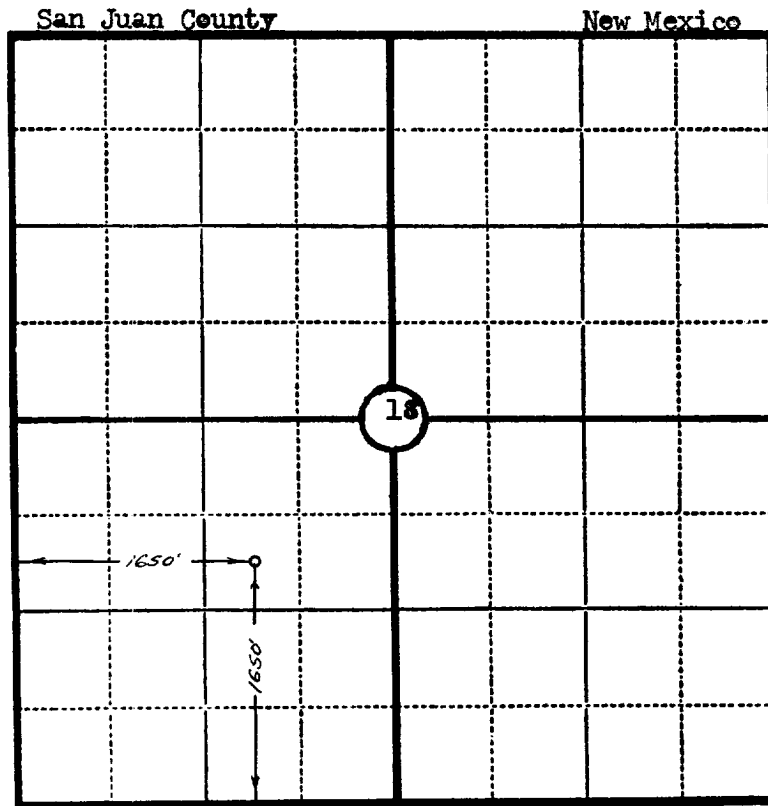

Scale—4 inches equal 1 mile.

This is to certify that the above plat was prepared from field notes of actual surveys made by me or under my supervision and that the same are true and correct to the best of my knowledge and belief.

Seal:

James P. Leese

Registered Professional
Engineer and Land Surveyor.

James P. Leese

N. Mex. Reg. No. 1463

Surveyed 5 September, 1953



RECEIVED
SEP 8 1953
PUBCO DEVELOPMENT, INC.