

Form 9-3312
(Feb. 1961)

(SUBMIT IN TRIPLICATE)

UNITED STATES
DEPARTMENT OF THE INTERIOR
GEOLOGICAL SURVEY

Land Office Santa Fe
Lease No. 070913
Unit San Juan 12-2 Unit
14-01-001-909

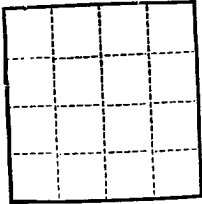

SUNDRY NOTICES AND REPORTS ON WELLS

NOTICE OF INTENTION TO DRILL		SUBSEQUENT REPORT OF WATER SHUT-OFF	
NOTICE OF INTENTION TO CHANGE PLANS		SUBSEQUENT REPORT OF SHOOTING OR ACIDIZING	
NOTICE OF INTENTION TO TEST WATER SHUT-OFF		SUBSEQUENT REPORT OF ALTERING CASING	
NOTICE OF INTENTION TO RE-DRILL OR REPAIR WELL		SUBSEQUENT REPORT OF RE-DRILLING OR REPAIR	
NOTICE OF INTENTION TO SHOOT OR ACIDIZE		SUBSEQUENT REPORT OF ABANDONMENT	
NOTICE OF INTENTION TO PULL OR ALTER CASING		SUPPLEMENTARY WELL HISTORY	
NOTICE OF INTENTION TO ABANDON WELL			

(INDICATE ABOVE BY CHECK MARK NATURE OF REPORT, NOTICE, OR OTHER DATA)

Well No. 15 is located 1000 ft. from N line and 1000 ft. from E line of sec. 15
W
1/4 Sec. 15 32N 4W N.M.P.M.
(1/4 Sec. and Sec. No.) (Twp.) (Range) (Meridian)
Blanco Mesa Verde San Juan New Mexico
(Field) (County or Subdivision) (State or Territory)



The elevation of the derrick floor above sea level is 6117 ft.

DETAILS OF WORK

(State names of and expected depths to objective sands; show sizes, weights, and lengths of proposed casings; indicate mudding jobs, cementing points, and all other important proposed work)

It is intended to drill a well with rotary tools thru the Mesa Verde formation. Mud circulation will be used thru the fractured cliffs and set intermediate casing. Gas circulation will be used thru the Mesa Verde and production liner will be set. Possible productive intervals will be perforated and fractured. Est. T. D. 6160'.

Casing Program:

- 10 3/4" at 170' with 150 sacks cement circulated to the surface.
- 7 5/8" at 3050' with 250 sacks cement.
- 2 1/2" liner at 6160' with 300 sacks cement.

The W/2 of Section 15 is dedicated to this well. W/2: SF 070913

I understand that this plan of work must receive approval in writing by the Geological Survey before operations may be commenced.

Company El Paso Natural Gas Company

Address Box 577

Arrington, New Mexico

By Original Signed F. H. WOOD

Title Petroleum Engineer

NEW MEXICO OIL CONSERVATION COMMISSION

Well Location and Acreage Dedication Plat

Section A.

Date **MAY 10, 1960**

Operator **EL PASO NATURAL GAS COMPANY** Lease **SAN JUAN 32-9 UNIT** SF **078513**
 Well No. **75** Unit Letter **K** Section **18** Township **32-N** Range **9-W** N. 1/4 PM
 Located **1610** Feet From **SOUTH** Line **890** Feet From **WEST** Line
 County **SAN JUAN** G. L. Elevation **6807** Dedicated Acreage **207.92** Acres
 Name of Producing Formation **MESA VERDE** Pool **BLANCO MESA VERDE**

1. Is the Operator the only owner in the dedicated acreage outlined on the plat below?
 Yes ☒ No ☐
2. If the answer to question one is "no", have the interests of all the owners been consolidated by communitization agreement or otherwise? Yes ☐ No ☐ If answer is "yes", Type of Consolidation:

3. If the answer to question two is "no", list all the owners and their respective interests below:

Owner

Land Description

Section B.

Note: All distances must be from ☐ corner ☐ center of section.

This is to certify that the information
 in Section A above is true and complete
 to the best of my knowledge and belief.

El Paso Natural Gas CompanyOriginal (Operator)
Signed **F. H. WOOD**

(Representative)

Box 997

(Address)

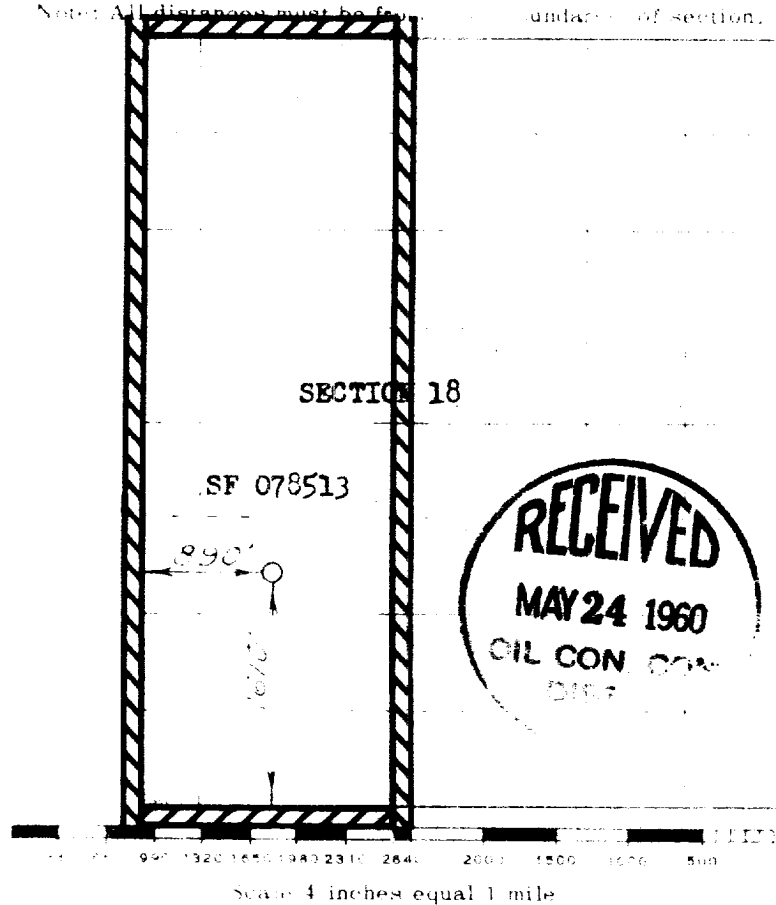
Farmington, New Mexico

This is to certify that the above plat was prepared from field notes of actual surveys made by me or under my supervision and that the same are true and correct to the best of my knowledge and belief.

(Seal)

Date Surveyed **APRIL 14, 1960**

Frank O. Kilburn
 Registered Professional Engineer and/or Land Surveyor

Farmington, New Mexico