

(SUBMIT IN TRIPLICATE)

UNITED STATES  
DEPARTMENT OF THE INTERIOR  
GEOLOGICAL SURVEY

Lead Office Santa Fe  
Lease No. 078459-3  
Unit Allison

SUNDRY NOTICES AND REPORTS ON WELLS

NOTICE OF INTENTION TO DRILL	<input checked="" type="checkbox"/>	SUBSEQUENT REPORT OF WATER SHUT-OFF	
NOTICE OF INTENTION TO CHANGE PLANS		SUBSEQUENT REPORT OF SHOOTING OR ACIDIZING	
NOTICE OF INTENTION TO TEST WATER SHUT-OFF		SUBSEQUENT REPORT OF ALTERING CASING	
NOTICE OF INTENTION TO RE-DRILL OR REPAIR WELL		SUBSEQUENT REPORT OF RE-DRILLING OR REPAIR	
NOTICE OF INTENTION TO SHOOT OR ACIDIZE		SUBSEQUENT REPORT OF ABANDONMENT	
NOTICE OF INTENTION TO PULL OR ALTER CASING		SUPPLEMENTARY WELL HISTORY	
NOTICE OF INTENTION TO ABANDON WELL			

(INDICATE ABOVE BY CHECK MARK NATURE OF REPORT, NOTICE, OR OTHER DATA)

June 7, 1957

Well No. 12057 is located 1825 ft. from N line and 1550 ft. from E line of sec. 14

NE Sec. 14  
( $\frac{1}{4}$  Sec. and Sec. No.)

32N  
(Twp.)

7W  
(Range)

N.M.P.M.  
(Meridian)

El Paso Natural Gas & Blanco N.V.  
(Field)

San Juan  
(County or Subdivision)

New Mexico  
(State or Territory)

The elevation of the derrick floor above sea level is 6657 ft.

DETAILS OF WORK

(State names of and expected depths to objective sands; show sizes, weights, and lengths of proposed casings; indicate mudding jobs, cementing points, and all other important proposed work)

It is intended to drill & dual complete a well in the Dakota formation & Mesa Verde formation. Mud circulation will be used thru the Pictured Cliffs formation and set intermediate casing. Gas circulation will be used thru the Dakota & production casing will be set. Possible productive intervals will be perforated and fractured. Estimated Total Depth 8395'.

Casing Program:

13-3/8" at 170' with 350 sacks cement circulated to surface.

9-5/8" at 3700' with 1000 sacks cement in 2 stages.

5-1/2" at 8395' with 300 sacks, Foxmix "140" in sling 2 stages.

The E/8 of Section 14 is dedicated to the Mesa Verde.

All of Section 14 is dedicated to the Dakota.

SP 078459-A (E/2NE/4), SP 078459-B (S/2; SW/4NE/4; SW/4SE/4), Fee-H.H. Mackey et al ux (E/2NE; SE/4NE/4)

I understand that this plan of work must receive approval in writing by the Geological Survey before operations may be commenced.

Company El Paso Natural Gas Company

Address Box 997

Farmington, New Mexico

By

*OC Johnston*

Title

Petroleum Engineer



Well Location and Acreage Dedication Plat

Section A.

Date JUNE 6, 1957

Operator EL PASO NATURAL GAS COMPANY Lease ALLISON UNIT SF 078459-B  
 Well No. 12-MD Unit Letter G Section 14 Township 32 N Range 7 W NMPM  
 Located 1825 Feet From NORTH Line, 1550 Feet From EAST Line  
 County SAN JUAN G.L. Elevation 6647 Dedicated Acreage 320 Acres  
 Name of Producing Formation MESA VERDE-LARREA Pool NORTH LOS PINOS-INDIO-BLANCO MV

1. Is the Operator the only owner in the dedicated acreage outlined on the plat below?  
 Yes ☒ No ☐
2. If the answer to question one is "no", have the interests of all the owners been consolidated by communitization agreement or otherwise? Yes ☐ No ☐ If answer is "yes," Type of Consolidation \_\_\_\_\_
3. If the answer to question two is "no," list all the owners and their respective interests below

OwnerLand Description

Section B

This is to certify that the information in Section A above is true and complete to the best of my knowledge and belief.

El Paso Natural Gas Co.  
 (Operator)

D. C. Plunston  
 (Representative)

Box 997

Address

Farmington, New Mexico

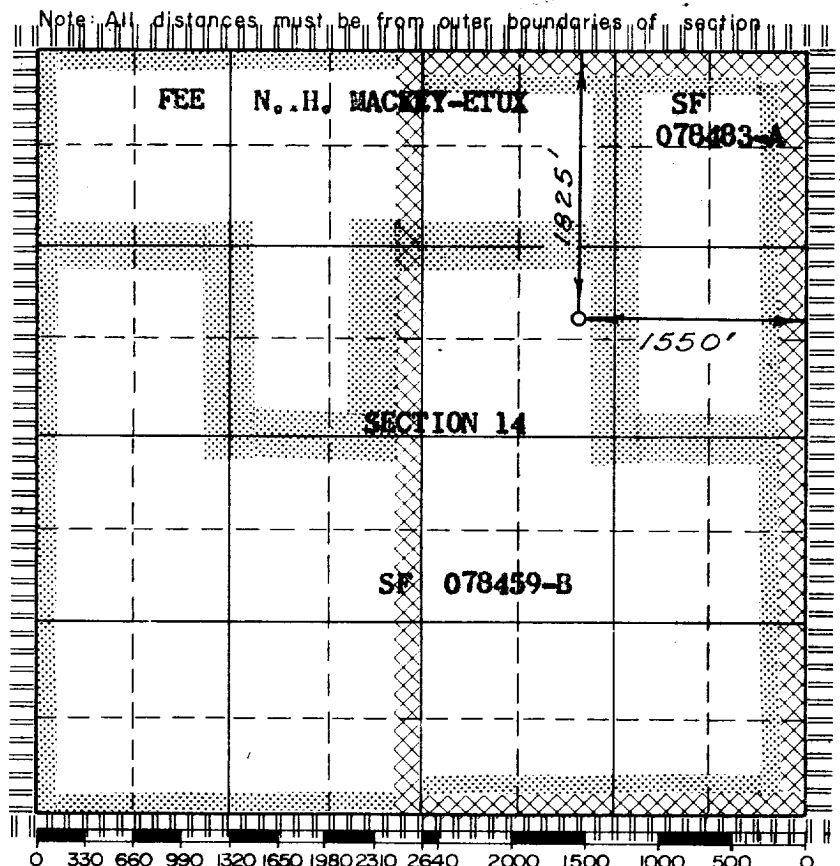
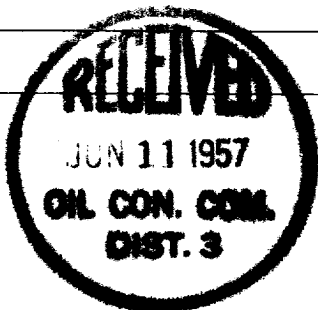

Scale 4 inches equal 1 mile

This is to certify that the above plat was prepared from field notes of actual surveys made by me or under my supervision and that the same are true and correct to the best of my knowledge and belief.

Date Surveyed MAY 6, 1957

E. O. Walker  
 Registered Professional Engineer and/or Land Surveyor

(Seal)

Farmington, New Mexico