

(SUBMIT IN TRIPLICATE)

Land Office **Santa Fe**
Lease No. **078483-A**
Unit **Allison**

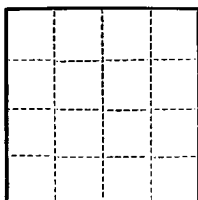

UNITED STATES
DEPARTMENT OF THE INTERIOR
GEOLOGICAL SURVEY

SUNDRY NOTICES AND REPORTS ON WELLS

NOTICE OF INTENTION TO DRILL.....	<input checked="" type="checkbox"/>	SUBSEQUENT REPORT OF WATER SHUT-OFF.....	
NOTICE OF INTENTION TO CHANGE PLANS.....		SUBSEQUENT REPORT OF SHOOTING OR ACIDIZING.....	
NOTICE OF INTENTION TO TEST WATER SHUT-OFF.....		SUBSEQUENT REPORT OF ALTERING CASING.....	
NOTICE OF INTENTION TO RE-DRILL OR REPAIR WELL.....		SUBSEQUENT REPORT OF RE-DRILLING OR REPAIR.....	
NOTICE OF INTENTION TO SHOOT OR ACIDIZE.....		SUBSEQUENT REPORT OF ABANDONMENT.....	
NOTICE OF INTENTION TO PULL OR ALTER CASING.....		SUPPLEMENTARY WELL HISTORY.....	
NOTICE OF INTENTION TO ABANDON WELL.....			

(INDICATE ABOVE BY CHECK MARK NATURE OF REPORT, NOTICE, OR OTHER DATA)

June 10, 1957

Well No. **13(MD)** is located **890** ft. from **S** line and **950** ft. from **E** line of sec. **12**

SW Sec. 12 **32N** **7W** **S.M.P.M.**
(1/4 Sec. and Sec. No.) (Twp.) (Range) (Meridian)
N. Los Pinos Dak. & Blanco M.V. **San Juan** **New Mexico**
(Field) (County or Subdivision) (State or Territory)

The elevation of the derrick floor above sea level is **6600** ft.

DETAILS OF WORK

(State names of and expected depths to objective sands; show sizes, weights, and lengths of proposed casings; indicate multiple completions; and all other important proposed work)

It is intended to drill and dual complete a well in the Dakota formation & Mesa Verde formation. Mud circulation will be used thru the Pictured Cliffs formation & set intermediate casing. Gas circulation will be used thru the Dakota & production casing will be set. Possible productive intervals will be perforated and fractured. Estimated Total Depth 8655'.

Casing Program:

13-3/8" at 170' with 350 sacks cement circulated to the surface.
9-5/8" at 3960' with 1000 sacks cement in 2 stages.
5-1/2" at 8655' with 300 sacks cement in 2 stages.

All of Section 12 is dedicated to the Mesa Verde.

All of Section 12 is dedicated to the Dakota.

SF 078483-A (W/2N/2); Fee-A.D. Young et al (E/2N/2, E/2).

I understand that this plan of work must receive approval in writing by the Geological Survey before operations may be commenced.

Company **El Paso Natural Gas Company**

Address **Box 997**

Farmington, New Mexico

By 
Title **Petroleum Engineer**

Well Location and Acreage Dedication Plat

Section A.

Date June 7, 1957

Operator EL PASO NATURAL GAS COMPANY Lease ALLISON SE 1/4
 Well No 1 Unit Letter T Section 12 Township 36N Range 1E NMPM
 Located 0.00 Feet From 90.00 Line, 450 Feet From 1.75 Line
 County SAN JUAN G. L. Elevation 5500 Dedicated Acreage 3.99 Acres
 Name of Producing Formation USA - GILBERT - JACOBY Pool BLAND

- Is the Operator the only owner in the dedicated acreage outlined on the plat below?
 Yes ☒ No ☐
- If the answer to question one is "no", have the interests of all the owners been consolidated by communication agreement or otherwise? Yes ☐ No ☐ If answer is "yes," Type of Consolidation _____
- If the answer to question two is "no," list all the owners and their respective interests below

Owner

Land Description

RECEIVED
JUN 10 1957

Section B

Note: All distances must be from outer boundaries of section.

This is to certify that the information in Section A above is true and complete to the best of my knowledge and belief

El Paso Natural Gas Co.

(Operator)

(Representative)

Box 997

Address

Farmington, New Mexico

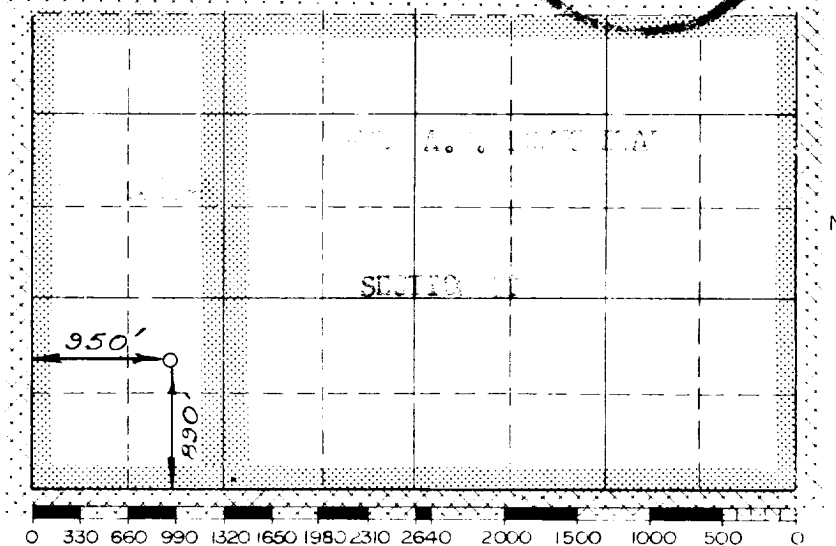

Scale 4 inches equal 1 mile

This is to certify that the above plat was prepared from field notes of actual surveys made by me or under my supervision and that the same are true and correct to the best of my knowledge and belief.

(Seal)

Farmington, New Mexico

Date Surveyed June 7, 1957

E. O. Walber
 Registered Professional Engineer and/or Land Surveyor