

(SUBMIT IN TRIPLICATE)

UNITED STATES
DEPARTMENT OF THE INTERIOR
GEOLOGICAL SURVEY

Budget Bureau No. 42-R358.4
Approval expires 12-31-60.

Land Office Santa Fe
Lease No. 080412
Unit San Juan 32-8 Unit
14-08-001-446

SUNDRY NOTICES AND REPORTS ON WELLS

RECEIVED

NOTICE OF INTENTION TO DRILL.....	X	SUBSEQUENT REPORT OF WATER SHUT-OFF.....	NOV 12 1959
NOTICE OF INTENTION TO CHANGE PLANS.....		SUBSEQUENT REPORT OF SHOOTING OR ACIDIZING.....	
NOTICE OF INTENTION TO TEST WATER SHUT-OFF.....		SUBSEQUENT REPORT OF ALTERING CASING.....	
NOTICE OF INTENTION TO RE-DRILL OR REPAIR WELL.....		SUBSEQUENT REPORT OF RE-DRILLING OR REPAIR.....	
NOTICE OF INTENTION TO SHOOT OR ACIDIZE.....		SUBSEQUENT REPORT OF ABANDONMENT.....	
NOTICE OF INTENTION TO PULL OR ALTER CASING.....		SUPPLEMENTARY WELL HISTORY.....	
NOTICE OF INTENTION TO ABANDON WELL.....			

(INDICATE ABOVE BY CHECK MARK NATURE OF REPORT, NOTICE, OR OTHER DATA)

November 10, 1959

Well No. 32-9 is located 1140 ft. from N line and 1800 ft. from W line of sec. 9
SW Sec. 9 32N 8W N.M.P.M.
(1/4 Sec. and Sec. No.) (Twp.) (Range) (Meridian)
Blanco Mesa Verde San Juan New Mexico
(Field) (County or Subdivision) (State or Territory)

The elevation of the derrick floor above sea level is 6992 ft.

DETAILS OF WORK

(State names of and expected depths to objective sands; show sizes, weights, and lengths of proposed casings; indicate mudding jobs, cementing points, and all other important proposed work)

It is intended to drill a well with rotary tools thru the Mesa Verde formation. Mud circulation will be used thru the Pictured Cliffs & set intermediate casing. Gas circulation will be used thru the Mesa Verde and production liner will be set. Possible productive intervals will be perforated and fractured. Est. T. D. 6516'.

Casing Program:

10 3/4" at 170' with 150 sacks cement circulated to the surface.
7 5/8" at 4236' with 250 sacks cement.
5 1/2" liner at 6516' with 300 sacks cement.

The 5/2 of Section 9 is dedicated to this well.

I understand that this plan of work must receive approval in writing by the Geological Survey before operations may be commenced

Company El Paso Natural Gas Company

Address Box 997
Farmington, New Mexico

By Original Signed E. J. WOOD
Title Petroleum Engineer

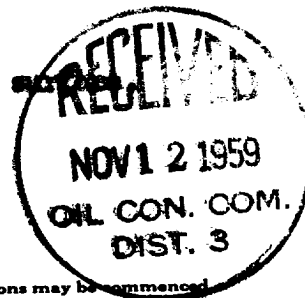

NEW MEXICO OIL CONSERVATION COMMISSION

Well Location and Acreage Dedication Plat

Section A.

Date **NOVEMBER 6, 1959**

Operator **EL PASO NATURAL GAS COMPANY** Lease **SAN JUAN 32-8 UNIT** SF **080412**
 Well No. **32-9** Unit Letter **H** Section **9** Township **32-N** Range **8-W** NMPM
 Located **1140** Feet From **SOUTH** Line, **1800** Feet From **WEST** Line
 County **SAN JUAN** G. L. Elevation **6982** Dedicated Acreage **320** Acres
 Name of Producing Formation **MESA VERDE** Pool **BLANCO MV**

1. Is the Operator the only owner in the dedicated acreage outlined on the plat below?

Yes _____ No **X**2. If the answer to question one is "no", have the interests of all the owners been consolidated by communitization agreement or otherwise? Yes _____ No **X** If answer is "yes", Type of Consolidation.

3. If the answer to question two is "no", list all the owners and their respective interests below:

OwnerLand Description

Section B.

Note: All distances must be from outer boundaries of section.

This is to certify that the information
 in Section A above is true and complete
 to the best of my knowledge and belief.

~~El Paso Natural Gas Company~~

(Operator)

Original Signed **F. H. WOOD**

(Representative)

~~Box 917~~

(Address)

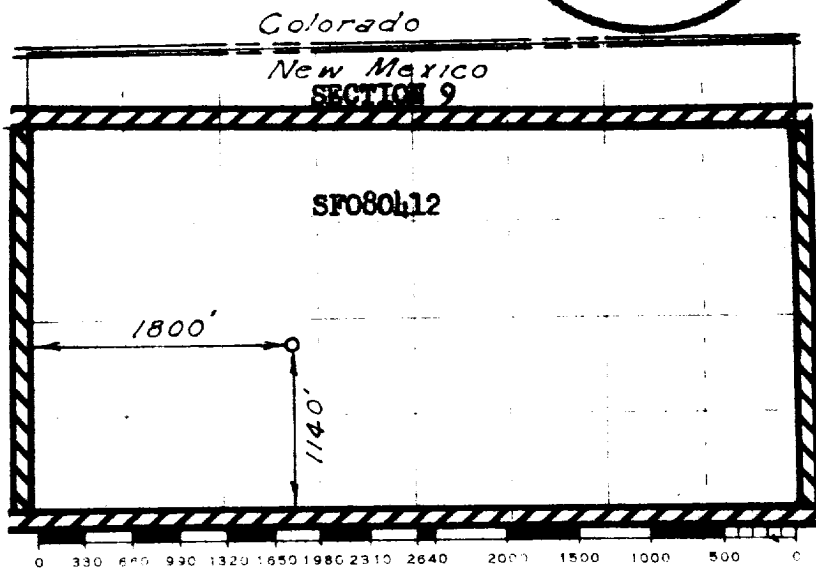
~~Farmington, New Mexico~~

Scale 4 inches equal 1 mile

This is to certify that the above plat was prepared from field notes of actual surveys made by me or under my supervision and that the same are true and correct to the best of my knowledge and belief.

(Seal)

Date Surveyed **NOVEMBER 3, 1959**

Gail O. Tilner
 Registered Professional Engineer and/or Land Surveyor

Farmington, New Mexico