



COPY TO O.C.C.

IN REPLY REFER TO:

UNITED STATES  
DEPARTMENT OF THE INTERIOR  
GEOLOGICAL SURVEY  
P. O. Box 965  
Farmington, New Mexico

February 14, 1956

Pubco Development, Inc.  
Box 1419  
Albuquerque, New Mexico

Re: Santa Fe 078119

Gentlemen:

Receipt is acknowledged of your "Notice of Intention to Drill" dated February 13, 1956 covering your well No. 2-X Pubco Suter in SW 1/4 sec. 12, T. 32 N., R. 11 W., N. M. P. M., San Juan County, New Mexico, Blanco Mesaverde pool.

Your proposed work is hereby approved subject to compliance with the provisions of the "Oil and Gas Operating Regulations" revised May 25, 1942, a copy of which will be sent to you on request, and subject to the following conditions:

1. Drilling operations so authorized are subject to the attached sheet for general conditions of approval.
2. Furnish copies of all logs.

Very truly yours,

(Orig. Sgd.) P. T. McGRATH

P. T. McGrath  
District Engineer

PTMcGrath:ac

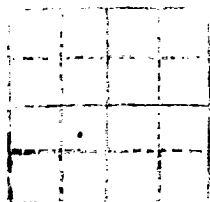

IN REPLY REFER TO

UNITED STATES  
DEPARTMENT OF THE INTERIOR  
GEOLOGICAL SURVEY



July 10 1906

TO THE DIRECTOR  
GEOLOGICAL SURVEY  
WASHINGTON, D. C.

SIR:

I have the honor to acknowledge the receipt of your letter of the 10th inst. and in reply to inform you that the same has been forwarded to the proper authorities for their consideration.

I am, Sir, very respectfully,  
Yours very truly,  
J. W. GARDNER  
Assistant Director



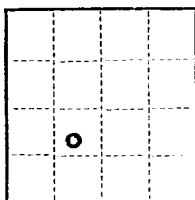

(SUBMIT IN TRIPLICATE)

UNITED STATES  
DEPARTMENT OF THE INTERIOR  
GEOLOGICAL SURVEY

**Santa Fe**  
Land Office \_\_\_\_\_  
Lease No. **SF 078119**  
Unit \_\_\_\_\_

**SUNDRY NOTICES AND REPORTS ON WELLS**

**RECEIVED**  
FEB 14 1956  
U.S. GEOLOGICAL SURVEY  
WASHINGTON, NEW MEXICO

NOTICE OF INTENTION TO DRILL.....	<b>XX</b>	SUBSEQUENT REPORT OF WATER SHUT-OFF.....
NOTICE OF INTENTION TO CHANGE PLANS.....		SUBSEQUENT REPORT OF SHOOTING OR ACIDIZING.....
NOTICE OF INTENTION TO TEST WATER SHUT-OFF.....		SUBSEQUENT REPORT OF ALTERING CASING.....
NOTICE OF INTENTION TO RE-DRILL OR REPAIR WELL.....		SUBSEQUENT REPORT OF RE-DRILLING OR REPAIR.....
NOTICE OF INTENTION TO SHOOT OR ACIDIZE.....		SUBSEQUENT REPORT OF ABANDONMENT.....
NOTICE OF INTENTION TO PULL OR ALTER CASING.....		SUPPLEMENTARY WELL HISTORY.....
NOTICE OF INTENTION TO ABANDON WELL.....		

(INDICATE ABOVE BY CHECK MARK NATURE OF REPORT, NOTICE, OR OTHER DATA)

February 13, 1956

**Pubco Federal Suter**  
Well No. **No. 2-X** is located 1750 ft. from **XX** [S] line and 1750 ft. from **XX** [W] line of sec. 12  
**SW 1/4 Section 12**      **32 North 11 West**      **N.M.P.M.**  
(1/4 Sec. and Sec. No.)      (Twp.)      (Range)      (Meridian)  
**Blanco Mesaverde**      **San Juan**      **New Mexico**  
(Field)      (County or Subdivision)      (State or Territory)

The elevation of the ~~ground level~~ <sup>ground level</sup> above sea level is **6476** ft.

**DETAILS OF WORK**

(State names of and expected depths to objective sands; show sizes, weights, and lengths of proposed casings; indicate mudding jobs, cementing points, and all other important proposed work)

It is proposed to drill with rotary mud through the base of the Pictured Cliff formation, set intermediate casing at approximately 3,500 feet; then drill with gas through the Mesaverde formation or to the top of the Mancos shale. It is further proposed to sand-water frac the Mesaverde formation. Estimated TD: 5,700 1/2 feet. Tentative casing program:

10-3/4" surface      250 1/2 feet; cement w/200 sacks  
7-5/8" intermediate      3500 1/2 feet; cement w/250 sacks  
5-1/2"      5,700 1/2 feet.

The South Half (S 1/2) of the section is designated drilling unit.

\$25,000 blanket bond previously approved and on file with the Commission.

I understand that this plan of work must receive approval in writing by the Geological Survey before operations may be commenced.

Company **PUBCO DEVELOPMENT, INC.**

Address **Post Office Box 1419**

**Albuquerque, New Mexico**

By   
**Frank D. Gorham, Jr.**  
Title **Vice President**

NEW MEXICO  
OIL CONSERVATION COMMISSION

Form C-123

Well Location and/or Gas Proration Plat

Date February 14 1956

RECEIVED  
FEB 14 1956  
U. S. GEOLOGICAL SURVEY  
SANTA FE, NEW MEXICO

Operator Pubco Development Co.

Lease Suter

Well No. 2-X Section 12 Township 32 N

Range 11

Located 1750 Feet From south Line, 1750 Feet From west Line.

San Juan County, New Mexico. G. L. Elevation 6476

Name of Producing Formation Mesaverde Pool Blanco Mesaverde Dedicated Acreage 333.60 (8<sup>1</sup>/<sub>2</sub> or Lots 1,2,3,4,8,9)

(Note: All distances must be from outer boundaries of Section)

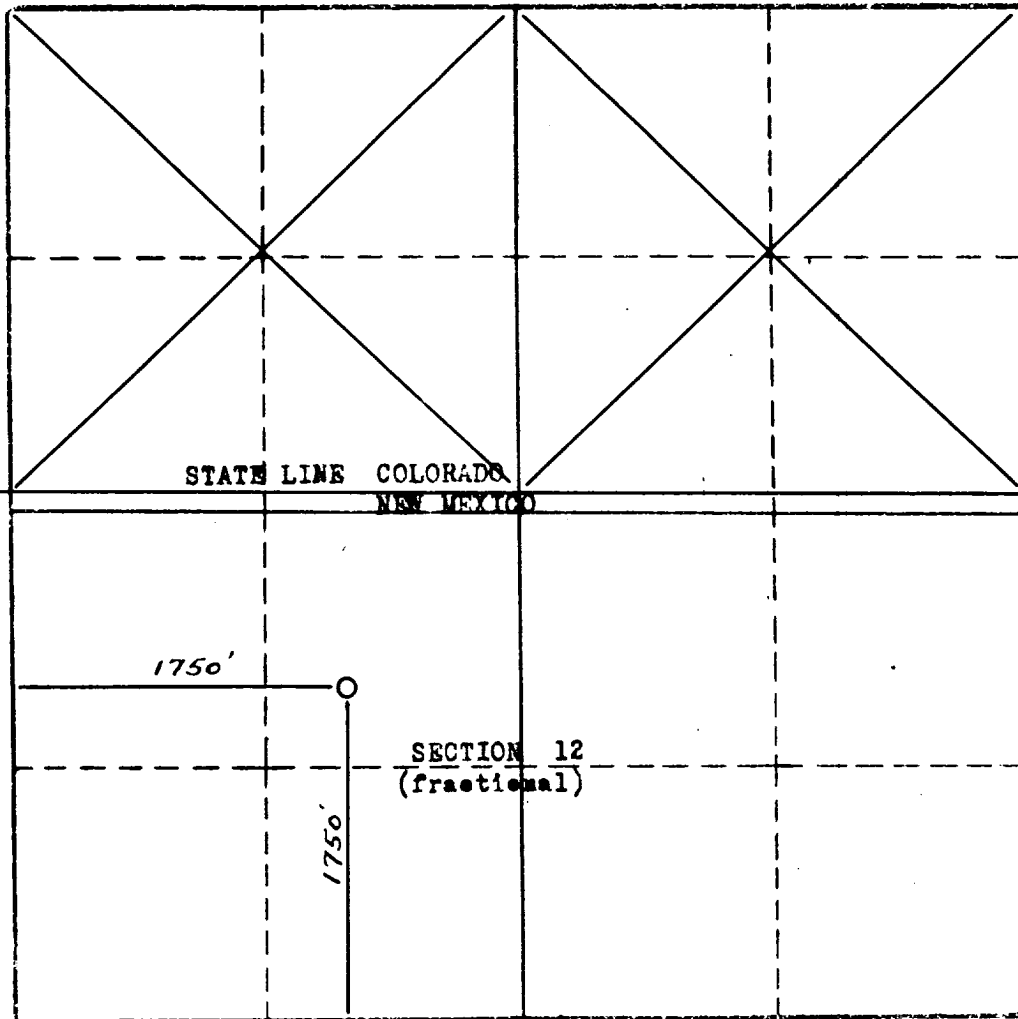

Scale--1 Inch Equals 1000 Feet

1. Is this Well a Dual Comp.? Yes ☐ No ☒
2. If the answer to Question 1 is yes, are there any other dually completed wells within the dedicated acreage? Yes ☐ No ☒

Name Frank D. Gorham, Jr.

Position Vice President

Representing Pubco Development, Inc.

Address Box 1419, Albuquerque, New Mexico

This is to certify that the above plat was prepared from field notes of actual surveys made by me or under my supervision and that the same are true and correct to the best of my knowledge and belief.

Date Surveyed January 18, 1956

Stephen H. Kinney

STEPHEN H. KINNEY,  
Registered Professional Engineer and Land Surveyor