



COPY TO O.G.G.

UNITED STATES
DEPARTMENT OF THE INTERIOR
GEOLOGICAL SURVEY
P. O. Box 965
Farmington, New Mexico

October 21, 1955

Pacific Northwest Pipeline Corporation
113 1/2 West Main Street
Farmington, New Mexico

Re: New Mexico 03189
14-08-001-946

Gentlemen:

Receipt is acknowledged of your "Notice of Intention to Drill" dated October 20, 1955 covering your well No. 3-9 Cox Canyon in NW 1/4 sec. 9, T. 32 N., R. 11 W., N. M. P. M., San Juan County, New Mexico, Blanco pool.

Your proposed work is hereby approved subject to compliance with the provisions of the "Oil and Gas Operating Regulations" revised May 25, 1942, a copy of which will be sent to you on request, and subject to the following conditions:

1. Drilling operations so authorized are subject to the attached sheet for general conditions of approval.
2. Furnish copies of all logs.

Very truly yours,

(Orig. Sgd.) P. T. McGrath

P. T. McGrath
District Engineer

PTMcGrath:ac

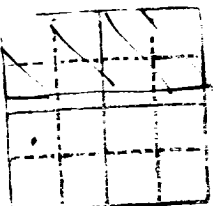

UNITED STATES
DEPARTMENT OF THE INTERIOR
GEOLOGICAL SURVEY



WASHINGTON, D. C.

1900

1900

1900

1900

1900

1900

1900

1900

1900

1900

1900

1900

1900

1900

1900

1900

3 - U.S.G.S.
1 - W.A. Johnston
1 - File

(SUBMIT IN TRIPLICATE)

Budget Bureau 42-R358.3
Approval expires 12-31-55.

Land Office New Mexico

Lease No. 02189

Unit COE CANYON
714-28-001-946

UNITED STATES
DEPARTMENT OF THE INTERIOR
GEOLOGICAL SURVEY

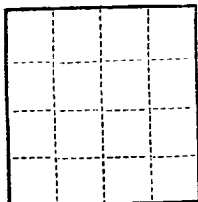

SUNDRY NOTICES AND REPORTS ON WELLS

NOTICE OF INTENTION TO DRILL.....	<input checked="" type="checkbox"/>	SUBSEQUENT REPORT OF WATER SHUT-OFF.....	
NOTICE OF INTENTION TO CHANGE PLANS.....		SUBSEQUENT REPORT OF SHOOTING OR ACIDIZING.....	
NOTICE OF INTENTION TO TEST WATER SHUT-OFF.....		SUBSEQUENT REPORT OF ALTERING CASING.....	
NOTICE OF INTENTION TO RE-DRILL OR REPAIR WELL.....		SUBSEQUENT REPORT OF RE-DRILLING OR REPAIR.....	
NOTICE OF INTENTION TO SHOOT OR ACIDIZE.....		SUBSEQUENT REPORT OF ABANDONMENT.....	
NOTICE OF INTENTION TO PULL OR ALTER CASING.....		SUPPLEMENTARY WELL HISTORY.....	
NOTICE OF INTENTION TO ABANDON WELL.....			

(INDICATE ABOVE BY CHECK MARK NATURE OF REPORT, NOTICE, OR OTHER DATA)

Well No. 3-9 is located 1690 ft. from S line and 990 ft. from W line of sec. 9

18 1/4 34 1/4 Sec. 9 (1/4 Sec. and Sec. No.) 12N (Twp.) 11W (Range) T.4S. R.1E (Meridian)
Blanco (Field) San Juan (County or Subdivision) New Mexico (State or Territory)

The elevation of the ~~surface~~ ^{degraded ground} above sea level is 6514.1 ft.

DETAILS OF WORK

(State names of and expected depths to objective sands; show sizes, weights, and lengths of proposed casings; indicate mudding jobs, cementing points, and all other important proposed work)

Propose to drill 15" hole to 250' set 10-3/4" casing w/ 125 ex. 45 gal then drill w/ water or minimum mud to 340', set 7-5/8" casing w/ 150 ex. 85 gal and 50 ex. bent on bottom. Drill to 5715' w/ gas, and set 5 1/2" casing w/ 125 ex. 25 gal. Perforate 4 sand from Cliff House 5570-5181, Monaca 5182 - 5534, & Point Lookout 5535- 5715, each from separately w/ 40,000 gal. water w/ approx. 1 1/2 cu. gal. 334.48 Acres dedicated to this well.

I understand that this plan of work must receive approval in writing by the Geological Survey before operations may be commenced.

Company PACIFIC NORTH WEST OIL & GAS CORPORATION

Address 413 1/2 West Main St.,

Farmington, New Mexico

By J. A. Ryan

Title District Engineer

Company..... **PACIFIC NORTHWEST PIPELINE CORPORATION**

Lease..... Well No.....

Sec. **9**....., T. **32 N.**....., R. **11 W.** **N.M.P.M.**

Location..... **1650 FEET FROM THE SOUTH LINE AND 990**
FEET FROM THE WEST LINE.

Elevation..... **6548.1 UNGRADED GROUND**

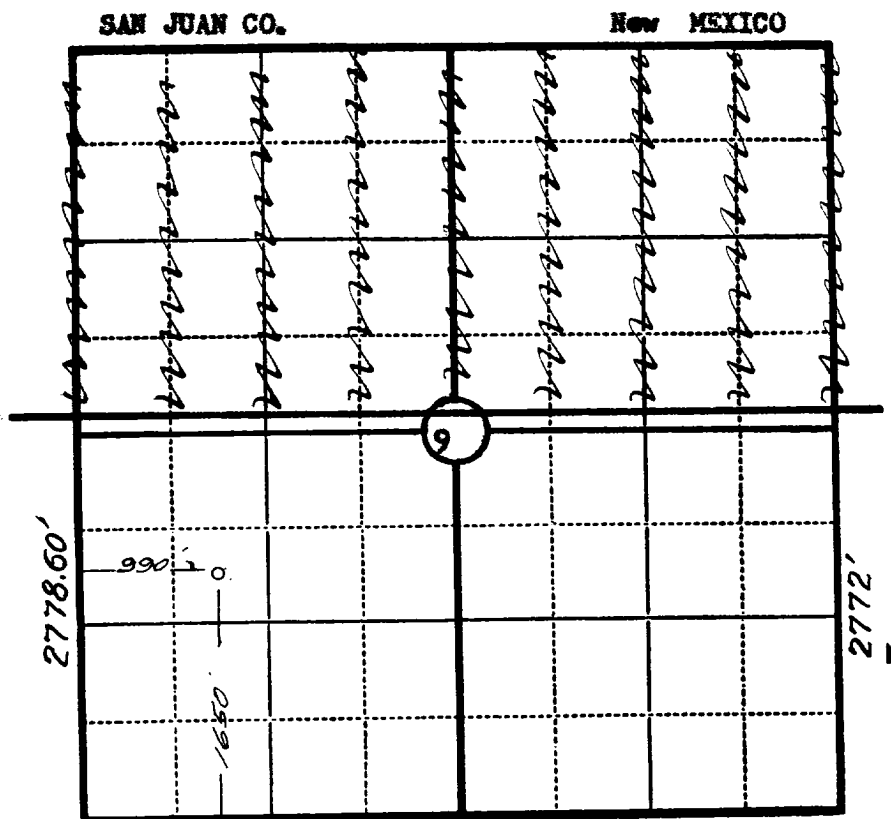

Scale—4 inches equal 1 mile.

This is to certify that the above plat was prepared from field notes of actual surveys made by me or under my supervision and that the same are true and correct to the best of my knowledge and belief.

Seal:

James P. Leese
Registered Land Surveyor.
N.MEX REG. NO. 1463

Surveyed **AUGUST 11**....., 19**55**.....

SAN JUAN ENGINEERING COMPANY, FARMINGTON, N. M.