

1000 Rio Brazos Rd. Aztec, NM 87410

Energy, Minerals and Natural Resources Department

Santa Fe, New Mexico 87504-2088

SUBMIT 1 COPY TO
APPROPRIATE
DISTRICT OFFICE
AND 1 COPY TO
SANTA FE OFFICE
(Revised 3/9/94)

PIT REMEDIATION AND CLOSURE REPORT

Telephone: 505-324-5846

Address: 3315 Bloomfield Hwy - Farmington, NM 87401

Facility Or: Newberry Corn Well No. 1

Well Name

Location:	Unit or Qtr/Qtr Sec	G	Sec	5 T	31N R	12W County	San Juan
-----------	---------------------	---	-----	-----	-------	------------	----------

Pit Type:	Separator	X	Dehydrator	Other
-----------	-----------	---	------------	-------

Land Type:	BLM	X	State	Fee	Other
------------	-----	---	-------	-----	-------

Pit Location: Pit dimension: length 12' width 10' depth 2.5'
(Attach diagram)

Reference: wellhead X other

Footage from reference: 109'

Direction from reference: 169 Degrees East of North
West X South

Depth To Ground Water:

Less than 50 feet (20 points)

(Vertical distance from
contaminants to seasonal
high water elevation of
ground water)

50 feet to 99 feet (10 points)

Greater than 100 feet (0 points)

Total	10
-------	----

Wellhead Protection Area:

Yes (20 points)

(Less than 200 feet from a private domestic water source, or; less than 1000 feet from all other water sources)

No (0 points)

Total	0
-------	---

Distance To Surface Water:

Less than 200 feet (20 points) (20 points)

(Horizontal distance to perennial lakes, ponds, rivers, streams, creeks, irrigation canals and ditches)

200 feet to 1000 feet (10 points) (10 points)

Greater than 1000 feet (0 points) (0 points)

Total	0
-------	---

RANKING SCORE (TOTAL POINTS): 10

Date Remediation Started: <u>4/21/99</u>		Date Completed: <u>4/21/99</u>	
Remediation Method: (Check all appropriate sections)	Excavation: <u>X</u>	Approx. cubic yards	<u>64</u>
	Landfarm <u>X</u>	In situ Bioremediation	<u> </u>
	Other <u> </u>		
Remediation Location: (ie. landfarmed onsite, name and location of offsite facility)	Onsite <u>X</u>	Offsite <u> </u>	
General Description Of Remedial Action: <u> </u>			
<u>Dug out pit to 12' x 12' x 12'. Sample taken. Pit was backfilled with clean soil. Contaminated soil was landfarmed.</u>			
<u>Landfarm was sampled on 6/28/00; TPH = 1.0 ppm; Benzene = 0.0742 ppm; Total BTEX = 0.673 ppm.</u>			
<u>Landfarm was closed.</u>			
Ground Water Encountered:	No <u>X</u> Yes <u> </u>	Depth	<u> </u>
Final Pit:	Sample location	<u>Composite (4 wall plus 3' below pit bottom)</u>	
Closure Sampling:	<u> </u>		
(if multiple samples attach sample results and diagram of sample locations and depths)	Sample depth	<u>12'</u>	
	Sample date <u>4/21/99</u>	Sample time	<u>9:27 AM</u>
Sample Results			
	Benzene (ppm)	<u>Not tested</u>	
	Total BTEX (ppm)	<u>Not tested</u>	
	Field headspace (ppm)	<u>35</u>	
	TPH (ppm)	<u>1.2</u>	
Ground Water Sample:	Yes <u> </u> No <u>X</u>	(If yes, attach sample results)	
I HEREBY CERTIFY THAT THE INFORMATION ABOVE IS TRUE AND COMPLETE TO THE BEST OF MY KNOWLEDGE AND BELIEF			
DATE	<u>11/15/00</u>	PRINTED NAME	<u>John E. Cofer</u>
SIGNATURE	<u>[Signature]</u>	AND TITLE	<u>Environmental Coordinator</u>

ENVIROTECH LABS

PRACTICAL SOLUTIONS FOR A BETTER TOMORROW

EPA METHOD 8015 Modified Nonhalogenated Volatile Organics Total Petroleum Hydrocarbons

Client:	Conoco Inc.	Project #:	707003-018
Sample ID:	SEP - Grab	Date Reported:	04-26-99
Laboratory Number:	F080	Date Sampled:	04-22-99
Chain of Custody No:	6787	Date Received:	04-23-99
Sample Matrix:	Soil	Date Extracted:	04-26-99
Preservative:	Cool	Date Analyzed:	04-26-99
Condition:	Cool and Intact	Analysis Requested:	8015 TPH

Parameter	Concentration (mg/Kg)	Det. Limit (mg/Kg)
Gasoline Range (C5 - C10)	1.2	0.2
Diesel Range (C10 - C28)	ND	0.1
Total Petroleum Hydrocarbons	1.2	0.2

ND - Parameter not detected at the stated detection limit.

References: Method 8015B, Nonhalogenated Volatile Organics, Test Methods for Evaluating Solid Waste, SW-846, USEPA, December 1996.

Comments: Newberry Com. 1 Center of Pit. OVM Reading 35.

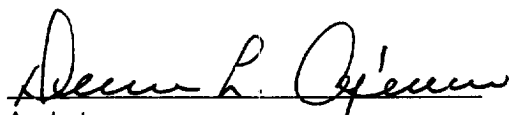
Analyst

Review

ENVIROTECH LABS

PRACTICAL SOLUTIONS FOR A BETTER TOMORROW

EPA METHOD 8015 Modified Nonhalogenated Volatile Organics Total Petroleum Hydrocarbons

Client: Conoco Inc.
Sample ID: 4 Pt. Comp - SEP
Laboratory Number: F081
Chain of Custody No: 6787
Sample Matrix: Soil
Preservative: Cool
Condition: Cool and Intact

Project #: 707003-018
Date Reported: 04-26-99
Date Sampled: 04-21-99
Date Received: 04-23-99
Date Extracted: 04-26-99
Date Analyzed: 04-26-99
Analysis Requested: 8015 TPH

Parameter	Concentration (mg/Kg)	Det. Limit (mg/Kg)
Gasoline Range (C5 - C10)	0.6	0.2
Diesel Range (C10 - C28)	0.3	0.1
Total Petroleum Hydrocarbons	0.9	0.2

ND - Parameter not detected at the stated detection limit.

References: Method 8015B, Nonhalogenated Volatile Organics, Test Methods for Evaluating Solid Waste, SW-846, USEPA, December 1996.

Comments: Newberry Com. 1.

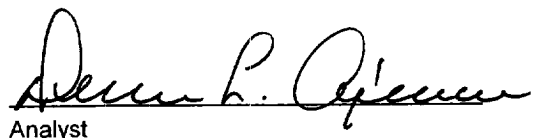
Analyst

Review

CHAIN OF CUSTODY RECORD

6787

Client / Project Name			Project Location			ANALYSIS / PARAMETERS								
Conoco Inc.			NEUBERRY COM. 1											
Sampler: J. Valdez			Client No. 707003-018			No. of Containers								
Sample No./ Identification			Sample Date		Sample Time		Lab Number		Sample Matrix		876x 800x TPH 800.5 OVM READING		Remarks	
Sep - Grab			4-28-99		0823		F080		Soil		1		✓ 35	
4 PT COMP-SEP			4-21-99		1000		F081		Soil		1		✓	
4-28-99			0823		0823		F080		Soil		1			
4-28-99			0823		0823		F080		Soil		1			
4-28-99			0823		0823		F080		Soil		1			
4-28-99			0823		0823		F080		Soil		1			
4-28-99			0823		0823		F080		Soil		1			
4-28-99			0823		0823		F080		Soil		1			
4-28-99			0823		0823		F080		Soil		1			
4-28-99			0823		0823		F080		Soil		1			
4-28-99			0823		0823		F080		Soil		1			
4-28-99			0823		0823		F080		Soil		1			
4-28-99			0823		0823		F080		Soil		1			
4-28-99			0823		0823		F080		Soil		1			
4-28-99			0823		0823		F080		Soil		1			
4-28-99			0823		0823		F080		Soil		1			
4-28-99			0823		0823		F080		Soil		1			
4-28-99			0823		0823		F080		Soil		1			
4-28-99			0823		0823		F080		Soil		1			
4-28-99			0823		0823		F080		Soil		1			
4-28-99			0823		0823		F080		Soil		1			
4-28-99			0823		0823		F080		Soil		1			
4-28-99			0823		0823		F080		Soil		1			
4-28-99			0823		0823		F080		Soil		1			
4-28-99			0823		0823		F080		Soil		1			
4-28-99			0823		0823		F080		Soil		1			
4-28-99			0823		0823		F080		Soil		1			
4-28-99			0823		0823		F080		Soil		1			
4-28-99			0823		0823		F080		Soil		1			
4-28-99			0823		0823		F080		Soil		1			
4-28-99			0823		0823		F080		Soil		1			
4-28-99			0823		0823		F080		Soil		1			
4-28-99			0823		0823		F080		Soil		1			
4-28-99			0823		0823		F080		Soil		1			
4-28-99			0823		0823		F080		Soil		1			
4-28-99			0823		0823		F080		Soil		1			
4-28-99			0823		0823		F080		Soil		1			
4-28-99			0823		0823		F080		Soil		1			
4-28-99			0823		0823		F080		Soil		1			
4-28-99			0823		0823		F080		Soil		1			
4-28-99			0823		0823		F080		Soil		1			
4-28-99			0823		0823		F080		Soil		1			
4-28-99			0823		0823		F080		Soil		1			
4-28-99			0823		0823		F080		Soil		1			
4-28-99			0823		0823		F080		Soil		1			
4-28-99			0823		0823		F080		Soil		1			
4-28-99			0823		0823		F080		Soil		1			
4-28-99			0823		0823		F080		Soil		1			
4-28-99			0823		0823		F080		Soil		1			
4-28-99			0823		0823		F080		Soil		1			
4-28-99			0823		0823		F080		Soil		1			
4-28-99			0823		0823		F080		Soil		1			
4-28-99			0823		0823		F080		Soil		1			
4-28-99			0823		0823		F080		Soil		1			
4-28-99			0823		0823		F080		Soil		1			
4-28-99			0823		0823		F080		Soil		1			
4-28-99			0823		0823		F080		Soil		1			
4-28-99			0823		0823		F080		Soil		1			
4-28-99			0823		0823		F080		Soil		1			
4-28-99			0823		0823		F080		Soil		1			
4-28-99			0823		0823		F080		Soil		1			
4-28-99			0823		0823		F080		Soil		1			
4-28-99			0823		0823		F080		Soil		1			
4-28-99			0823		0823		F080		Soil		1			
4-28-99			0823		0823		F080		Soil		1			
4-28-99			0823		0823		F080		Soil		1			
4-28-99			0823		0823		F080		Soil		1			
4-28-99			0823		0823		F080		Soil		1			
4-28-99			0823		0823		F080		Soil		1			
4-28-99			0823		0823		F080		Soil		1			
4-28-99			0823		0823		F080		Soil		1			
4-28-99			0823		0823		F080		Soil		1			
4-28-99			0823		0823		F080		Soil		1			
4-28-99			0823		0823		F080		Soil		1			
4-28-99			0823		0823		F080		Soil		1			
4-28-99			0823		0823		F080		Soil		1			
4-28-99			0823		0823		F080		Soil		1			
4-28-99			0823		0823		F080		Soil		1			
4-28-99			0823		0823		F080		Soil		1			
4-28-99			0823		0823		F080		Soil		1			
4-28-99			0823		0823		F080		Soil		1			
4-28-99			0823		0823		F080		Soil		1			
4-28-99			0823		0823		F080		Soil		1			
4-28-99			0823		0823		F080		Soil		1			
4-28-99			0823		0823		F080		Soil		1			
4-28-99			0823		0823		F080		Soil		1			
4-28-99			0823		0823		F080		Soil		1			
4-28-99			0823		0823		F080		Soil		1			
4-28-99			0823		0823		F080		Soil		1			
4-28-99			0823		0823		F080		Soil		1			
4-28-99			0823		0823		F080		Soil		1			
4-28-99			0823		0823		F080		Soil		1			
4-28-99			0823		0823		F080		Soil		1			
4-28-99			0823		0823		F080		Soil		1			
4-28-99			0823		0823		F080		Soil		1			
4-28-99			0823		0823		F080		Soil		1			
4-28-99			0823		0823		F080		Soil		1			
4-28-99			0823		0823		F080		Soil		1			
4-28-99			0823		0823		F080		Soil		1			
4-28-99			0823		0823		F080		Soil		1			
4-28-99			0823		0823		F080		Soil		1			
4-28-99			0823		0823		F080		Soil		1			
4-28-99			0823		0823		F080		Soil		1			
4-28-99			0823		0823		F080		Soil		1			
4-28-99			0823		0823		F080		Soil		1			
4-28-99			0823											

**EPA METHOD 8015 Modified
Nonhalogenated Volatile Organics
Total Petroleum Hydrocarbons**

Client:	Conoco, Inc.	Project #:	707003-209
Sample ID:	Landfarm #1	Date Reported:	07-07-00
Laboratory Number:	H656	Date Sampled:	06-28-00
Chain of Custody No:	8023	Date Received:	06-30-00
Sample Matrix:	Soil	Date Extracted:	07-05-00
Preservative:	Cool	Date Analyzed:	07-07-00
Condition:	Cool and Intact	Analysis Requested:	8015 TPH

Parameter	Concentration (mg/Kg)	Det. Limit (mg/Kg)
Gasoline Range (C5 - C10)	0.7	0.2
Diesel Range (C10 - C28)	0.3	0.1
Total Petroleum Hydrocarbons	1.0	0.1

ND - Parameter not detected at the stated detection limit.

References: Method 8015B, Nonhalogenated Volatile Organics, Test Methods for Evaluating Solid Waste, SW-846, USEPA, December 1996.

Comments: **Newberry Com 1.**

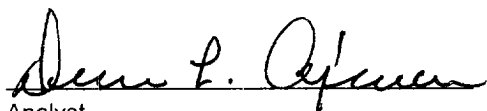
Analyst

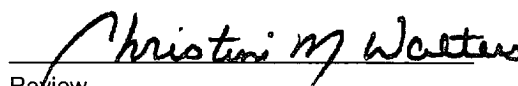
Review

Client:	Conoco, Inc.	Project #:	707003-209
Sample ID:	Landfarm #1	Date Reported:	07-07-00
Laboratory Number:	H656	Date Sampled:	06-28-00
Chain of Custody:	8023	Date Received:	06-30-00
Sample Matrix:	Soil	Date Analyzed:	07-07-00
Preservative:	Cool	Date Extracted:	07-05-00
Condition:	Cool & Intact	Analysis Requested:	BTEX

Parameter	Concentration (ug/Kg)	Det. Limit (ug/Kg)
Benzene	74.2	1.8
Toluene	182	1.7
Ethylbenzene	91.9	1.5
p,m-Xylene	234	2.2
o-Xylene	90.4	1.0
Total BTEX	673	

ND - Parameter not detected at the stated detection limit.

Surrogate Recoveries:	Parameter	Percent Recovery
	Trifluorotoluene	100 %
	Bromofluorobenzene	100 %

References: Method 5030B, Purge-and-Trap, Test Methods for Evaluating Solid Waste, SW-846, USEPA, December 1996.

Method 8021B, Aromatic Volatile Organics, Test Methods for Evaluating Solid Waste, SW-846, USEPA, December 1996.

Comments: Newberry Com 1.

Analyst

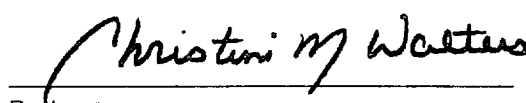
Review

08023

[illegible]

Revised 11-13-98

Lease Name: Newberry Com 1

Operator: Conoco Inc.

Date:

4-20-99

Site Security

(Indicate North)

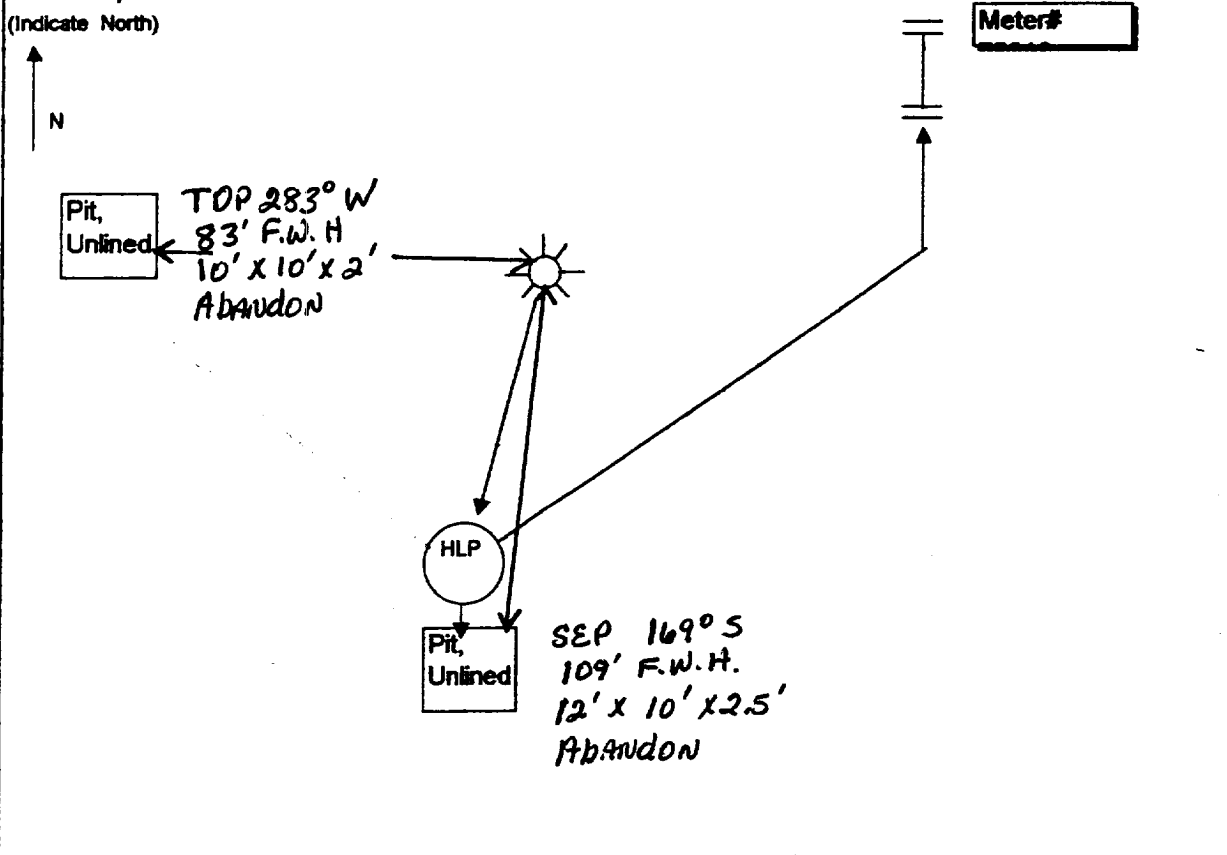

Lease Name: Newberry Com. 1

Federal/ Indian Lease No: SF-078146

CA No.: _____