

U. S. LAND OFFICE **New Mexico**

SERIAL NUMBER \_\_\_\_\_

**CONFIDENTIAL** LEASE OR PERMIT TO PROSPECT \_\_\_\_\_  
14-20-0603-7116

UNITED STATES

DEPARTMENT OF THE INTERIOR

GEOLOGICAL SURVEY

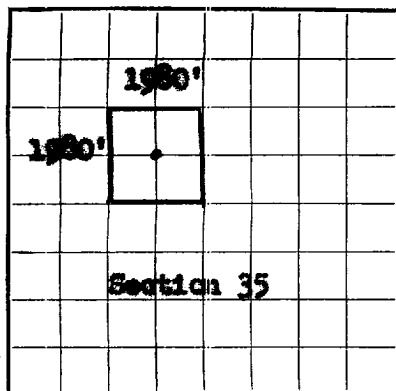

**LOG OF OIL OR GAS WELL**

LOCATE WELL CORRECTLY

Standard Oil Company of Texas,  
A Division of California Oil Co.

Company **A Division of California Oil Co.** Address **Drawer "E", Monahans, Texas**

Lessor or Tract **Navajo Tribal 21** Field **Undesignated** State **New Mexico**

Well No. **1** Sec. **35** T. **31N** R. **18W** Meridian **NMNM** County **San Juan**

Location **1980 ft. [N] of N. Line and 1980 ft. [E] of W. Line of Section 35** Elevation **5025.6 KDB**  
(Denote floor levels to sea level)

The information given herewith is a complete and correct record of the well and all work done thereon so far as can be determined from all available records.

Signed **G. G. Long** Title **Lease Operator**  
Date **February 10, 1964**

The summary on this page is for the condition of the well at above date.

Commenced drilling **October 25, 1963** Finished drilling **October 25, 1963**

**OIL OR GAS SANDS OR ZONES**  
(Denote gas by G)

No. 1, from **6630** to **7000 - R.D.** No. 4, from \_\_\_\_\_ to \_\_\_\_\_  
No. 2, from \_\_\_\_\_ to \_\_\_\_\_ No. 5, from \_\_\_\_\_ to \_\_\_\_\_  
No. 3, from \_\_\_\_\_ to \_\_\_\_\_ No. 6, from \_\_\_\_\_ to \_\_\_\_\_

**IMPORTANT WATER SANDS**

No. 1, from \_\_\_\_\_ to \_\_\_\_\_ No. 3, from \_\_\_\_\_ to \_\_\_\_\_  
No. 2, from \_\_\_\_\_ to \_\_\_\_\_ No. 4, from \_\_\_\_\_ to \_\_\_\_\_

**CASING RECORD**

Size casing	Weight per foot	Threads per inch	Make	Amount	Kind of shoe	Cut and pulled from	Perforated		Purpose
							From	To	
13-3/8"	48	5/8"	K-10	79	Guide	None			Protect Surf.
9-5/8"	36	5/8"	J-15	977	Guide	None			Protect Surf.
5-1/2"	18.8	5/8"	J-15	700	Flare	None			Oil string
2-3/8"	4.7	5/8"	J-15	672					Production tubing

**MUDDING AND CEMENTING RECORD**

Size casing	Where set	Number sacks of cement	Method used	Mud gravity	Amount of mud used
13-3/8"	79	70	Pump & plug		
9-5/8"	877	350	Pump & plug		
5-1/2"	700	400	Pump & plug		

**PLUGS AND ADAPTERS**

Heaving plug—Material \_\_\_\_\_ Length \_\_\_\_\_ Depth set \_\_\_\_\_  
Adapters—Material \_\_\_\_\_ Size \_\_\_\_\_

**SHOOTING RECORD**

Size	Shell used	Explosive used	Quantity	Date	Depth shot	Depth cleaned out

**TOOLS USED**

Rotary tools were used from **Surface** feet to **7000 (T.D.)** feet, and from \_\_\_\_\_ feet to \_\_\_\_\_ feet  
Cable tools were used from \_\_\_\_\_ feet to \_\_\_\_\_ feet, and from \_\_\_\_\_ feet to \_\_\_\_\_ feet

**DATES**

**February 10, 1964** Put to producing **February 5, 1964**

The production for the first 24 hours was **127** barrels of fluid of which **99.5%** was oil; **0%** emulsion; **0%** water; and **0.5%** sediment. Gravity, **49 Degrees A.P.I.**

If gas well, cu. ft. per 24 hours \_\_\_\_\_ Gallons gasoline per 1,000 cu. ft. of gas \_\_\_\_\_

Rock pressure, lbs. per sq. in. \_\_\_\_\_

**EMPLOYEES**

**James V. Gay**, Driller **T. L. Jones**, Driller  
**Don Bettale**, Driller **G. L. Long** ~~XXXXXXXXXXXX~~ Drilling Foreman

**FORMATION RECORD**

FROM—	TO—	TOTAL FEET	FORMATION
0	560	560	Grey shale
560	700	140	Sandstone & shale
700	1070	370	Grey shale
1070	1175	105	Limestone & shale
1175	1350	175	Sandstone
1350	2400	1050	Sandstone & shale
2400	4400	2000	Red shale & sandstone
4400	5850	1450	Limestone, sand & red shale
5850	6630	780	Limestone & grey shale
6630	7000	370	Limestone

