

(SUBMIT IN TRIPLICATE)

Land Office Santa FeLease No. 078097Unit Heaton**APPROVED**JUN 14 1961
Richard B. Krahl
RICHARD B. KRAHL
Geological SurveyUNITED STATES
DEPARTMENT OF THE INTERIOR
GEOLOGICAL SURVEY

SUNDRY NOTICES AND REPORTS ON WELLS

NOTICE OF INTENTION TO DRILL.....	<input checked="" type="checkbox"/>	SUBSEQUENT REPORT OF WATER SHUT-OFF.....	
NOTICE OF INTENTION TO CHANGE PLANS.....		SUBSEQUENT REPORT OF SHOOTING OR ACIDIZING.....	
NOTICE OF INTENTION TO TEST WATER SHUT-OFF.....		SUBSEQUENT REPORT OF ALTERING CASING.....	
NOTICE OF INTENTION TO RE-DRILL OR REPAIR WELL.....		SUBSEQUENT REPORT OF RE-DRILLING OR REPAIR.....	
NOTICE OF INTENTION TO SHOOT OR ACIDIZE.....		SUBSEQUENT REPORT OF ABANDONMENT.....	
NOTICE OF INTENTION TO PULL OR ALTER CASING.....		SUPPLEMENTARY WELL HISTORY.....	
NOTICE OF INTENTION TO ABANDON WELL.....			

(INDICATE ABOVE BY CHECK MARK NATURE OF REPORT, NOTICE, OR OTHER DATA)

June 13, 1961

Well No. 16 is located 1343 ft. from N line and 1050 ft. from E line of sec. 28SW/4 Sec. 28
(1/4 Sec. and Sec. No.)3rd
(Twp.)13th
(Range)T14N R13E
(Meridian)Basin Dakota
(Field)San Juan
(County or Subdivision)New Mexico
(State or Territory)

The elevation of the derrick floor above sea level is 5921 ft.

DETAILS OF WORK

(State names of and expected depths to objective sands; show sizes, weights, and lengths of proposed casings; indicate mudding jobs, cementing points, and all other important proposed work)

It is intended to drill a well with rotary tools thru the Dakota formation. Mud circulation will be used thru 100' of Lewis & set 7 5/8" intermediate casing. Gas circulation will be used thru the Middle of the Greenhorn & set 5 1/2" intermediate casing. Gas circulation will be used thru the Dakota formation & 4" production liner will be set. Possible productive intervals in the Dakota formation will be perforated & fractured. Est. T. D. 7209'.

Casing Program:

- 10 3/4" casing set at 280' with 310 sacks cement - 200% to circulate
- 7 5/8" casing set at 2650' with 160 sacks cement - 150% to circulate
- 5 1/2" casing set at 6829' with 500 sacks cement - 200% to fill to 7 5/8" casing shoe.
- 4" casing set at 7209' with 50 sacks cement - 400% to cover liner top.

The W/2 of Section 28 is dedicated to this well.

I understand that this plan of work must receive approval in writing by the Geological Survey before operations may be commenced.

Company El Paso Natural Gas CompanyAddress Box 990Farmington, New Mexico

By

Original Signed D. W. Meekins
NATION-WIDE
OPERATOR'S SIGNATURETitle Petroleum Engineer

NEW MEXICO OIL CONSERVATION COMMISSION

Well Location and Average Determination Plan

Section A.

Date **JUNE 7, 1961**

Operator **EL PASO NATURAL GAS COMPANY** Lease **HEATON** SF **078097**
 Well No. **16** Unit Letter **L** Section **28** Township **31-N** Range **11-W** NMPM
 Located **1843** Feet From **SOUTH** Line **1056** Feet From **WEST** Line
 County **SAN JUAN** G. T. Location **5911** Distance Average **320** Acres
 Name of Producing Formation **DAKOTA** Pool **BASIN DAKOTA**

1. Is the Operator the only owner of the land on which the well is located?
 Yes ☒ No ☐
2. If the answer to question 1 is "No," have the interests of all the owners been conclusively demonstrated by a written agreement or otherwise? Yes ☐ No ☐ If answered "No," Page of Certificate
3. If the answer to question 2 is "No," have all the owners and their respective interests to the
 Owner _____ Land Description _____

RECEIVED

JUN 11 1961

U. S. GEOLOGICAL SURVEY
FARMINGTON, NEW MEXICO

Section B.

Note: All distances must be from outer boundaries of Section.

This is to certify that the information
 in Section A above is true and complete
 to the best of my knowledge and belief.

El Paso Natural Gas Company

(Operator)

Original Signed D. W. Meehan

(Representative)

Box 190

(Address)

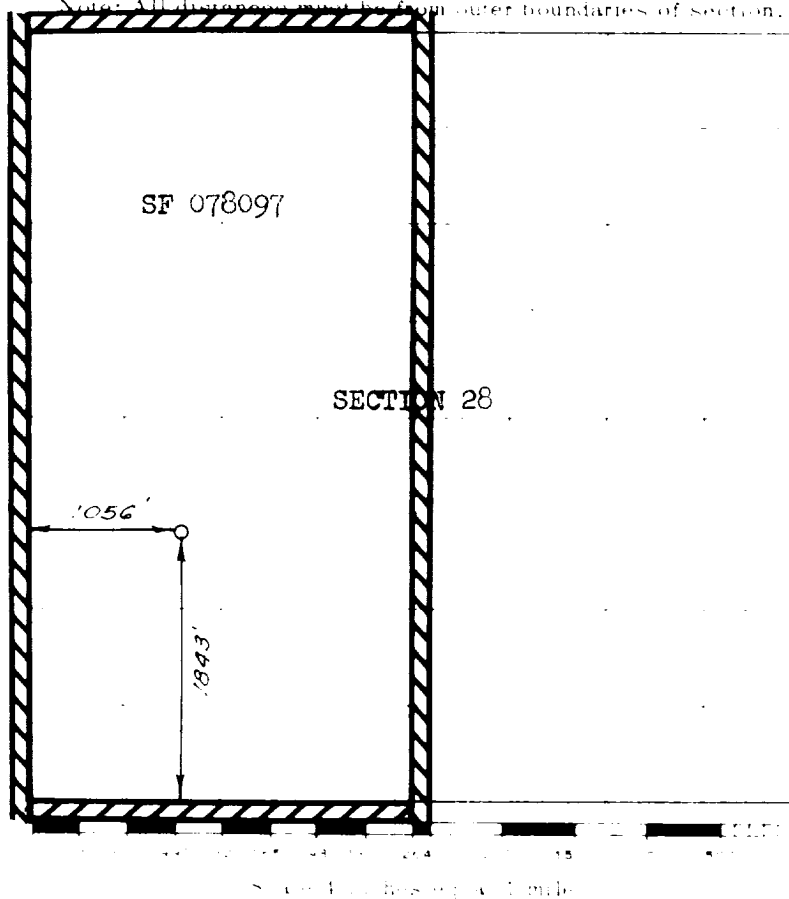
Farmington, New Mexico

This plan was prepared from field notes of actual survey made by me or by a person under my supervision and that the same are true and correct to the best of my knowledge and belief.

(Seal)

Date Signed **JUNE 1, 1961**

David O. Nielsen
 Registered Professional Engineer and/or Land Surveyor

Farmington, New Mexico