

(SUBMIT IN TRIPLICATE)

Indian Agency Ute Mountain Tribal

UNITED STATES
DEPARTMENT OF THE INTERIOR
GEOLOGICAL SURVEY

Allottee _____

Lease No. 11-20-604-122

Sec. 29

SUNDRY NOTICES AND REPORTS ON WELLS

NOTICE OF INTENTION TO DRILL	<input checked="" type="checkbox"/>	SUBSEQUENT REPORT OF WATER SHUT-OFF	RECEIVED MAY 19 1960 U. S. GEOLOGICAL SURVEY DURANGO, COLO.
NOTICE OF INTENTION TO CHANGE PLANS	<input type="checkbox"/>	SUBSEQUENT REPORT OF SHOOTING OR ACIDIZING	
NOTICE OF INTENTION TO TEST WATER SHUT-OFF	<input type="checkbox"/>	SUBSEQUENT REPORT OF ALTERING CASING	
NOTICE OF INTENTION TO REDRILL OR REPAIR WELL	<input type="checkbox"/>	SUBSEQUENT REPORT OF REDRILLING OR REPAIR	
NOTICE OF INTENTION TO SHOOT OR ACIDIZE	<input type="checkbox"/>	SUBSEQUENT REPORT OF ABANDONMENT	
NOTICE OF INTENTION TO PULL OR ALTER CASING	<input type="checkbox"/>	SUPPLEMENTARY WELL HISTORY	
NOTICE OF INTENTION TO ABANDON WELL	<input type="checkbox"/>		

(INDICATE ABOVE BY CHECK MARK NATURE OF REPORT, NOTICE, OR OTHER DATA)

May 17, 1960

Ute Mtn. Tribal 2-29
Well No. 11 is located 2310 ft. from N line and 660 ft. from W line of sec. 29

SW 1/4 of NW 1/4, Sec. 29
(1/4 Sec. and Sec. No.)

31N
(Twp.)

14W
(Range)

N 1/2
(Meridian)

Verde Gallup
(Field)

San Juan County
(County or Subdivision)

New Mexico
(State or Territory)

The elevation of the derrick floor above sea level is _____ ft. Will report later.

DETAILS OF WORK

(State names of and expected depths to objective sands; show sizes, weights, and lengths of proposed casings; indicate mudding jobs, cementing points, and all other important proposed work)

Notice is hereby given of intention to drill the Ute Mtn. Tribal
2-29#11. 8 5/8" casing will be set at approximately 125' and 4 1/2"
casing will be set at approximately 4000'. The pay zone will be drilled
with oil and completed in open hole.

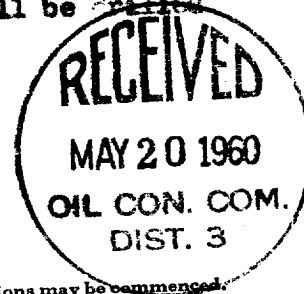

I understand that this plan of work must receive approval in writing by the Geological Survey before operations may be commenced.

Company Standard Oil Co. of Texas

Address Box 1581
Farmington, N.M.

By C. C. Santrop

Title Field Foreman

P
L
H

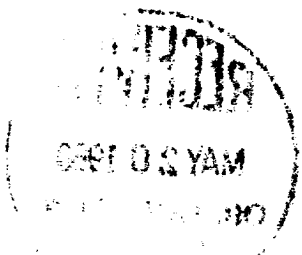

NEW MEXICO OIL CONSERVATION COMMISSION
WELL LOCATION AND ACREAGE DEDICATION PLAT

FORM C-128
Revised 5/1/57

SEE INSTRUCTIONS FOR COMPLETING THIS FORM ON THE REVERSE SIDE

SECTION A

Operator STANDARD OIL COMPANY OF TEXAS		Lease 11-20-60-122		Well No. 11	
Unit Letter E		Section 29		Township 31 NORTH	
Range 14 WEST		County SAN JUAN			
Actual Footage Location of Well: 2310 feet from the NORTH line and 660 feet from the WEST line					
Ground Level Elev. Will report later		Producing Formation Gallup		Pool Verde Gallup	
Dedicated Acreage: 40		Acres			

1. Is the Operator the only owner in the dedicated acreage outlined on the plat below? YES ☒ NO ☐ ("Owner" means the person who has the right to drill into and to produce from any pool and to appropriate the production either for himself or for himself and another. (65-3-29 (e) NMSA 1935 Comp.)
2. If the answer to question one is "no," have the interests of all the owners been consolidated by communization agreement or otherwise? YES ☐ NO ☐ If answer is "yes," Type of Consolidation _____
3. If the answer to question two is "no," list all the owners and their respective interests below:

Owner	Land Description
	MAY 19 1960

U. S. GEOLOGICAL SURVEY
DURANGO, COLO.
CERTIFICATION

I hereby certify that the information in SECTION A above is true and complete to the best of my knowledge and belief.

Name	<i>W. L. Lantry</i>
Position	Field Foreman
Company	Standard Oil Co. of Texas
Date	May 17, 1960

I hereby certify that the well location shown on the plat in SECTION B was plotted from field notes of actual surveys made by me or under my supervision, and that the same is true and correct to the best of my knowledge and belief.

Date Surveyed	13 May 1960
Registered Professional Engineer and/or Land Surveyor	<i>James P. Lease</i> James P. Lease
Certificate No.	1463

SECTION B

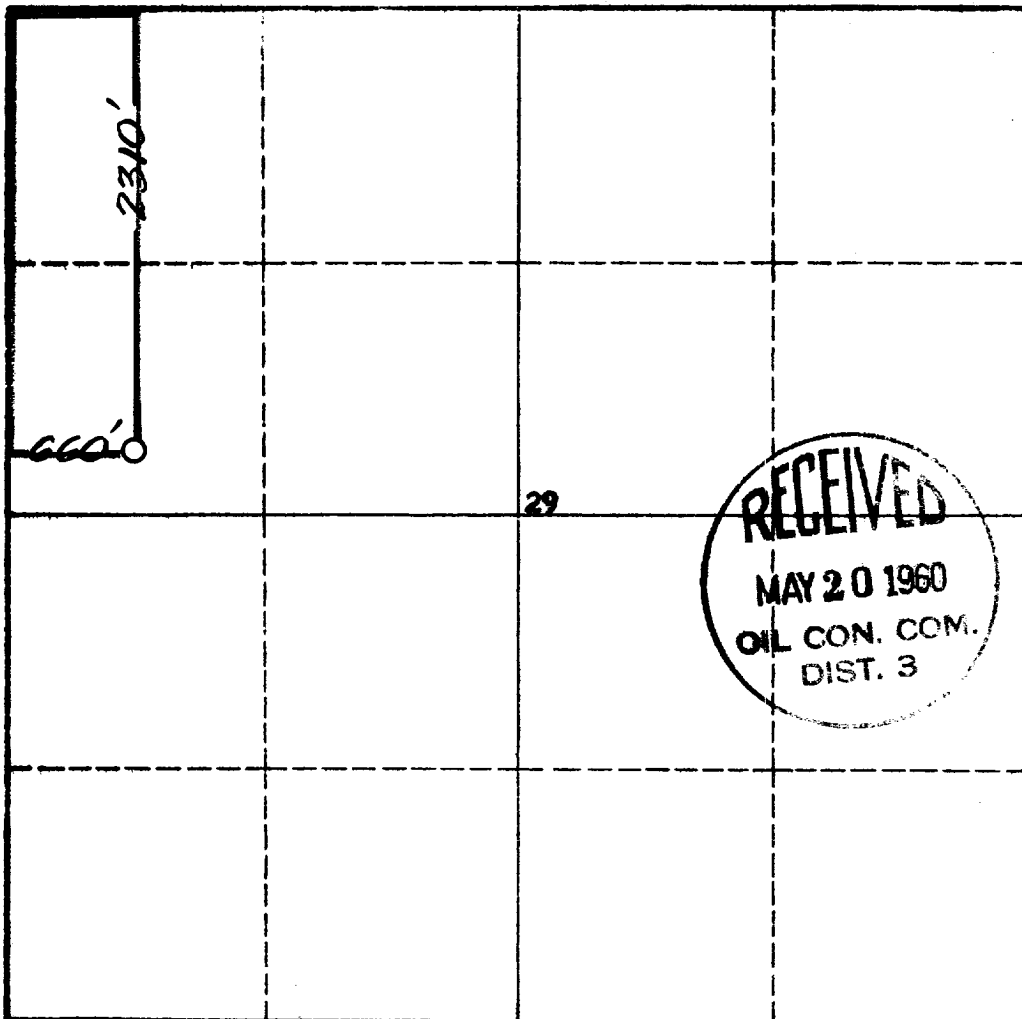

0 330 660 990 1320 1650 1980 2310 2640 2000 1500 1000 500 0

INSTRUCTIONS FOR COMPLETION OF FORM C-128

1. Operator shall furnish and certify to the information called for in Section A.
2. Operator shall outline the dedicated acreage for *both* oil and gas wells on the plat in Section B.
3. A registered professional engineer or land surveyor registered in the State of New Mexico or approved by the Commission shall show on the plat the location of the well and certify this information in the space provided.
4. All distances shown on the plat must be from the outer boundaries of the Section.
5. If additional space is needed for listing owners and their respective interests as required in question 3 of Section A, please use space below.