

(SUBMIT IN TRIPLICATE)

Indian Agency Ute Mtn. Tribal

UNITED STATES
DEPARTMENT OF THE INTERIOR
GEOLOGICAL SURVEY

Allottee _____

Lease No. 14-20-604-122

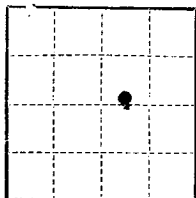

Sec. 29 **SUNDRY NOTICES AND REPORTS ON WELLS**

NOTICE OF INTENTION TO DRILL _____	<input checked="" type="checkbox"/>	SUBSEQUENT REPORT OF WATER SHUT-OFF _____	<div style="text-align: right;">RECEIVED</div> <div style="text-align: center;">MAY 19 1960</div> <div style="text-align: right;">U. S. GEOLOGICAL SURVEY DURANGO, COLO.</div>
NOTICE OF INTENTION TO CHANGE PLANS _____		SUBSEQUENT REPORT OF SHOOTING OR ACIDIZING _____	
NOTICE OF INTENTION TO TEST WATER SHUT-OFF _____		SUBSEQUENT REPORT OF ALTERING CASING _____	
NOTICE OF INTENTION TO REDRILL OR REPAIR WELL _____		SUBSEQUENT REPORT OF REDRILLING OR REPAIR _____	
NOTICE OF INTENTION TO SHOOT OR ACIDIZE _____		SUBSEQUENT REPORT OF ABANDONMENT _____	
NOTICE OF INTENTION TO PULL OR ALTER CASING _____		SUPPLEMENTARY WELL HISTORY _____	
NOTICE OF INTENTION TO ABANDON WELL _____			

(INDICATE ABOVE BY CHECK MARK NATURE OF REPORT, NOTICE, OR OTHER DATA)

_____ May 17, 19 60

Ute Mtn. Tribal 2-29

Well No. 12 is located 2310 ft. from N line and 1980 ft. from E line of sec. 29

SW 1/4 of NE 1/4, Sec. 29 31N 11W N 40° E
(1/4 Sec. and Sec. No.) (Twp.) (Range) (Meridian)

Verde Collup San Juan County New Mexico
(Field) (County or Subdivision) (State or Territory)

The elevation of the derrick floor above sea level is _____ ft. Will report later.

DETAILS OF WORK

(State names of and expected depths to objective sands; show sizes, weights, and lengths of proposed casings; indicate mudding jobs, cementing points, and all other important proposed work)

Notice is hereby given of intention to drill the Ute Mtn. Tribal
2-29#12. 9 5/8" casing will be set at approximately 125' and 4 1/2"
casing will be set at approximately 1000'. The pay zone will be drilled
with oil and completed in open hole.

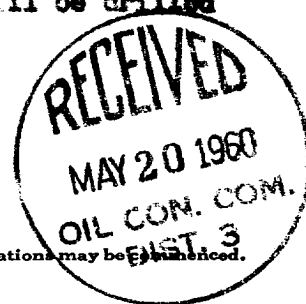

I understand that this plan of work must receive approval in writing by the Geological Survey before operations may be commenced.

Company Standard Oil Co. of Texas

Address Box 1591

Farrington, N.M.

By [Signature]

Title Field Foreman

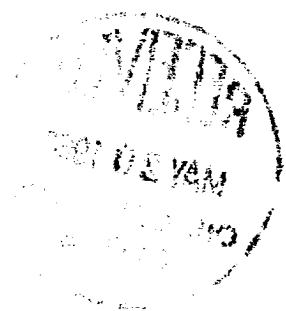

NEW MEXICO OIL CONSERVATION COMMISSION
WELL LOCATION AND ACREAGE DEDICATION PLAT

FORM C-128
Revised 5/1/57

SEE INSTRUCTIONS FOR COMPLETING THIS FORM ON THE REVERSE SIDE

SECTION A

Operator STANDARD OIL COMPANY OF TEXAS		Lease 11-20-604-122 UTE MOUNTAIN TRIBAL 2 - 29		Well No. 12
Unit Letter G	Section 29	Township 31 NORTH	Range 14 WEST	County SAN JUAN
Actual Footage Location of Well: 2310 feet from the NORTH line and 1980 feet from the EAST line				
Ground Level Elev. Will report later	Producing Formation Gallup	Pool Verde Gallup	Dedicated Acreage: 1.0 Acres	

1. Is the Operator the only owner in the dedicated acreage outlined on the plat below? YES X NO ____ . ("Owner" means the person who has the right to drill into and to produce from any pool and to appropriate the production either for himself or for himself and another. (65-3-29 (e) NMSA 1935 Comp.)

2. If the answer to question one is "no," have the interests of all the owners been consolidated by communitization agreement or otherwise? YES ____ NO ____ . If answer is "yes," Type of Consolidation ____

3. If the answer to question two is "no," list all the owners and their respective interests below:

Owner	Land Description

RECEIVED

MAY 19 1960

U. S. GEOLOGICAL SURVEY
CERTIFICATION

SECTION B

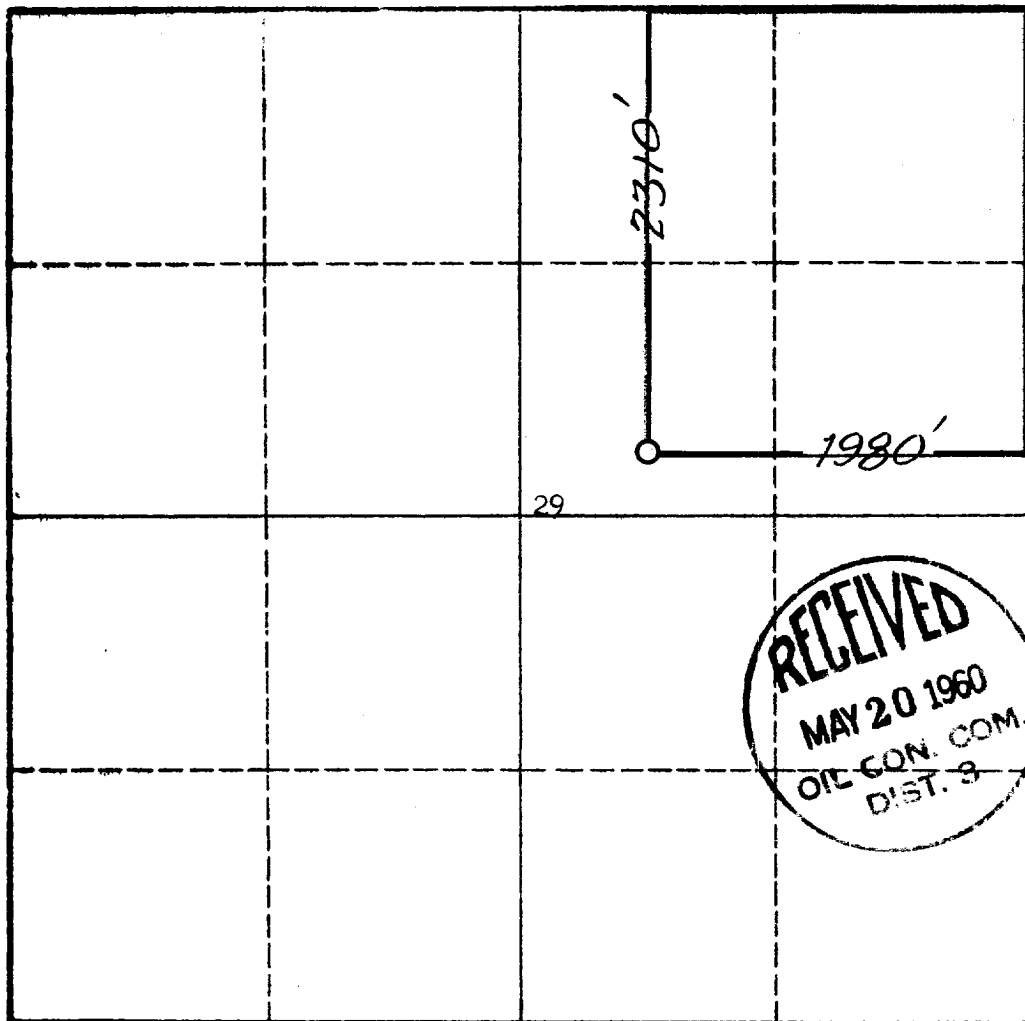

I hereby certify that the information in SECTION A above is true and complete to the best of my knowledge and belief.

Name	<u>Oil Company</u>
Position	<u>Field Foreman</u>
Company	<u>Standard Oil Co. of Texas</u>
Date	<u>May 17, 1960</u>

I hereby certify that the well location shown on the plat in SECTION B was plotted from field notes of actual surveys made by me or under my supervision, and that the same is true and correct to the best of my knowledge and belief.

Date Surveyed	<u>13 May 1960</u>
Registered Professional Engineer and/or Land Surveyor	<u>James P. Leese</u>
Certificate No.	<u>1463</u>

RECEIVED
MAY 20 1960
OIL CON. COM.
DIST. 3

0 330 660 990 1320 1650 1980 2310 2640 2000 1500 1000 500 0

INSTRUCTIONS FOR COMPLETION OF FORM C-128

1. Operator shall furnish and certify to the information called for in Section A.
2. Operator shall outline the dedicated acreage for *both* oil and gas wells on the plat in Section B.
3. A registered professional engineer or land surveyor registered in the State of New Mexico or approved by the Commission shall show on the plat the location of the well and certify this information in the space provided.
4. All distances shown on the plat must be from the outer boundaries of the Section.
5. If additional space is needed for listing owners and their respective interests as required in question 3 of Section A, please use space below.