

(SUBMIT IN TRIPLICATE)

UNITED STATES
DEPARTMENT OF THE INTERIOR
GEOLOGICAL SURVEY

Indian Agency Ute Mountain Tribal
Allottee _____
Lease No. 14-20-604-86

SUNDRY NOTICES AND REPORTS ON WELLS

NOTICE OF INTENTION TO DRILL	* SUBSEQUENT REPORT OF WATER SHUT-OFF	RECEIVED APR 12 1960 U. S. GEOLOGICAL SURVEY DURANGO, COLO.
NOTICE OF INTENTION TO CHANGE PLANS	SUBSEQUENT REPORT OF SHOOTING OR ACIDIZING	
NOTICE OF INTENTION TO TEST WATER SHUT-OFF	SUBSEQUENT REPORT OF ALTERING CASING	
NOTICE OF INTENTION TO REDRILL OR REPAIR WELL	SUBSEQUENT REPORT OF REDRILLING OR REPAIR	
NOTICE OF INTENTION TO SHOOT OR ACIDIZE	SUBSEQUENT REPORT OF ABANDONMENT	
NOTICE OF INTENTION TO PULL OR ALTER CASING	SUPPLEMENTARY WELL HISTORY	
NOTICE OF INTENTION TO ABANDON WELL		

(INDICATE ABOVE BY CHECK MARK NATURE OF REPORT, NOTICE, OR OTHER DATA)

April 11, 1960

Well No. 10 is located 660 ft. from N line and 1840 from E line of sec. 31
NE NE Sec. 31 T31N R14W 10TH
(1/4 Sec. and Sec. No.) (Twp.) (Range) (Meridian)
Verde Gallup San Juan New Mexico
(Field) (County or Subdivision) (State or Territory)

The elevation of the derrick floor above sea level is 5549

DETAILS OF WORK

(State names of and expected depths to objective sands; show sizes, weights, and lengths of proposed casings; indicate mudding jobs, cementing points, and all other important proposed work)

Drill well w/Rotary Tools to estimated depth of 4800'.
Sand-oil Frac the Gallup Pay Section.

Casing Program:

- 8-5/8" O.D. 125' w/100 sacks cement circulated to surface.
- 5-1/2" O.D. 4645' w/D.V. Tool set below Point Lockout and two sacks cement w/50 sacks below and 125 sacks above tool.
- 4-1/2" O.D. liner set in open hole.

The NE NE Sec. 31 is dedicated to this well.

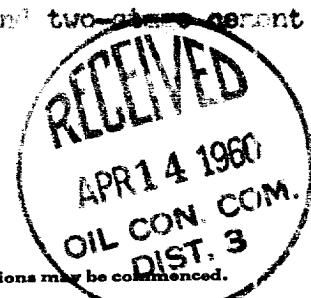

I understand that this plan of work must receive approval in writing by the Geological Survey before operations may be commenced.

Company THREE STATES NATURAL GAS COMPANY

Address P. O. Box 67

Farmington, New Mexico

By Original Signed By John Carothers

Title Assistant District Supt.

PL
L

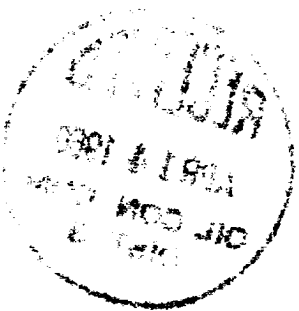

NEW MEXICO OIL CONSERVATION COMMISSION

Well Location and Acreage Dedication Plat

Section A.

Date April 11, 1960

Operator Three States Natural Gas Company Lease Tribal
Well No. 10 Unit Letter B Section 31 Township 31 North Range 14 West NMPM
Located 660 Feet From North Line, 1810 Feet From East Line
County San Juan G. L. Elevation 5506 Dedicated Acreage 40 Acres
Name of Producing Formation Gallup Pool Verde Gallup

1. Is the Operator the only owner* in the dedicated acreage outlined on the plat below?
Yes X No _____.
2. If the answer to question one is "no," have the interests of all the owners been consolidated by communitization agreement or otherwise? Yes _____ No _____. If answer is "yes,"
Type of Consolidation _____
3. If the answer to question two is "no," list all the owners and their respective interests below:

Owner

Land Description

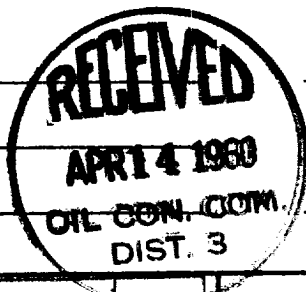

RECEIVED

APR 12 1960

Section. B

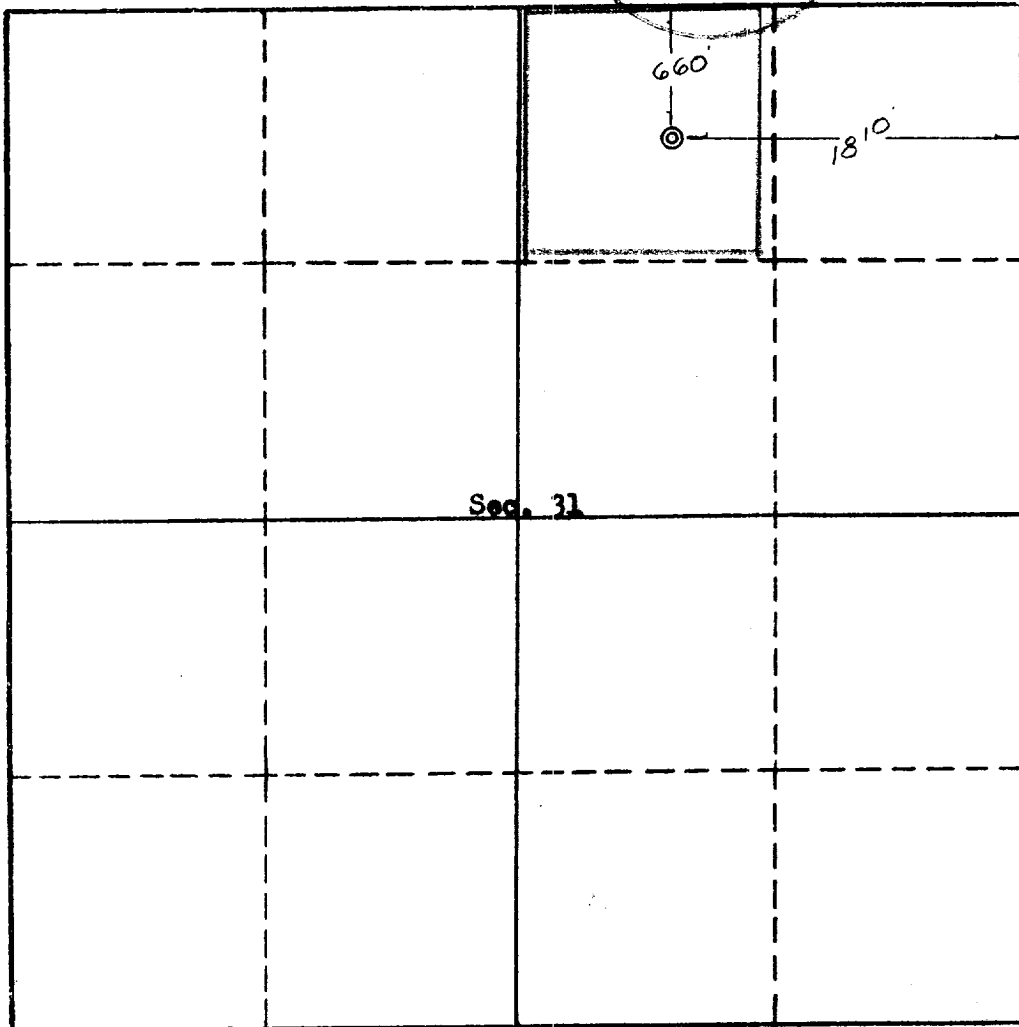

U. S. GEOLOGICAL SURVEY
DURANGO, COLO.

This is to certify that the information in Section A above is true and complete to the best of my knowledge and belief.

THREE STATES NATURAL GAS CO.

(Operator)

John Caruth
(Representative)
P. O. Box 67
Farmington, New Mexico
Address

This is to certify that the well location shown on the plat in Section B was derived from field notes and actual survey made by me or under my supervision and that the same is true and correct to the best of my knowledge and belief.

Date Surveyed Jan. 5, 1960

Ernest V. Echohawk
Ernest V. Echohawk
Registered Land Surveyor.

Certificate No. 1545

