**APPROVED**

SUBMIT IN TRIPLICATE

SEP 4 1960 UNITED STATES
DEPARTMENT OF THE INTERIOR
JERRY W. LONG GEOLOGICAL SURVEY

Indian Agency _____

14-00-604-1908

Allottee _____

Lease No. _____

SUNDRY NOTICES AND REPORTS ON

RECEIVED
SEP 2 1960
U.S. GEOLOGICAL SURVEY
DURANGO, COLO.

NOTICE OF INTENTION TO DRILL	<input checked="" type="checkbox"/>	SUBSEQUENT REPORT OF WATER SHUT-OFF
NOTICE OF INTENTION TO CHANGE PLANS	<input type="checkbox"/>	SUBSEQUENT REPORT OF SHOOTING OR ACIDIZING
NOTICE OF INTENTION TO TEST WATER SHUT-OFF	<input type="checkbox"/>	SUBSEQUENT REPORT OF ALTERING CASINGS
NOTICE OF INTENTION TO REDRILL OR REPAIR WELL	<input type="checkbox"/>	SUBSEQUENT REPORT OF REDRILLING
NOTICE OF INTENTION TO SHOOT OR ACIDIZE	<input type="checkbox"/>	SUBSEQUENT REPORT OF ABANDONMENT
NOTICE OF INTENTION TO PULL OR ALTER CASING	<input type="checkbox"/>	SUPPLEMENTARY WELL HISTORY
NOTICE OF INTENTION TO ABANDON WELL	<input type="checkbox"/>	

(INDICATE ABOVE BY CHECK MARK NATURE OF REPORT, NOTICE, OR OTHER DATA)

Lease No. 177074

Navajo-Mt. Mountain Tribe "B"

August 30, 1960

Well No. 4 is located 1800 ft. from [S] line and 1900 ft. from [W] line of sec. 21

21/4 Sec. 21
(1/4 Sec. and Sec. No.)
H.S. - Gall Ext.
(Field)T-31-M R-16-M NMPH
(Twp.) (Range) (Meridian)
San Juan New Mexico
(County or Subdivision) (State or Territory)

The elevation of the derrick floor above sea level is 5736 ft.

DETAILS OF WORK

(State names of and expected depths to objective sands; show sizes, weights, and lengths of proposed casings; indicate mudlogging points, and all other important proposed work)

OBJECTIVE FORMATION

Top of Gallup 1615'
Top of Lower Gallup 1735'
Total Depth 1700'

PIPE CASING

7 5/8" New 84'
4 1/2" New 9.54'

CASING PROGRAM (LENGTHS)

Set at Cement
100' 100 SK.
1735' 100 SK.

Note: Drill to total depth and swing pipe just above top of pay. Use packer guide shoe to prevent cement from reaching pay section during cementing operations.

RECEIVED
SEP 7 1960
OIL CON. COM.
DIST. 3

I understand that this plan of work must receive approval in writing by the Geological Survey before operations may be commenced.

Company **TRINACO Inc.****TRINACO Inc.**Address **P. O. Box 3109****Midland, Texas**

By

Title

**J. J. Volten
Division Civil Engineer**

RECEIVED
JAN 10 1962

U.S. AIR FORCE

RECEIVED
JAN 10 1962
OFFICE OF THE
JOINT CHIEFS OF STAFF
WASHINGTON, D.C.

NEW MEXICO OIL CONSERVATION COMMISSION
WELL LOCATION AND ACREAGE DEDICATION PLAT

FORM C-128
 Revised 5/1/57

SEE INSTRUCTIONS FOR COMPLETING THIS FORM ON THE REVERSE SIDE

SECTION A

Operator TEXACO Inc.			Lease Navajo-Ute Mountain Tribe "B"		Well No. 4
Unit Letter K	Section 21	Township 31 North	Range 16 West	County San Juan	
Actual Footage Location of Well: 1880 feet from the South line and 1980 feet from the West line Sec. 21					
Ground Level Elev. 5725	Producing Formation Gallup		Pool Undesignated		Dedicated Acreage: 40 Acres

1. Is the Operator the only owner in the dedicated acreage outlined on the plat below? YES X NO ____ . ("Owner" means the person who has the right to drill into and to produce from any pool and to appropriate the production either for himself or for himself and another. (65-3-29 (e) NMSA 1935 Comp.)
2. If the answer to question one is "no," have the interests of all the owners been consolidated by compact, agreement or otherwise? YES ____ NO ____ . If answer is "yes," Type of Consolidation _____
3. If the answer to question two is "no," list all the owners and their respective interests below _____

Owner	Land Description

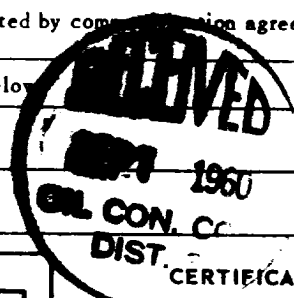

SECTION B

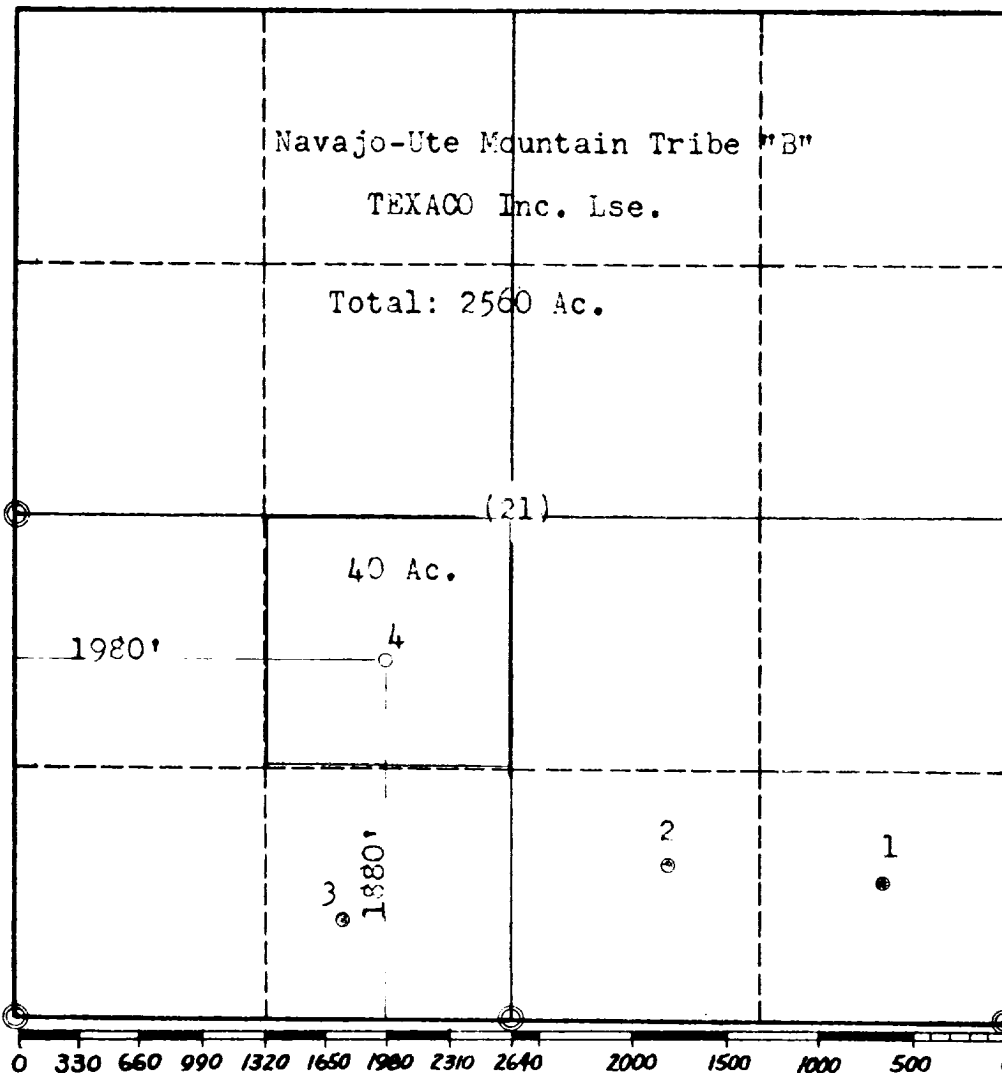

I hereby certify that the information in SECTION A above is true and complete to the best of my knowledge and belief.

Name J. J. Velten
 Position Division Civil Engineer
 Company TEXACO Inc.
 Date 8/29/60

○ Marker

I hereby certify that the well location shown on the plat in SECTION B was plotted from field notes of actual surveys made by me or under my supervision, and that the same is true and correct to the best of my knowledge and belief.

Date Surveyed 8/27/60
 Registered Professional Engineer and/or Land Surveyor J. J. Velten
 Certificate No. 8174