

(SUBMIT IN TRIPLICATE)

Indian Agency Navajo-Ute Tribal

UNITED STATES
DEPARTMENT OF THE INTERIOR
GEOLOGICAL SURVEY

Allottee _____
Lease No. 14-20-604-1951

	X	

SUNDRY NOTICES AND REPORTS ON WELLS

NOTICE OF INTENTION TO DRILL	<input checked="" type="checkbox"/>	SUBSEQUENT REPORT OF WATER SHUT-OFF
NOTICE OF INTENTION TO CHANGE PLANS	<input type="checkbox"/>	SUBSEQUENT REPORT OF SHOOTING OR ACIDIZING
NOTICE OF INTENTION TO TEST WATER SHUT-OFF	<input type="checkbox"/>	SUBSEQUENT REPORT OF ALTERING CASING
NOTICE OF INTENTION TO REDRILL OR REPAIR WELL	<input type="checkbox"/>	SUBSEQUENT REPORT OF REDRILLING OR REPAIR
NOTICE OF INTENTION TO SHOOT OR ACIDIZE	<input type="checkbox"/>	SUBSEQUENT REPORT OF ABANDONMENT
NOTICE OF INTENTION TO PULL OR ALTER CASING	<input type="checkbox"/>	SUPPLEMENTARY WELL HISTORY
NOTICE OF INTENTION TO ABANDON WELL	<input type="checkbox"/>	

RECEIVED
JAN 12 1960
U. S. GEOLOGICAL SURVEY
DURANGO, COLO.

(INDICATE ABOVE BY CHECK MARK NATURE OF REPORT, NOTICE, OR OTHER DATA)

VERBAL APPROVAL RECEIVED FROM USGS

JANUARY 8, 1960.

January 11, 19 60

Horseshoe Ute

Well No. 32 is located 1980 ft. from S line and 2080 ft. from E line of sec. 27

NW SE/4 Section 27

31N

16W

NMPM

(34 Sec. and Sec. No.)

(Twp.)

(Range)

(Meridian)

Horseshoe Gallup Ext.

San Juan

New Mexico

(Field)

(County or Subdivision)

(State or Territory)

The elevation of the derrick floor above sea level is 5484 ft.

DETAILS OF WORK

(State names of and expected depths to objective sands; show sizes, weights, and lengths of proposed casings; indicate mudding jobs, cementing points, and all other important proposed work)

It is intended to drill a well through the Lower-Gallup Formation using rotary tools and mud circulation. Possible Productive intervals will be perforated and sandoil fractured. Estimated Total Depth 1480'.

Casing Program:

9-5/8" at 100' with 100 sacks cement circulated to surface.

5-1/2" at 1480' with 100 sacks cement.

The NW/4 SE/4 of Section 27 is dedicated to this well.

NW/4 SE/4 Section 27 Navajo-Ute Tribal 14-20-604-1951

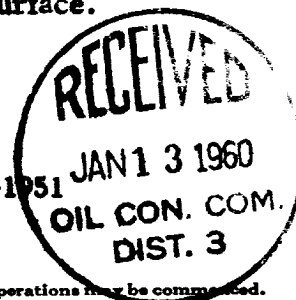

I understand that this plan of work must receive approval in writing by the Geological Survey before operations may be commenced.

Company El Paso Natural Gas Products Company

Address Post Office Box 1565
Farmington, New Mexico

ORIGINAL SIGNED BY: JOSEPH E. KREGER

By _____

Title Petroleum Engineer

RECEIVED
JAN 10 1960
U.S. DEPARTMENT OF AGRICULTURE
WASHINGTON, D.C.

U.S. DEPARTMENT OF AGRICULTURE
WASHINGTON, D.C.

TO: DIRECTOR, AGRICULTURAL RESEARCH SERVICE
FROM: [illegible]
SUBJECT: [illegible]
[illegible text follows]

[illegible text follows]

RECEIVED
JAN 10 1960
U.S. DEPARTMENT OF AGRICULTURE
WASHINGTON, D.C.

RECEIVED
JAN 10 1960
U.S. DEPARTMENT OF AGRICULTURE
WASHINGTON, D.C.

NEW MEXICO OIL CONSERVATION COMMISSION

Well Location and Acreage Dedication Plat

Section A.

Date January 11, 1960
Navajo-Gila Tribal
14-20-694-1951

Operator El Paso Natural Gas Products Company Lease Horseshoe Ditch
Well No. 32 Unit Letter 7 Section 27 Township 31 North Range 16 West NMPN
Located 1960 Feet From South Line, 2080 Feet From East 30.66 Line
County San Juan G. L. Elevation 5477 Dedicated Acreage 11 Acres
Name of Producing Formation Gallop Pool Horseshoe Gallop No. 1

1. Is the operator the only owner* in the dedicated acreage outlined on the plat below?
Yes No
2. If the answer to question one is "no," have the interests of all the owners been consolidated by communitization agreement or otherwise? Yes No . If answer is "yes,"
Type of Consolidation
3. If the answer to question two is "no," list all the owners and their respective interests below:

Owner

Land Description

Section B

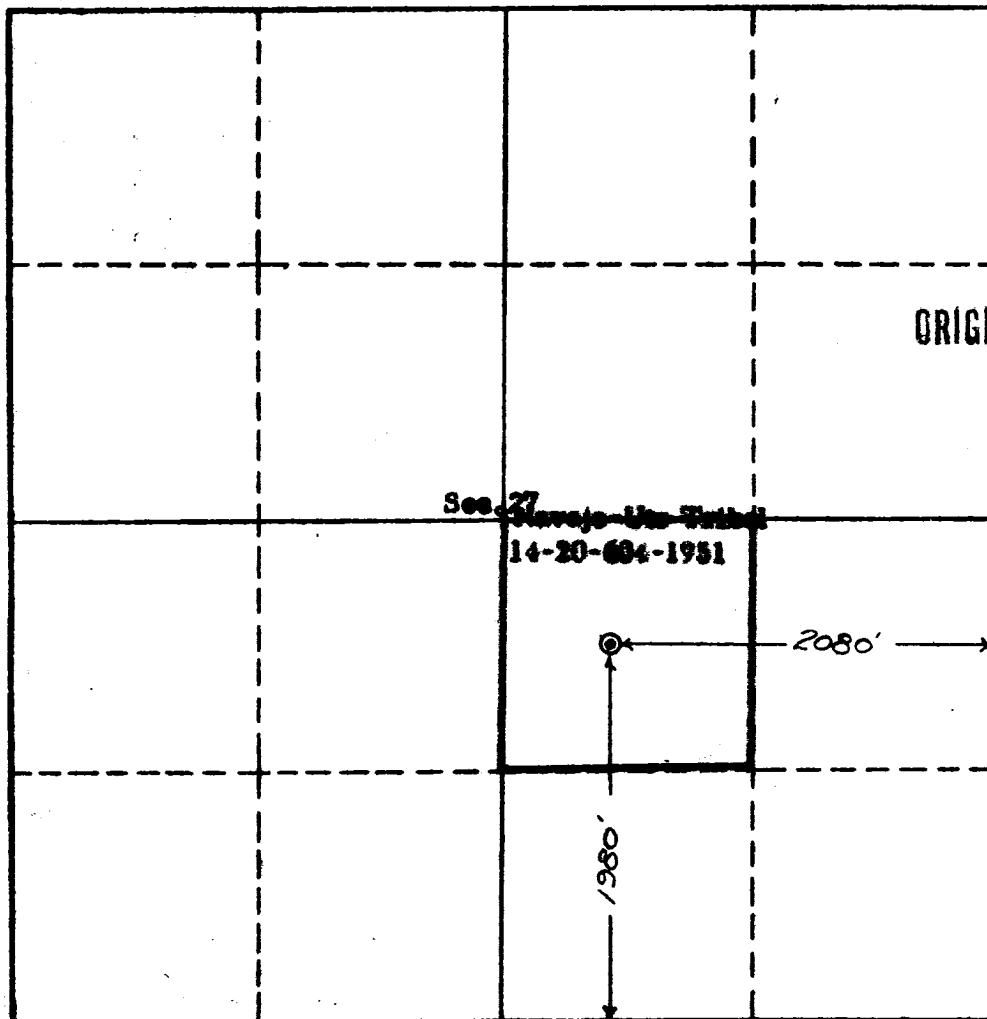

This is to certify that the information in Section A above is true and complete to the best of my knowledge and belief.

El Paso Natural Gas Products Co.

(Operator)
ORIGINAL SIGNED BY: JOSEPH E. KREGER

(Representative)
Box 1565, Farmington, New Mexico

Address

This is to certify that the well location shown on the plat in Section B was plotted from the data of a recent survey made by me and under my supervision and that the same is true to the best of my knowledge and belief.

Date Surveyed Jan. 8, 1960

Ernest V. Echshaw
Ernest V. Echshaw
Registered Land Surveyor.

Certificate No. 1545