

Form 10-1b
(April 1962)

APPROVED

MAR 22 1960

KERRY W. LONG
DISTRICT ENGINEER

(SUBMIT IN TRIPLICATE)

UNITED STATES
DEPARTMENT OF THE INTERIOR
GEOLOGICAL SURVEY

Budget Bureau No. 42-R359.4.
Approval expires 12-31-60.

Indian Agency Navajo-Ute Tribal

Allottee _____

Lease No. 14-20-604-1951

SUNDRY NOTICES AND REPORTS ON WELLS

RECEIVED

NOTICE OF INTENTION TO DRILL	<input checked="" type="checkbox"/>	SUBSEQUENT REPORT OF WATER SHUT-OFF	MAR 23 1960
NOTICE OF INTENTION TO CHANGE PLANS	<input type="checkbox"/>	SUBSEQUENT REPORT OF SHOOTING OR ACIDIZING	
NOTICE OF INTENTION TO TEST WATER SHUT-OFF	<input type="checkbox"/>	SUBSEQUENT REPORT OF ALTERING CASING	U. S. GEOLOGICAL SURVEY
NOTICE OF INTENTION TO REDRILL OR REPAIR WELL	<input type="checkbox"/>	SUBSEQUENT REPORT OF REDRILLING OR REPAIR	DIRANGO, COLO.
NOTICE OF INTENTION TO SHOOT OR ACIDIZE	<input type="checkbox"/>	SUBSEQUENT REPORT OF ABANDONMENT	
NOTICE OF INTENTION TO PULL OR ALTER CASING	<input type="checkbox"/>	SUPPLEMENTARY WELL HISTORY	
NOTICE OF INTENTION TO ABANDON WELL	<input type="checkbox"/>		

(INDICATE ABOVE BY CHECK MARK NATURE OF REPORT, NOTICE, OR OTHER DATA)

VERBAL APPROVAL REC. USGS MARCH 23, 1960.

March 23, 19 60

Horseshoe Ute

Well No. 42 is located 1940 ft. from [N] line and 1960 ft. from [E] line of sec. 27

SW/4 NE/4 Section 27

(1/4 Sec. and Sec. No.)

31N

(Twp.)

16W

(Range)

NMPM

(Meridian)

Horseshoe Gallup

(Field)

San Juan

(County or Subdivision)

New Mexico

(State or Territory)

The elevation of the derrick floor above sea level is 5516 ft.

DETAILS OF WORK

(State names of and expected depths to objective sands; show sizes, weights, and lengths of proposed casings; indicate mudding jobs, cementing points, and all other important proposed work)

It is intended to drill a well through the Lower Gallup Formation using rotary tools and mud circulation. Possible productive intervals will be perforated and sandoil fractured. Estimated Total Depth 1536'.

Casing Program:

9-5/8" at 100' with 100 sacks cement circulated to surface.

5-1/2" at 1536' with 100 sacks cement.

The SW/4 NE/4 of Section 27 is dedicated to this well.

SW/4 NE/4 Section 27 Navajo-Ute Tribal 14-20-604-1951



I understand that this plan of work must receive approval in writing by the Geological Survey before operations may be commenced.

Company El Paso Natural Gas Products Company

Address Post Office Box 1565
Farmington, New Mexico

ORIGINAL SIGNED BY: VAN E. DYKES

Title Petroleum Engineer

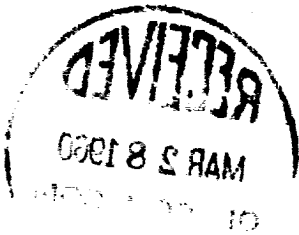
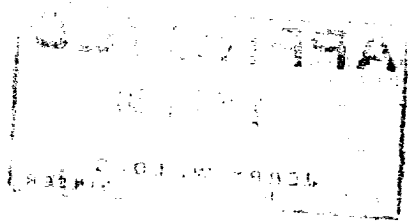

ORIGINAL SIGNED BY: VAN E. DYKES

NEW MEXICO OIL CONSERVATION COMMISSION

Well Location and Acreage Dedication Plat

Section A.

Date March 28, 1960

Operator El Paso Natural Gas Products Company Lease Navajo-Ute
Well No. 42 Unit Letter 0 Section 27 Township 31 North Range 15 West NMPN
Located 1940 Feet From North Line, 1960 Feet From East Line
County San Juan G. L. Elevation 9909 Dedicated Acreage 25.52 Acres
Name of Producing Formation Gallup Pool Navajo-Ute

1. Is the Operator the only owner* in the dedicated acreage outlined on the plat below?
Yes X No _____
2. If the answer to question one is "no," have the interests of all the owners been consolidated by communitization agreement or otherwise? Yes _____ No _____. If answer is "yes,"
Type of Consolidation _____
3. If the answer to question two is "no," list all the owners and their respective interests below:

Owner

Land Description GEOLOGICAL SURVEY
RANGE 30, COLO.

RECEIVED

MAR 28 1960

OIL CON. COM.

Section B

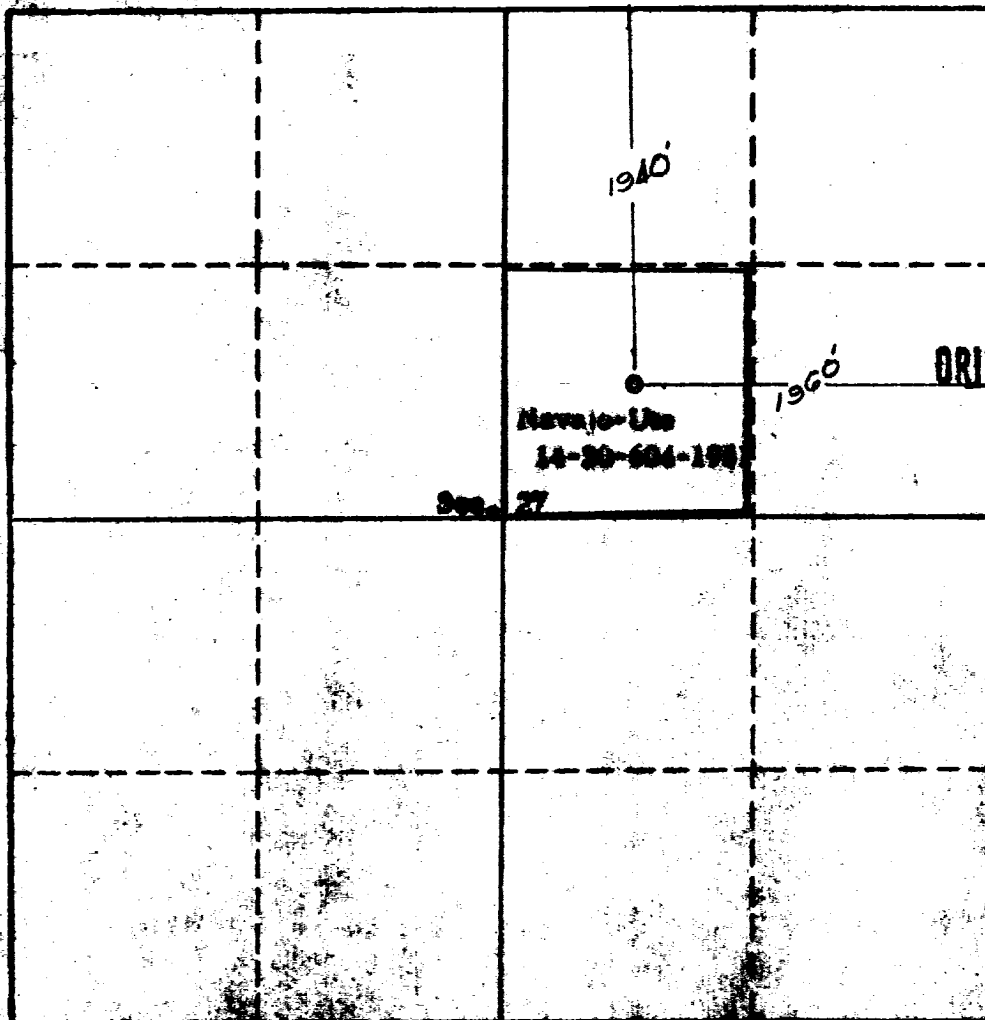

This is to certify that the information in Section A above is true and complete to the best of my knowledge and belief.

El Paso Natural Gas Products Co.
(Operator)

ORIGINAL SIGNED BY: VAN E. DYKES
(Representative)

Box 1545, Farmington, New Mexico
Address

This is to certify that the well location and acreage plat above is true and complete to the best of my knowledge and belief.

Date Surveyed March 15, 1960

Ernest V. Echols
Ernest V. Echols
Registered Land Surveyor.

Certificate No. 1545

