

(SUBMIT IN TRIPLICATE)

UNITED STATES
DEPARTMENT OF THE INTERIOR
GEOLOGICAL SURVEY

Budget Bureau No. 42-R359.4.
Approval expires 12-31-60.

Indian Agency Navajo Tribal
Center 14-20-003-2022
Allottee Trust #140
Lease No. Navajo "A"

SUNDRY NOTICES AND REPORTS ON WELLS

NOTICE OF INTENTION TO DRILL	<input checked="" type="checkbox"/>	SUBSEQUENT REPORT OF WATER SHUT-OFF	<div style="text-align: center;"> RECEIVED AUG 10 1960 U. S. GEOLOGICAL SURVEY FARMINGTON, NEW MEXICO </div>
NOTICE OF INTENTION TO CHANGE PLANS		SUBSEQUENT REPORT OF SHOOTING OR ACIDIZING	
NOTICE OF INTENTION TO TEST WATER SHUT-OFF		SUBSEQUENT REPORT OF ALTERING CASING	
NOTICE OF INTENTION TO REDRILL OR REPAIR WELL		SUBSEQUENT REPORT OF REDRILLING OR REPAIR	
NOTICE OF INTENTION TO SHOOT OR ACIDIZE		SUBSEQUENT REPORT OF ABANDONMENT	
NOTICE OF INTENTION TO PULL OR ALTER CASING		SUPPLEMENTARY WELL HISTORY	
NOTICE OF INTENTION TO ABANDON WELL			

(INDICATE ABOVE BY CHECK MARK NATURE OF REPORT, NOTICE, OR OTHER DATA)

August 8, 1960

Well No. 22 is located 1630 ft. from N line and 1025 ft. from W line of sec. 14
N 1/4 Sec. 14 31N 17W NM 24N
(1/4 Sec. and Sec. No.) (Twp.) (Range) (Meridian)
Hermashee Gallup San Juan New Mexico
(Field) (County or Subdivision) (State or Territory)

The elevation of the 6.4 ~~down-hole~~ above sea level is 9030 ft. (Est.)

DETAILS OF WORK

(State names of and expected depths to objective sands; show sizes, weights, and lengths of proposed casings; indicate mudding jobs, cementing points, and all other important proposed work)

Propose to drill the above well to a total depth of approximately 1125'. We expect to test the Gallup formation at 1030', and any other zones that appear productive of oil or gas.

Casing program: 120' of 8-5/8" casing
1125' of 5-1/2" casing

We propose to sand-oil frac with 20,000 gals. & 40,000#.



I understand that this plan of work must receive approval in writing by the Geological Survey before operations may be commenced.

Company Security Mobil Oil Company, Inc.

Address P. O. Box 3371

Durango, Colorado

By P. M. Barry
P. M. Barry

Title Dist. Prod. Supt.

NEW MEXICO OIL CONSERVATION COMMISSION

WELL LOCATION AND ACREAGE DEDICATION PLAT

FORM C-128
Revised 5/1/57

SEE INSTRUCTIONS FOR COMPLETING THIS FORM ON THE REVERSE SIDE

SECTION A

Operator SOCONY MOBIL OIL COMPANY, INC.			Lease Navajo (A)		Well No. 22
Unit Letter F	Section 14	Township 31N	Range 17W	County San Juan	
Actual Postage Location of Well: 1650 feet from the North line and 1820 feet from the West line					
Ground Level Elev. 5390	Producing Formation Lower Gallup		Pool Horseshoe Gallup		Dedicated Acreage: 40 Acres

1. Is the Operator the only owner in the dedicated acreage outlined on the plat below? YES ☒ NO ☐ ("Owner" means the person who has the right to drill into and to produce from any pool and to appropriate the production either for himself or for himself and another. (69-3-29 (e) NMSA 1935 Comp.)
2. If the answer to question one is "no," have the interests of all the owners been consolidated by communitization agreement or otherwise? YES ☐ NO ☐ If answer is "yes," Type of Consolidation _____
3. If the answer to question two is "no," list all the owners and their respective interests below:

Owner	Land Description

SECTION B

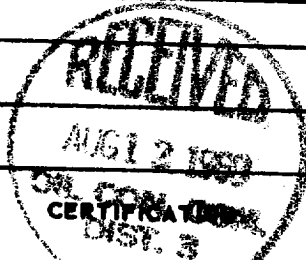
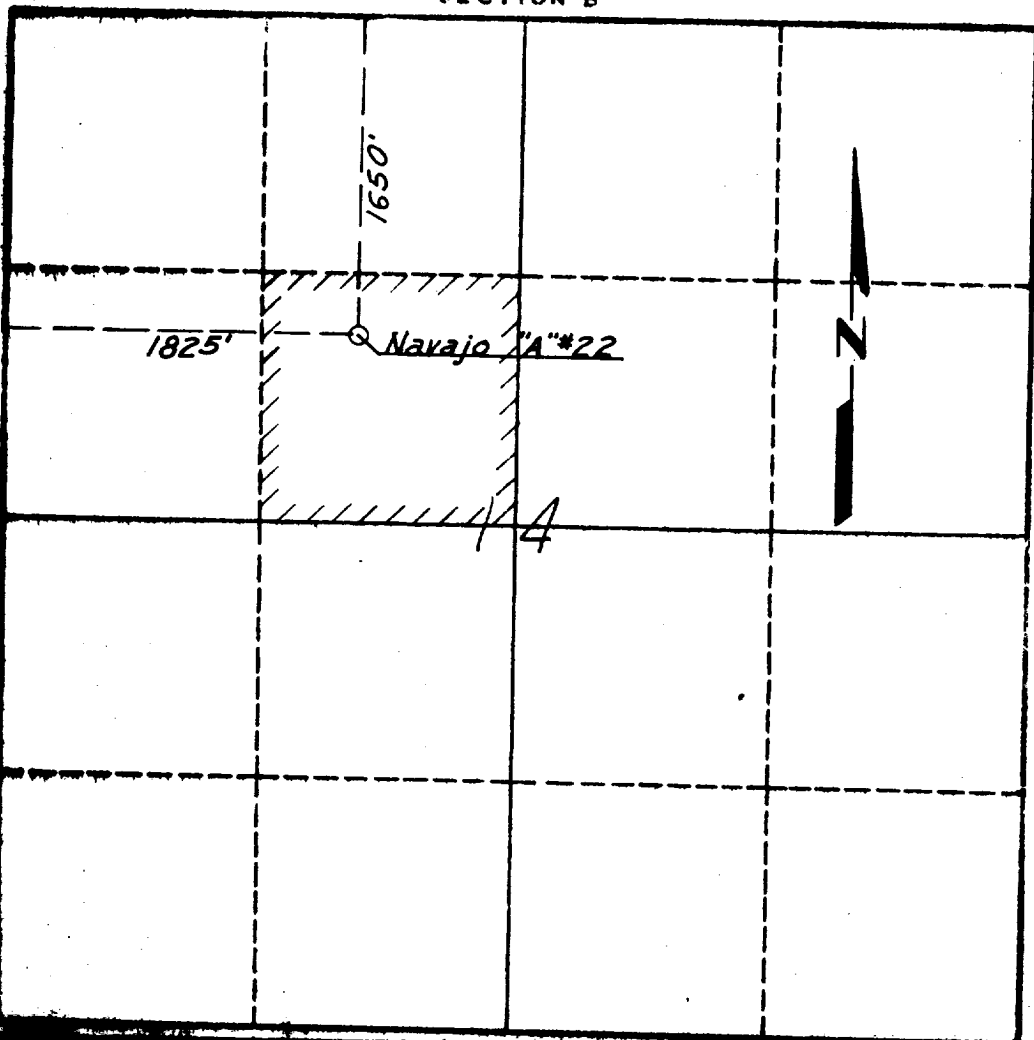

I hereby certify that the information in SECTION A above is true and complete to the best of my knowledge and belief.

Name P. M. Barry
 P. M. Barry
 Position
 Dist. Prod. Supt.
 Company
 Socony Mobil Oil Co., Inc.
 Date
 8/8/60

I hereby certify that the well location shown on the plat in SECTION B was plotted from field notes of actual surveys made by me or under my supervision, and that the same is true and correct to the best of my knowledge and belief.

Date Surveyed
 7/21/60
 Registered Professional Engineer
 and/or Land Surveyor
Reynold L. Roberts
 Certificate No.
 LS 3330

0 500 1000 1500 2000 2500 3000 3500 4000 4500 5000 5500 6000 6500 7000 7500 8000 8500 9000 9500 10000