

(SUBMIT IN TRIPLICATE)

Indian Agency **Consolidated**

Allothee **Ute**

Lease No. **14-20-604-83**

Ute Mountain

APPROVED
22
JUL 16 1961
JERRY W. LONG
DISTRICT ENGINEER

UNITED STATES
DEPARTMENT OF THE INTERIOR
GEOLOGICAL SURVEY

SUNDRY NOTICES AND REPORTS ON WELLS

RECEIVED
JUL 15 1961
U. S. GEOLOGICAL SURVEY

NOTICE OF INTENTION TO DRILL	<input checked="" type="checkbox"/>	SUBSEQUENT REPORT OF WATER SHUT-OFF	
NOTICE OF INTENTION TO CHANGE PLANS		SUBSEQUENT REPORT OF SHOOTING OR ACIDIZING	
NOTICE OF INTENTION TO TEST WATER SHUT-OFF		SUBSEQUENT REPORT OF ALTERING CASING	
NOTICE OF INTENTION TO REDRILL OR REPAIR WELL		SUBSEQUENT REPORT OF REDRILLING OR REPAIR	
NOTICE OF INTENTION TO SHOOT OR ACIDIZE		SUBSEQUENT REPORT OF ABANDONMENT	
NOTICE OF INTENTION TO PULL OR ALTER CASING		SUPPLEMENTARY WELL HISTORY	
NOTICE OF INTENTION TO ABANDON WELL			

(INDICATE ABOVE BY CHECK MARK NATURE OF REPORT, NOTICE, OR OTHER DATA)

July 14, 1961

Well No. **14** is located **660** ft. from **N** line and **1690** ft. from **W** line of sec. **22**
NW/4 Sec. 22 31N 14W NMPM
(1/4 Sec. and Sec. No.) (Twp.) (Range) (Meridian)
Verde Gallup **San Juan** **New Mexico**
(Field) (County or Subdivision) (State or Territory)

The elevation of the derrick floor above sea level is **5669** ft.

DETAILS OF WORK

(State names of and expected depths to objective sands; show sizes, weights, and lengths of proposed casings; indicate mudding jobs, cementing points, and all other important proposed work)

1. Drill 12-1/4" hole to $\pm 105'$ & cement 8-5/8" csg. w/80 sax. Circulate returns to surface. W.O.C. for 18 hrs. & press. test 8-5/8" csg. w/600 psi for 30 mins.
2. Drill 7-7/8" hole to 2630 & cement 5-1/2" csg. w/250 sax. W.O.C. for 18 hrs. & press. test w/1000 psi for 30 min. Drill 2' of 4-7/8" hole, ball dry, & let stand for 1 hr. for test of H2O.
3. Drill 4-7/8" hole to 2780' T.D.
4. Land 4-1/2" perf'd liner @ 2780' T.D.
5. Oil frac w/30,000 gals. lease crude.
6. Run tubing, pump, rods, & complete.

I understand that this plan of work must receive approval in writing by the Geological Survey before operations may be commenced.

Company **Socany Mobil Oil Company, Inc.**

Address **P. O. Box 3371**
Durango, Colorado

By **M. Barry**
Dist. Prod. Supt.
Title

RECEIVED
JUL 18 1961
OIL CON. COM.
DIST. 3

NUMBER OF COPIES RECEIVED	
DISTRIBUTION	
SANTA FE	
FILE	
USGS	
LAND OFFICE	
TRANSPORTATION	
PRODUCTION OFFICE	
OPERATOR	

NEW MEXICO OIL CONSERVATION COMMISSION
WELL LOCATION AND ACREAGE DEDICATION PLAT
 SEE INSTRUCTIONS FOR COMPLETING THIS FORM ON THE REVERSE SIDE

FORM C-128
 Revised 5/1/57

SECTION A

Operator Socony Mobil Oil Company, Inc.			Lease Ute Mountain		Well No. 14
Unit Letter C	Section 22	Township 31N	Range 11W	County San Juan	
Actual Footage Location of Well: 660 feet from the North line and 1690 feet from the West line					
Ground Level Elev. 5669'	Producing Formation Lower Gallup		Pool Verde	Dedicated Acreage: 40 Acres	

1. Is the Operator the only owner in the dedicated acreage outlined on the plat below? YES ☒ NO ☐ ("Owner" means the person who has the right to drill into and to produce from any pool and to appropriate the production either for himself or for himself and another. (65-3-29 (e) NMSA 1935 Comp.)
2. If the answer to question one is "no," have the interests of all the owners been consolidated by communitization agreement or otherwise? YES ☐ NO ☐ If answer is "yes," Type of Consolidation _____
3. If the answer to question two is "no," list all the owners and their respective interests below:

Owner Socony Mobil Oil Company, Inc.	Land Description NE 1/4 Sec. 22
--	---

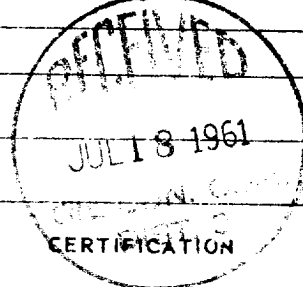

SECTION B

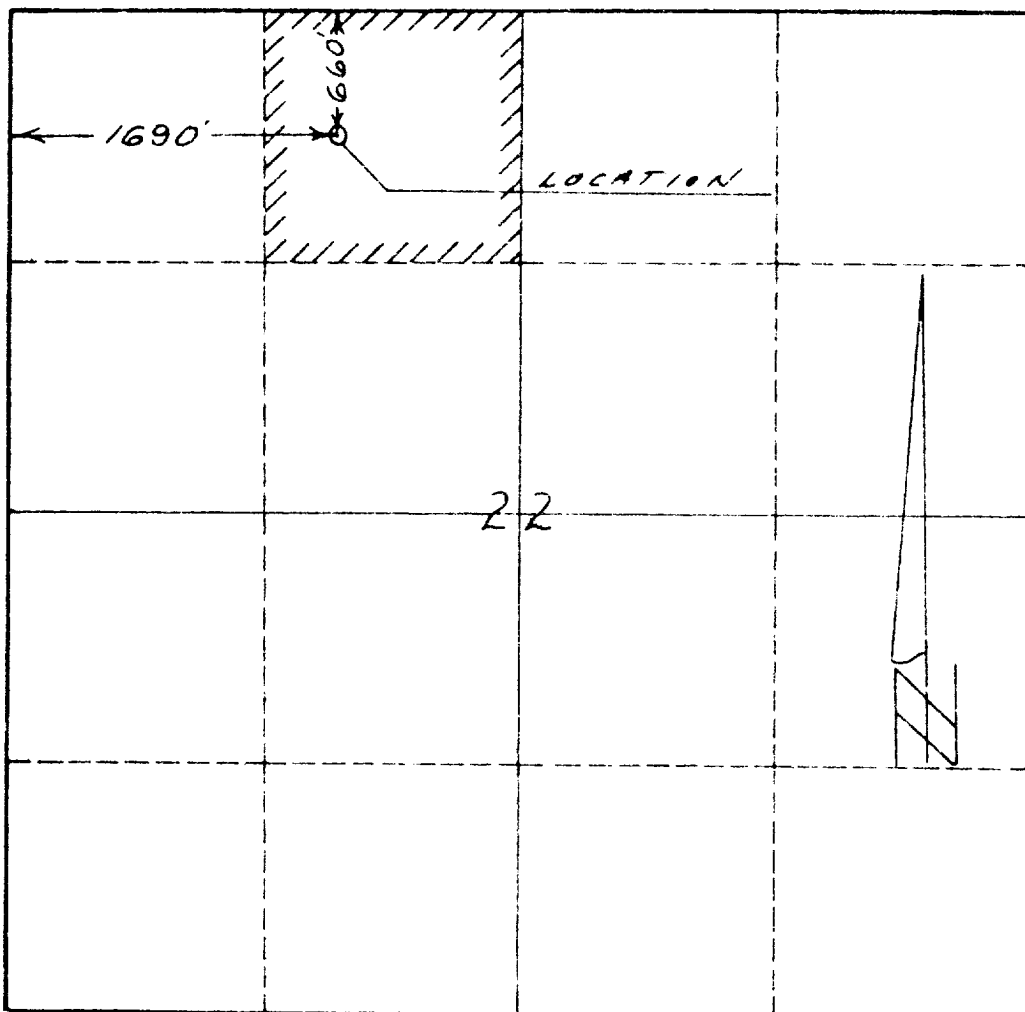

I hereby certify that the information in SECTION A above is true and complete to the best of my knowledge and belief.

Name <i>P.M. Barry</i>
Position Dist. Prod. Supt.
Company Socony Mobil Oil Co., Inc.
Date 7/14/61

I hereby certify that the well location shown on the plat in SECTION B was plotted from field notes of actual surveys made by me or under my supervision, and that the same is true and correct to the best of my knowledge and belief.

Date Surveyed
7/14/61
 Signature
Donald L. Johnson
 Certificate No.
LS 333

0 330 660 990 1320 1650 1980 2310 2640 2000 1500 1000 500 0