

UNITED STATES  
DEPARTMENT OF THE INTERIOR  
GEOLOGICAL SURVEY

30-845-20450

## APPLICATION FOR PERMIT TO DRILL, DEEPEN, OR PLUG BACK

1a. TYPE OF WORK DRILL <input checked="" type="checkbox"/> DEEPEN <input type="checkbox"/> PLUG BACK <input type="checkbox"/>	
b. TYPE OF WELL OIL WELL <input type="checkbox"/> GAS WELL <input checked="" type="checkbox"/> OTHER <input type="checkbox"/>	
2. NAME OF OPERATOR Aztec Oil and Gas	
3. ADDRESS OF OPERATOR Drawer 570, Farmington, New Mexico	
4. LOCATION OF WELL (Report location clearly and in accordance with any State requirements.)* At surface 1850 FSL & 1190 FWL, Sec. 30-31N-10W At proposed prod. zone	
14. DISTANCE IN MILES AND DIRECTION FROM NEAREST TOWN OR POST OFFICE*	
16. DISTANCE FROM PROPOSED* LOCATION TO NEAREST PROPERTY OR LEASE LINE, FT. (Also to nearest drlg. unit line, if any)	16. NO. OF ACRES IN LEASE
18. DISTANCE FROM PROPOSED LOCATION* TO NEAREST WELL, DRILLING, COMPLETED, OR APPLIED FOR, ON THIS LEASE, FT.	19. PROPOSED DEPTH 2605
21. ELEVATIONS (Show whether DF, RT, GR, etc.) 5873 Gr	
22. APPROX. DATE WORK WILL START*	

23. PROPOSED CASING AND CEMENTING PROGRAM				
SIZE OF HOLE	SIZE OF CASING	WEIGHT PER FOOT	SETTING DEPTH	QUANTITY OF CEMENT
12-1/4"	8-5/8"	24#	100'	50 sx
6-3/4"	4-1/2"	9.5#	2605'	250 sx

Propose to:

Drill 12-1/4" hole to TD 100', set 8-5/8" casing cement w/50 sx  
Drill 6-3/4" hole to TD 2605', set 4-1/2" casing cement w/250 sx  
Run Induction Electric log  
Perforate and frac Pictured Cliffs  
Run 1" tubing.

Proration unit: SW/4 Sec. 30-31N-10W

IN ABOVE SPACE DESCRIBE PROPOSED PROGRAM: If proposal is to deepen or plug back, give data on present productive zone and proposed new productive zone. If proposal is to drill or deepen directionally, give pertinent data on subsurface locations and measured and true vertical depths. Give blowout preventer program, if any.

24. SIGNED <u>Joe C. [Signature]</u>	TITLE <u>District Superintendent</u>	DATE <u>3-28-69</u>
(This space for Federal or State office use)		
PERMIT NO. _____	APPROVAL DATE _____	
APPROVED BY <u>[Signature]</u>	TITLE _____	
CONDITIONS OF APPROVAL, IF ANY:		

\*See Instructions On Reverse Side

RECEIVED

MAR 28 1969

U. S. GEOLOGICAL SURVEY  
FARMINGTON, N. M.RECEIVED  
APR 3 1969  
CON. COM.  
DIST. 3



NEW MEXICO OIL CONSERVATION COMMISSION  
WELL LOCATION AND ACREAGE DEDICATION PLAT

Form C-102  
Supersedes C-128  
Effective 1-1-65

All distances must be from the outer boundaries of the Section.

Operator <b>AZTEC OIL &amp; GAS COMPANY</b>		Lease <b>Pioneer</b>		Well No. <b>1</b>
Unit Letter <b>L</b>	Section <b>30</b>	Township <b>31 North</b>	Range <b>10 West</b>	County <b>San Juan</b>
Actual Footage Location of Well: <b>1850</b> feet from the <b>South</b> line and <b>1190</b> feet from the <b>West</b> line				
Ground Level Elev. <b>5873</b>	Producing Formation <b>Pictured Cliffs</b>	Pool <b>Hydra</b>	Dedicated Acreage <b>156.66 Acres</b>	

1. Outline the acreage dedicated to the subject well by colored pencil or hachure marks on the plat below.
2. If more than one lease is dedicated to the well, outline each and identify the ownership thereof (both as to working interest and royalty).
3. If more than one lease of different ownership is dedicated to the well, have the interests of all owners been consolidated by communitization, unitization, force-pooling, etc?

☒ Yes ☐ No If answer is "yes," type of consolidation communitization

If answer is "no," list the owners and tract descriptions which have actually been consolidated. (Use reverse side of this form if necessary.)

No allowable will be assigned to the well until all interests have been consolidated (by communitization, unitization, forced-pooling, or otherwise) or until a non-standard unit, eliminating such interests, has been approved by the Commission.

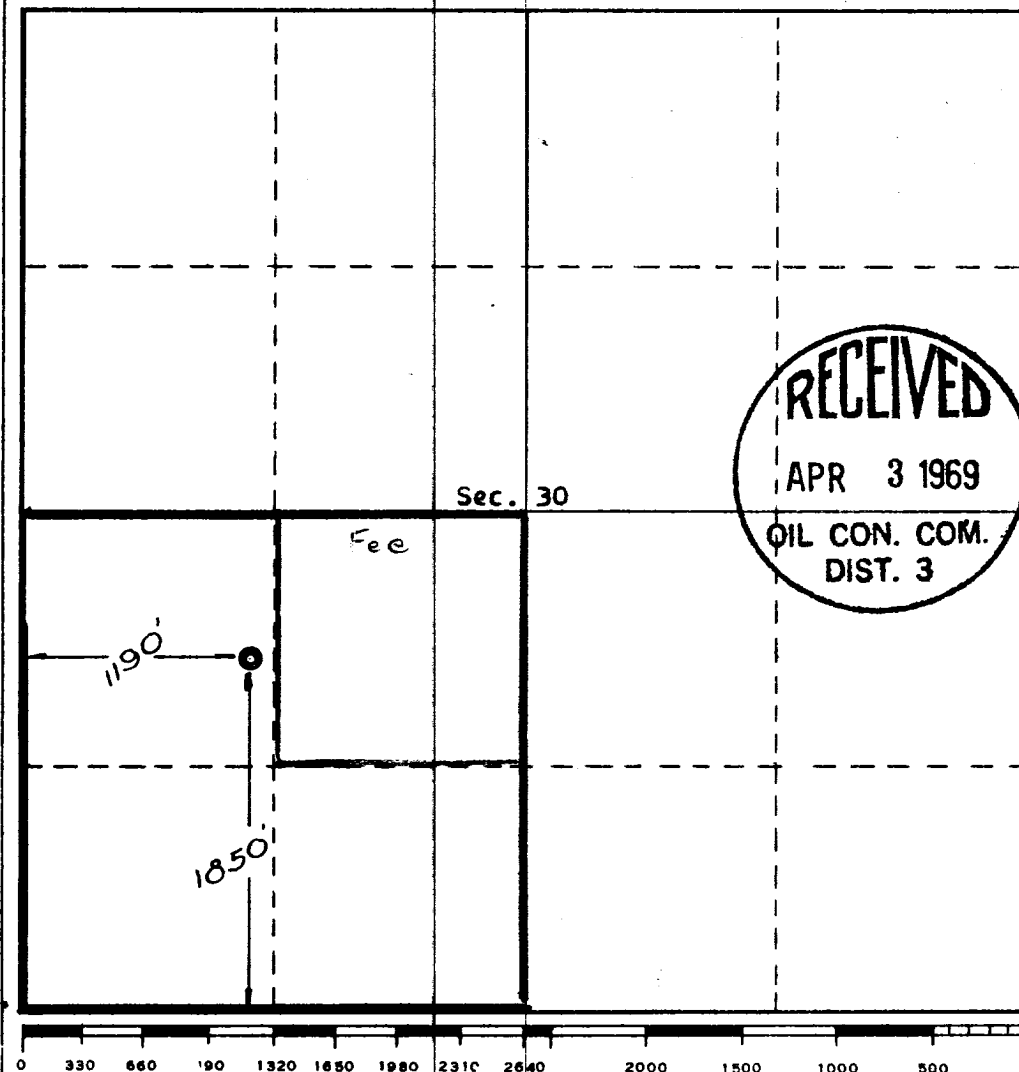

CERTIFICATION

I hereby certify that the information contained herein is true and complete to the best of my knowledge and belief.

Name  
**Joe C. Salmer**  
Position  
**District Superintendent**  
Company  
**Artec Oil and Gas**  
Date  
**3-28-69**

I hereby certify that the well location shown on this plat was plotted from field notes of actual surveys made by me or under my supervision, and that the same is true and correct to the best of my knowledge and belief.

Date Surveyed  
**March 24, 1969**  
Registered Professional Engineer and/or Land Surveyor

**E. V. Easbark**  
Certificate No. **3602**





## OIL CONSERVATION COMMISSION

STATE OF NEW MEXICO  
1000 RIO BRAZOS ROAD - AZTEC  
87410

GOVERNOR  
DAVID F. CARGO  
CHAIRMAN  
LAND COMMISSIONER  
ALEX ARMijo  
MEMBER  
STATE GEOLOGIST  
A. L. PORTER, JR.  
SECRETARY - DIRECTOR

April 3, 1969

Aztec Oil And Gas Company  
Drawer 570  
Farmington, New Mexico

Re: Acreage Dedication  
Pierce #4, L-30-31N-10W  
Aztec Pictured Cliffs Pool

Gentlemen:

Form C-102, Acreage Dedication Plat, filed for the above well shows a total acreage of 160 acres in the southwest quarter of Section 30, Township 31 North, Range 10 West. The General Land Office Survey Plat on file in our office indicates that the quarter section contains 156.60 acres. Please make the change in your records and we will correct your plat.

Yours very truly,

  
Emery C. Arnold  
Supervisor, District #3

ECA:mc

cc: United States Geological Survey  
Farmington, New Mexico

Oil Conservation Commission  
Santa Fe, New Mexico