

Denny E. Fout
DEPUTY OIL & GAS INSPECTOR
District I
P.O. Box 1980, Hobbs, NM

State of New Mexico
Energy, Minerals and Natural Resources Department

SUBMIT 1 COPY TO
APPROPRIATE
DISTRICT OFFICE
AND 1 COPY TO
SANTA FE OFFICE

District II
P.O. Drawer DD, Artesia, NM 88221
FEB 08 1999

OIL CONSERVATION DIVISION

District III
1000 Rio Brazos Rd, Aztec, NM 87410

2040 South Pacheco Street
Santa Fe, New Mexico 87505

Approved
PIT REMEDIATION AND CLOSURE REPORT

RECEIVED
NOV 12 1998
OIL CON. DIV.
DIST. 3

Operator: PNM Gas Services (Burlington) Telephone: 324-3164

Address: 603 W. Elm Street Farmington, NM 87401

Facility or Well Name: Patterson #3

Location: Unit N Sec 2 T 31 N R 12 W County San Juan

Pit Type: Separator ☒ Dehydrator ☐ Other ☐

Land Type: BLM ☐ State ☐ Fee ☒ Other ☐

Pit Location: Pit dimensions: length 20 width 20 depth 3

(Attach diagram) Reference: wellhead ☒ other ☐

Footage from reference: 70'

Direction from reference: 80 Degrees ☐ East ☐ North ☐
of ☒ West ☒ South

Depth to Ground Water:

(Vertical distance from contaminants to
seasonal high water elevation of ground
water)

Less than 50 feet	(20 points)	
50 feet to 99 feet	(10 points)	
Greater than 100 feet	(0 points)	20

Wellhead Protection Area:

(Less than 200 feet from a private
domestic water source, or, less than 1,000
feet from all other water sources)

Yes	(20 points)	
No	(0 points)	0

Distance to Surface Water:

(Horizontal distance to perennial lakes,
ponds, rivers, streams, creeks, irrigation
canals and ditches)

Less than 200 feet	(20 points)	
200 feet to 1,000 feet	(10 points)	
Greater than 1,000 feet	(0 points)	0

RANKING SCORE (TOTAL POINTS): 20

Patterson #3

Date Remediation Started: 5/12/98

Date Completed: 5/12/98

Remediation Method:

Excavation

X

Approx. Cubic Yard 260

(Check all appropriate sections)

Landfarmed

X

Amount Landfarmed (cubic yds) 260

Other

Remediation Location:

Onsite

X

Offsite

(i.e., landfarmed onsite, name and location of offsite facility)

RECEIVED
NOV 12 1998

Backfill Material Location:

OIL CON. DIV.
DIST. 3

General Description of Remedial Action:

Excavated contaminated soil to a pit size of 19' X 23' X 16' and landfarmed soil onsite within a bermed area at a depth of 6" to 12". Soil was aerated by disking/plowing until soil met regulatory levels.

Ground Water Encountered:

No



Yes



Depth

Final Pit Closure

Sampling:

Sample Location

Bottom of excavation.

(if multiple samples, attach sample result and diagram of sample locations and depths.)

Sample depth

16'

Sample date

5/12/98

Sample time

2:00:00 PM

Sample Results

Benzene (ppm) < 0.0010

Total BTEX (ppm) < 0.0070

Field headspace (ppm)

TPH (ppm)

< 25.00

Method

8015

Vertical Extent (ft)

Risk Analysis form attached Yes



No



Ground Water Sample:

Yes



No



(If yes, see attached Groundwater Site Summary Report)

I HEREBY CERTIFY THAT THE INFORMATION ABOVE IS TRUE AND COMPLETE TO THE BEST OF MY KNOWLEDGE AND MY BELIEF

DATE October 29, 1998

SIGNATURE

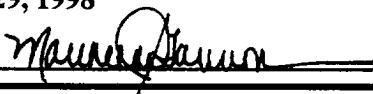
PRINTED NAME Maureen Gannon
AND TITLE Project Manager

Patterson #3

5/12/98

Burlington Resources

Sec. 2, 31 N, 12 W, N

Start of excavation:

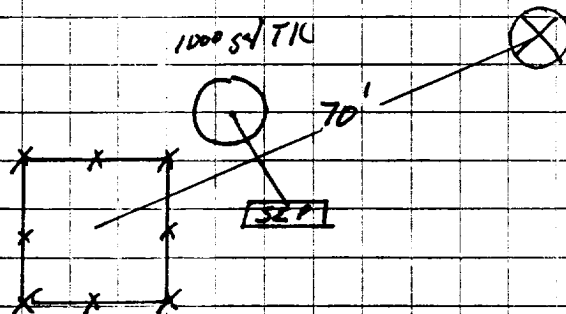

End of excavation

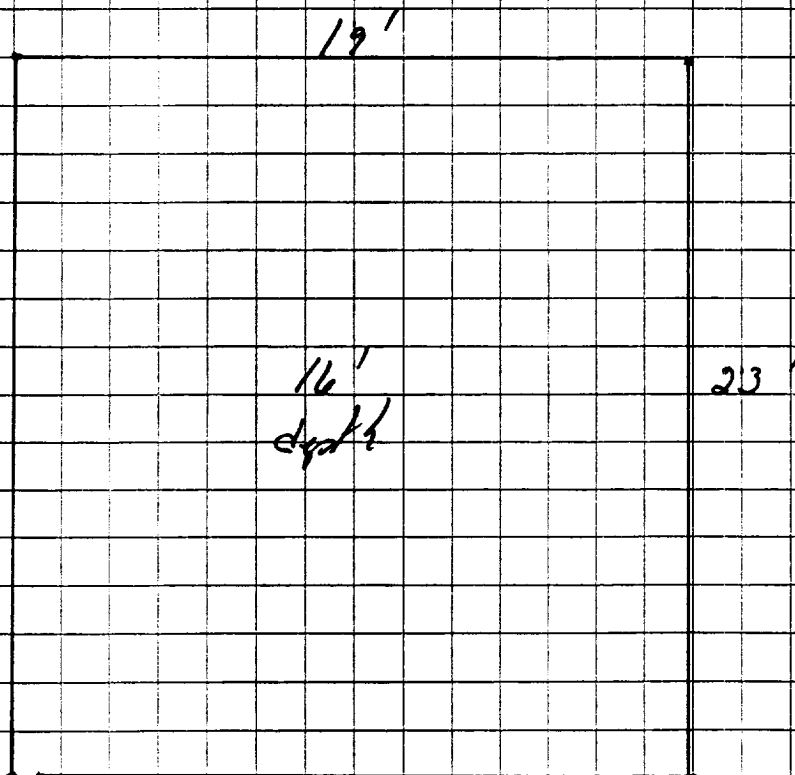

OFF: (505) 325-5667



LAB: (505) 325-1556

On Site Technologies, LTD.

Date: 26-May-98

CLIENT: PNM - Public Service Company of NM

Project: Patterson #3

Lab Order: 9805036

CASE NARRATIVE

Samples were analyzed using the methods outlined in the following references:

Test Methods for Evaluating Solid Waste, Physical/Chemical Methods, SW846, 3rd Edition

All method blanks, laboratory spikes, and/or matrix spikes met quality assurance objectives.

OFF: (505) 325-5667



LAB: (505) 325-1556

ANALYTICAL REPORT

Date: 26-May-98

Client:	PNM - Public Service Company of NM	Client Sample Info:	Patterson #3
Work Order:	9805036	Client Sample ID:	9805121400; Bottom @ 16ft.
Lab ID:	9805036-01A	Matrix:	SOIL
Project:	Patterson #3	Collection Date:	5/12/98 2:00:00 PM
		COC Record:	7213

Parameter	Result	PQL	Qual	Units	DF	Date Analyzed
DIESEL RANGE ORGANICS		SW8015				Analyst: DC
T/R Hydrocarbons: C10-C28	ND	25		mg/Kg	1	5/21/98
BTEX		SW8020A				Analyst: HR
Benzene	ND	1		µg/Kg	1	5/18/98
Toluene	ND	2		µg/Kg	1	5/18/98
Ethylbenzene	ND	1		µg/Kg	1	5/18/98
m,p-Xylene	ND	2		µg/Kg	1	5/18/98
o-Xylene	ND	1		µg/Kg	1	5/18/98
<div>7 0.0070 ppm</div>						

Qualifiers:	PQL - Practical Quantitation Limit	S - Spike Recovery outside accepted recovery limits
	ND - Not Detected at Practical Quantitation Limit	R - RPD outside accepted recovery limits
	J - Analyte detected below Practical Quantitation Limit	E - Value above quantitation range
	B - Analyte detected in the associated Method Blank	Surr: - Surrogate

1 of 1

P.O. BOX 2606 • FARMINGTON, NM 87499

- TECHNOLOGY BLENDING INDUSTRY WITH THE ENVIRONMENT -

OFF: (505) 325-5667



LAB: (505) 325-1556

ANALYTICAL REPORT

Date: 26-May-98

Client:	PNM - Public Service Company of NM	Client Sample Info:	Patterson #3
Work Order:	9805036	Client Sample ID:	9805121405; Walls @ 13ft.
Lab ID:	9805036-02A	Matrix:	SOIL
Project:	Patterson #3	Collection Date:	5/12/98 2:05:00 PM
		COC Record:	7213

Parameter	Result	PQL	Qual	Units	DF	Date Analyzed
DIESEL RANGE ORGANICS		SW8015				Analyst: DC
T/R Hydrocarbons: C10-C28	ND	25		mg/Kg	1	5/21/98
BTEX		SW8020A				Analyst: HR
Benzene	ND	1		µg/Kg	1	5/18/98
Toluene	ND	2		µg/Kg	1	5/18/98
Ethylbenzene	ND	1		µg/Kg	1	5/18/98
m,p-Xylene	2.2	2		µg/Kg	1	5/18/98
o-Xylene	ND	1		µg/Kg	1	5/18/98

Qualifiers: PQL - Practical Quantitation Limit
ND - Not Detected at Practical Quantitation Limit
J - Analyte detected below Practical Quantitation Limit
B - Analyte detected in the associated Method Blank

S - Spike Recovery outside accepted recovery limits
R - RPD outside accepted recovery limits
E - Value above quantitation range
Surr: - Surrogate

1 of 1

Patterson # 3

6/29/98

BR

Sec. 2, 31N, 12W, N

Landfarm:

260 yards

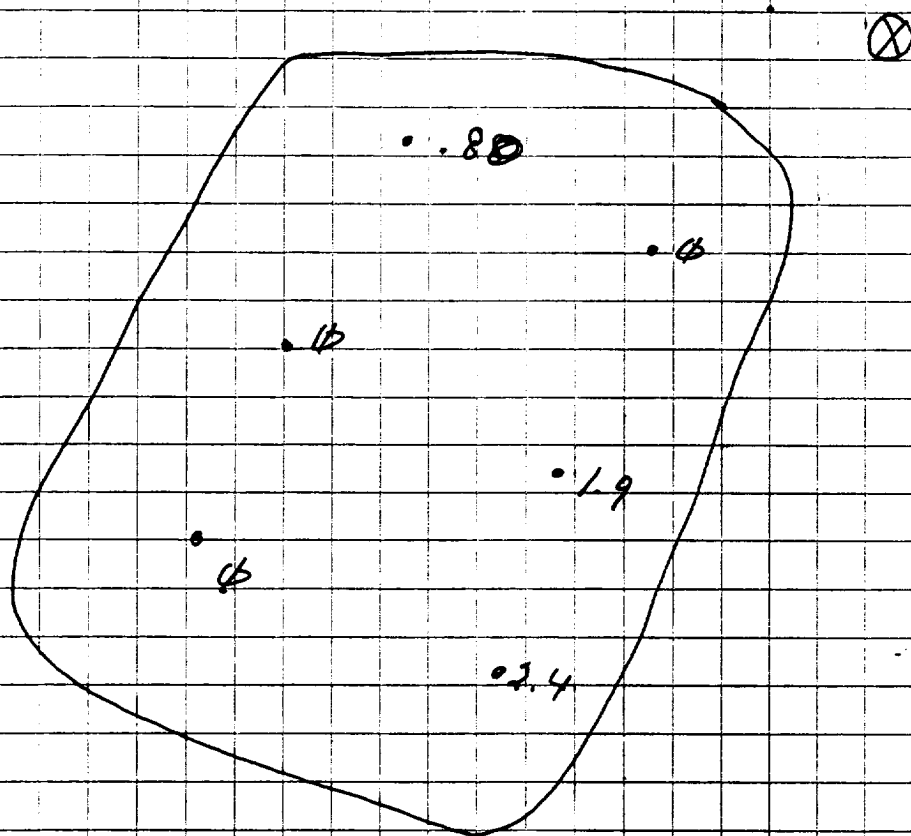

9806290930

2"-12" depth

soil vapor head space = 6.6ppm

OFF: (505) 325-5667



LAB: (505) 325-1556

On Site Technologies, LTD.

Date: 20-Aug-98

CLIENT: PNM - Public Service Company of NM

Project: PNM Pit Remediation

Lab Order: 9808022

CASE NARRATIVE

Samples were analyzed using the methods outlined in the following references:

Test Methods for Evaluating Solid Waste, Physical/Chemical Methods, SW846, 3rd Edition

All method blanks, laboratory spikes, and/or matrix spikes met quality assurance objectives.

OFF: (505) 325-5667



LAB: (505) 325-1556

ANALYTICAL REPORT

Date: 20-Aug-98

Client:	PNM - Public Service Company of NM	Client Sample Info:	Patterson #3 LF
Work Order:	9808022	Client Sample ID:	9808111330
Lab ID:	9808022-01A	Matrix:	SOIL
Project:	PNM Pit Remediation	Collection Date:	8/11/98 1:30:00 PM
		COC Record:	7330

Parameter	Result	PQL	Qual	Units	DF	Date Analyzed
DIESEL RANGE ORGANICS		SW8015				Analyst: HR
T/R Hydrocarbons: C10-C28	ND	25		mg/Kg	1	8/17/98

Qualifiers:

- PQL - Practical Quantitation Limit
- ND - Not Detected at Practical Quantitation Limit
- J - Analyte detected below Practical Quantitation Limit
- B - Analyte detected in the associated Method Blank

- S - Spike Recovery outside accepted recovery limits
- R - RPD outside accepted recovery limits
- E - Value above quantitation range
- Surr: - Surrogate

1 of 1

P.O. BOX 2606 • FARMINGTON, NM 87499

- Environmental Remediation Services -