

NO. OF COPIES RECEIVED	6
DISTRIBUTION	
SANTA FE	1
FILE	1 ✓
U.S.G.S.	2
LAND OFFICE	1
OPERATOR	1

NEW MEXICO OIL CONSERVATION COMMISSION

Form C-101
Revised 1-1-65 30-045-20705

5A. Indicate Type of Lease
STATE ☐ FEE ☒
5. State Oil & Gas Lease No.

APPLICATION FOR PERMIT TO DRILL, DEEPEN, OR PLUG BACK

1a. Type of Work DRILL <input checked="" type="checkbox"/> DEEPEN <input type="checkbox"/> PLUG BACK <input type="checkbox"/>		7. Unit Agreement Name
b. Type of Well OIL WELL <input type="checkbox"/> GAS WELL <input checked="" type="checkbox"/> OTHER <input type="checkbox"/> SINGLE ZONE <input checked="" type="checkbox"/> MULTIPLE ZONE <input type="checkbox"/>		8. Farm or Lease Name Pandleman
2. Name of Operator Aztec Oil & Gas Company		9. Well No. #2
3. Address of Operator Drawer 570, Farmington, New Mexico		10. Field and Pool, or Wildcat Blanco Picture Cliff
4. Location of Well UNIT LETTER M LOCATED 800 FEET FROM THE South LINE AND 800 FEET FROM THE West LINE OF SEC. 13 TWP. 31N RGE. 11W NMPM		12. County San Juan
19. Proposed Depth 2630'		19A. Formation Picture Cliff
20. Rotary or C.T. Rotary		
21. Elevations (Show whether DF, RT, etc.) 5850 Gr	21A. Kind & Status Plug. Bond	21B. Drilling Contractor Arapahoe
22. Approx. Date Work will start		

PROPOSED CASING AND CEMENT PROGRAM

SIZE OF HOLE	SIZE OF CASING	WEIGHT PER FOOT	SETTING DEPTH	SACKS OF CEMENT	EST. TOP
12 1/4"	8-5/8"	24#	100'	75 sxs	
6-3/4"	4-1/2"	9.5#	2630'	250 sxs	

PROPOSE TO:

Drill 12 1/4" hole to 100', set 8-5/8" casing cement with 75 sxs.
Drill 6-3/4" hole to TD 2630', set 4 1/2" casing cement with 250 sxs.
Perforate & Frac Picture Cliff Formation.
Run 1" Tubing.

APPROVAL VALID
FOR 90 DAYS UNLESS
DRILLING COMMENCED,

EXPIRES 1-25-71



Proration Unit: SW/4 Section 13-31N-11W

IN ABOVE SPACE DESCRIBE PROPOSED PROGRAM: IF PROPOSAL IS TO DEEPEN OR PLUG BACK, GIVE DATA ON PRESENT PRODUCTIVE ZONE AND PROPOSED NEW PRODUCTIVE ZONE. GIVE BLOWOUT PREVENTER PROGRAM, IF ANY.

I hereby certify that the information above is true and complete to the best of my knowledge and belief.

Signed Joe O. Salmon Title District Superintendent Date October 21, 1970

(This space for State Use)

APPROVED BY George Arnold TITLE Sup Dist III DATE 10-26-70
CONDITIONS OF APPROVAL, IF ANY:

**NEW MEXICO OIL CONSERVATION COMMISSION
WELL LOCATION AND ACREAGE DEDICATION PLAT**

Form C-102
Supersedes C-128
Effective 1-1-65

All distances must be from the outer boundaries of the Section.

Operator Artec Oil & Gas Company			Lease <i>Randleman</i>		Well No. #2
Unit Letter M	Section 13	Township 31N	Range 11W	County San Juan	
Actual Footage Location of Well: <div style="display: flex; justify-content: space-between;"> 800 feet from the South line and 800 feet from the West line </div>					
Ground Level Elev. 5850	Producing Formation Pictured Cliffs	Pool <i>Blanco E-qt.</i>		Dedicated Acreage: 160 Acres	

1. Outline the acreage dedicated to the subject well by colored pencil or hachure marks on the plat below.
2. If more than one lease is dedicated to the well, outline each and identify the ownership thereof (both as to working interest and royalty).
3. If more than one lease of different ownership is dedicated to the well, have the interests of all owners been consolidated by communitization, unitization, force-pooling, etc?

☐ Yes ☐ No If answer is "yes," type of consolidation _____

If answer is "no," list the owners and tract descriptions which have actually been consolidated on the reverse side of this form if necessary.) _____

No allowable will be assigned to the well until all interests have been consolidated (by communitization, unitization, forced-pooling, or otherwise) or until a non-standard unit, eliminating such interests, has been approved by the Commission.

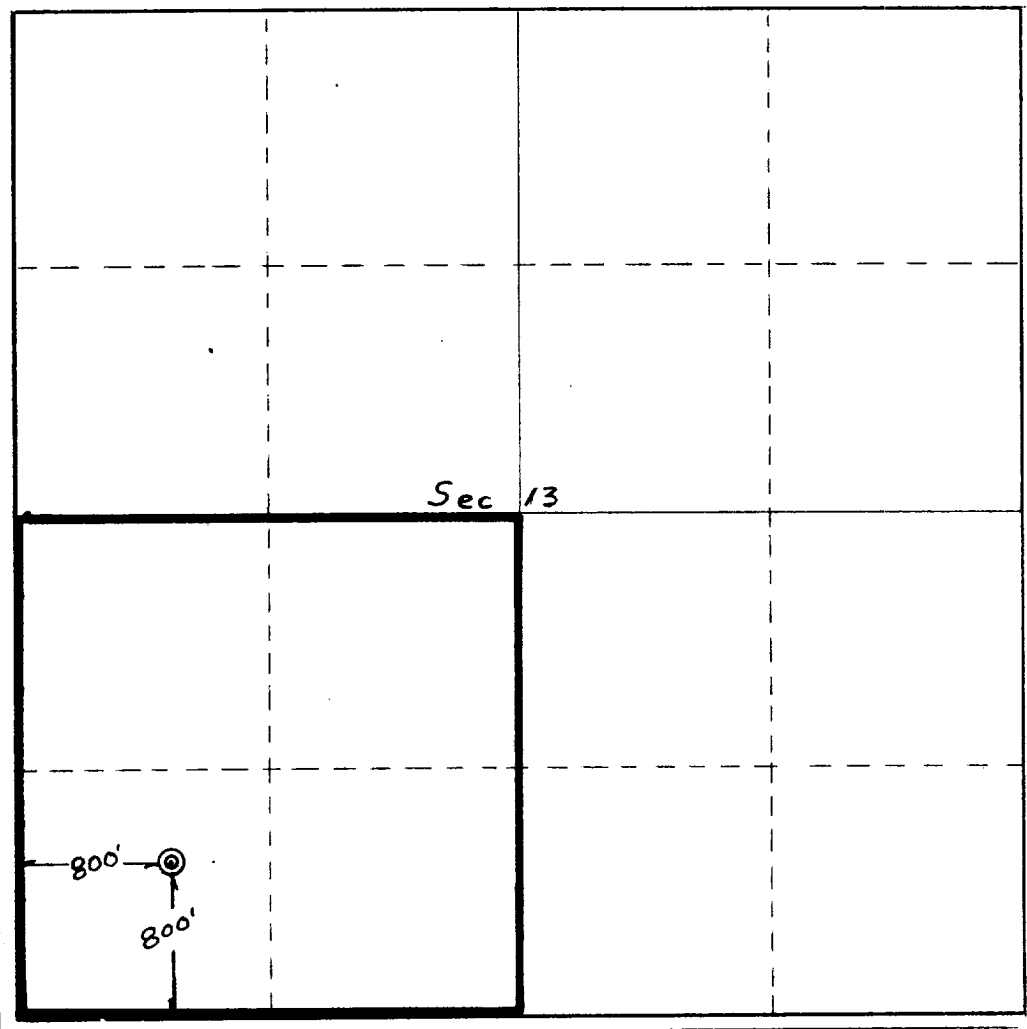
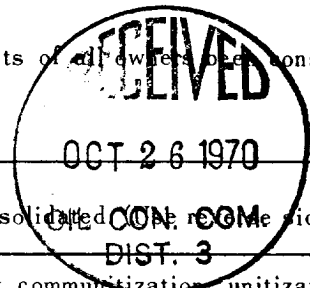

CERTIFICATION

I hereby certify that the information contained herein is true and complete to the best of my knowledge and belief.

ORIGINAL SIGNED BY JOE C. SALMON

Name
Joe C. Salmon

Position
District Superintendent

Company
Artec Oil & Gas Company

Date
October 21, 1970

I hereby certify that the well location shown on this plat was plotted from field notes of actual surveys made by me or under my supervision, and that the same is true and correct to the best of my knowledge and belief.

Date Surveyed
June 30, 1969

Registered Professional Engineer or Professional Surveyor
[Signature]
3950

Certificate No.
3950

