

UNITED STATES
DEPARTMENT OF THE INTERIOR
GEOLOGICAL SURVEY

APPLICATION FOR PERMIT TO DRILL, DEEPEN, OR PLUG BACK

1a. TYPE OF WORK DRILL <input checked="" type="checkbox"/> DEEPEN <input type="checkbox"/> PLUG BACK <input type="checkbox"/>		5. LEASE DESIGNATION AND SERIAL NO. NM-013686	
b. TYPE OF WELL OIL WELL <input type="checkbox"/> GAS WELL <input checked="" type="checkbox"/> OTHER <input type="checkbox"/> SINGLE ZONE <input checked="" type="checkbox"/> MULTIPLE ZONE <input type="checkbox"/>		6. IF INDIAN, ALLOTTEE OR TRIBE NAME	
2. NAME OF OPERATOR Tenneco Oil Company		7. UNIT AGREEMENT NAME	
3. ADDRESS OF OPERATOR Suite 1200 Lincoln Tower Building, Denver, Colorado 80203		8. FARM OR LEASE NAME Pritchard	
4. LOCATION OF WELL (Report location clearly and in accordance with any State requirements.)* At surface 1190' F/NL and 1650' F/EL At proposed prod. zone		9. WELL NO. 5	
14. DISTANCE IN MILES AND DIRECTION FROM NEAREST TOWN OR POST OFFICE*		10. FIELD AND POOL, OR WILDCAT Basin Dakota	
15. DISTANCE FROM PROPOSED* LOCATION TO NEAREST PROPERTY OR LEASE LINE, FT. (Also to nearest dirg. unit line, if any)		11. SEC., T., R., M., OR BLK. AND SURVEY OR AREA Sec. 34, T-31-N, R-9-W	
16. NO. OF ACRES IN LEASE 1275.56		12. COUNTY OR PARISH San Juan	
17. NO. OF ACRES ASSIGNED TO THIS WELL 320 316.09		13. STATE New Mexico	
18. DISTANCE FROM PROPOSED LOCATION* TO NEAREST WELL, DRILLING, COMPLETED, OR APPLIED FOR, ON THIS LEASE, FT. 7480		20. ROTARY OR CABLE TOOLS Rotary	
21. ELEVATIONS (Show whether DF, RT, GR, etc.) 6007 GR		22. APPROX. DATE WORK WILL START* Upon approval	

23. PROPOSED CASING AND CEMENTING PROGRAM

SIZE OF HOLE	SIZE OF CASING	WEIGHT PER FOOT	SETTING DEPTH	QUANTITY OF CEMENT
15"	10-3/4	32.75	300	Suff. to circulate
9-7/8"	7-5/8	24	3000	500 sacks
6-3/4"	4-1/2	10.5	7480	Suff. to fill 500' above Dakota

Well to be drilled to approx. T.D. of 7480' and logged. If production is indicated, casing will be run, perforated and formation treated as necessary to establish commercial production. Mud to be used 0' to 3000' and gas from 3000' to T.D. B.O.P. to be tested each 24 hours.

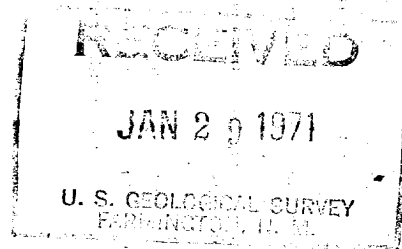
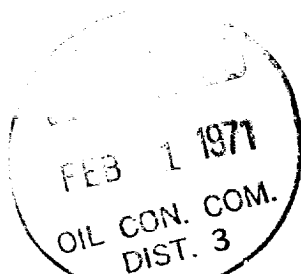

IN ABOVE SPACE DESCRIBE PROPOSED PROGRAM: If proposal is to deepen or plug back, give data on present productive zone and proposed new productive zone. If proposal is to drill or deepen directionally, give pertinent data on subsurface locations and measured and true vertical depths. Give blowout preventer program, if any.

24. SIGNED [Signature] TITLE Sr. Production Clerk DATE 1-27-71

(This space for Federal or State office use)

PERMIT NO. 71 APPROVAL DATE _____

APPROVED BY _____ TITLE _____ DATE _____

CONDITIONS OF APPROVAL, IF ANY:

*See Instructions On Reverse Side

WELL LOCATION AND ACREAGE CERTIFICATION PLAT

All acreage shown on this plat is in the public domain.

TENNECO OIL COMPANY

O. E. BRITCHARD

5

B 34 31 NORTH 9 WEST SAN JUAN

1190 NORTH 1650 EAST

6007.0

Dakota

Basin Dakota

~~320~~ 316.09

I, the undersigned, being duly sworn, depose and say that the above information is true and correct to the best of my knowledge and belief.

I further depose and say that the above information was obtained from field notes of actual surveys made by me or under my supervision, and that the same is true and correct to the best of my knowledge and belief.

I further depose and say that the above information was obtained from field notes of actual surveys made by me or under my supervision, and that the same is true and correct to the best of my knowledge and belief.

I further depose and say that the above information was obtained from field notes of actual surveys made by me or under my supervision, and that the same is true and correct to the best of my knowledge and belief.

I further depose and say that the above information was obtained from field notes of actual surveys made by me or under my supervision, and that the same is true and correct to the best of my knowledge and belief.

I further depose and say that the above information was obtained from field notes of actual surveys made by me or under my supervision, and that the same is true and correct to the best of my knowledge and belief.



CERTIFICATION

I hereby certify that the information contained herein is true and complete to the best of my knowledge and belief.

G. A. Ford

Sr. Production Clerk

Tenneco Oil Company

1-27-71

I hereby certify that the well location shown on this plat was plotted from field notes of actual surveys made by me or under my supervision, and that the same is true and correct to the best of my knowledge and belief.

14 January, 1971

JAMES P. LEESE

1463

Contract No.

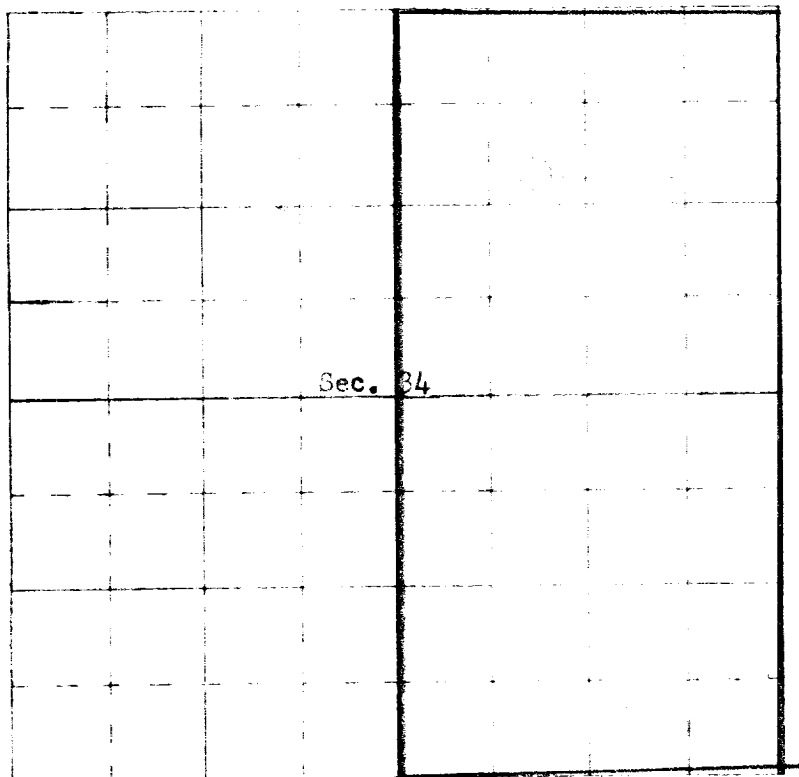

SCALE—4 INCHES EQUALS 1 MILE