

NEW MEXICO OIL CONSERVATION COMMISSION
WELL LOCATION AND ACERAGE DEDICATION PLAT

All distances must be from the outer boundaries of the Section

Operator AMOCO PRODUCTION COMPANY			Lease KEYS GAS COM "E"		Well No. 1
Unit Letter D	Section 27	Township 32 NORTH	Range 10 WEST	County SAN JUAN	
Actual Footage Location of Well: 790 feet from the NORTH line and 1190 feet from the WEST line					
Ground Level Elev. 5725.0 Est.	Producing Formation FRUITLAND	Pool UNDESIGNATED FRUITLAND	Dedicated Acreage: NW4 160 Acres		

1. Outline the acreage dedicated to the subject well by colored pencil or hachure marks on the plat below.

2. If more than one lease is dedicated to the well, outline each and identify the ownership thereof (both as to working interest and royalty),

3. If more than one lease of different ownership is dedicated to the well, have the interests of all owners been consolidated by communitization, unitization, force-pooling, etc?

() Yes () No If answer is "yes," type of consolidation

If answer is "no," list the owners and tract descriptions which have actually consolidated. (Use reverse side of this form if necessary.)

No allowable will be assigned to the well until all interests have been consolidated (by communitization, unitization, forced-pooling, or otherwise) or until a non standard unit, eliminating such interests, has been approved by the Commission.

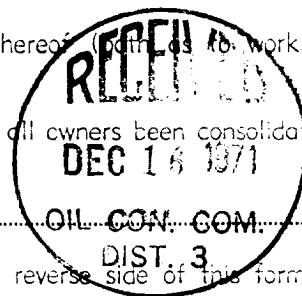

CERTIFICATION

I hereby certify that the information contained herein is true and complete to the best of my knowledge and belief.

Name D. A. Waynan
 Position Area Engineer
 Company AMOCO PRODUCTION COMPANY
 Date December 14, 1971

I hereby certify that the well location shown on this plat was plotted from field notes or actual surveys made by me or under my supervision, and that the same is true and correct to the best of my knowledge and belief.

Date Surveyed 10-14-1971
[Signature]
 Registered Professional Engineer
 and/or Land Surveyor

1463
 Certificate No. 1463

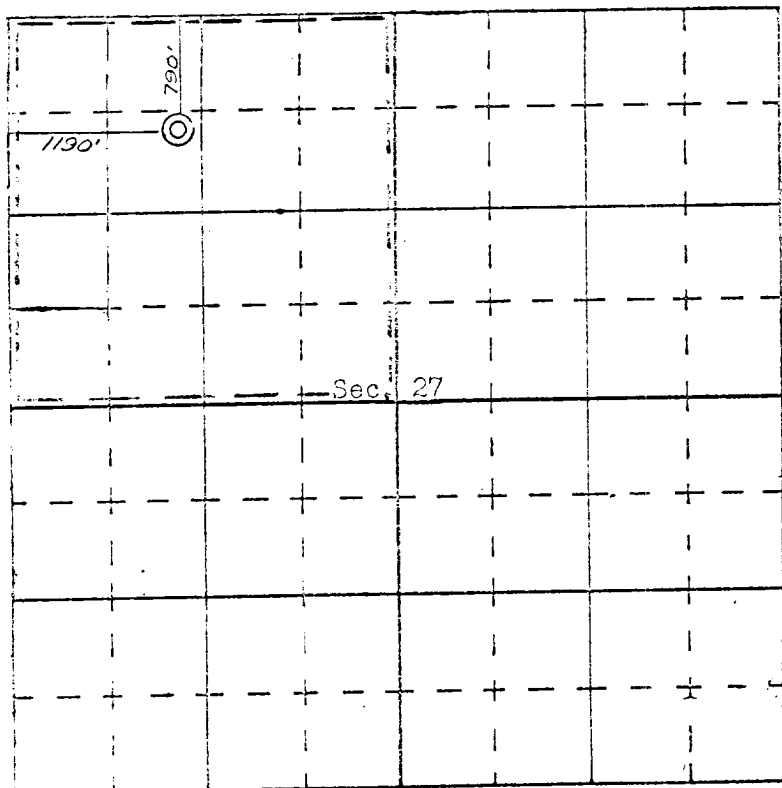

SCALE—4 INCHES EQUALS 1 MILE

SAN JUAN ENGINEERING COMPANY, FARMINGTON, N. M.