

UNITED STATES  
DEPARTMENT OF THE INTERIOR  
GEOLOGICAL SURVEY

SUBMIT IN TRIPLICATE\*  
(Other instructions on re-verse side)

Form approved.  
Budget Bureau No. 42-R1424.

5. LEASE DESIGNATION AND SERIAL NO.

NM 0607

6. IF INDIAN, ALLOTTEE OR TRIBE NAME

7. UNIT AGREEMENT NAME

8. FARM OR LEASE NAME

Atlantic C

9. WELL NO.

12

10. FIELD AND POOL, OR WILDCAT

Blanco Pictured Cliffs Ext.

11. SEC., T., R., M., OR BLK. AND SURVEY OR AREA

Sec. 31, T-31-N, R-10-W  
NMPM

12. COUNTY OR PARISH 13. STATE

San Juan

New Mexico

14. PERMIT NO.

15. ELEVATIONS (Show whether DF, RT, GR, etc.)

6055'GL

16.

Check Appropriate Box To Indicate Nature of Notice, Report, or Other Data

NOTICE OF INTENTION TO:

TEST WATER SHUT-OFF

FRACTURE TREAT

SHOOT OR ACIDIZE

REPAIR WELL

(Other)

PULL OR ALTER CASING

MULTIPLE COMPLETE

ABANDON\*

CHANGE PLANS

SUBSEQUENT REPORT OF:

WATER SHUT-OFF

FRACTURE TREATMENT

SHOOTING OR ACIDIZING

(Other)

REPAIRING WELL

ALTERING CASING

ABANDONMENT\*

(NOTE: Report results of multiple completion on Well Completion or Recompletion Report and Log form.)

17. DESCRIBE PROPOSED OR COMPLETED OPERATIONS (Clearly state all pertinent details, and give pertinent dates, including estimated date of starting any proposed work. If well is directionally drilled, give subsurface locations and measured and true vertical depths for all markers and zones pertinent to this work.)\*

12-3-72 Spudded well. Drilled surface hole. Ran 4 joints 8 5/8", 24#, KS surface casing, 131' set at 143'. Cemented with 107 cu. ft. cement, circulated to surface. WOC 12 hours, held 600#/30 minutes.

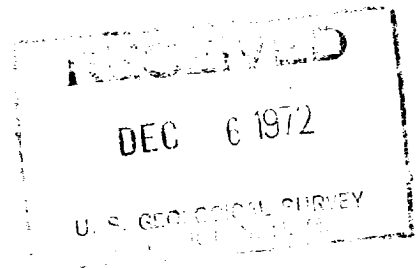

18. I hereby certify that the foregoing is true and correct

SIGNED

*[Signature]*

TITLE

Petroleum Engineer

DATE

December 5, 1972

(This space for Federal or State office use)

APPROVED BY

TITLE

DATE

CONDITIONS OF APPROVAL, IF ANY:

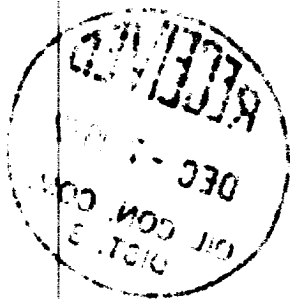

NEW MEXICO OIL CONSERVATION COMMISSION  
WELL LOCATION AND ACREAGE DEDICATION PLAT

Form C-102  
Supersedes C-128  
Effective 1-1-65

All distances must be from the outer boundaries of the Section.

Operator <b>EL PASO NATURAL GAS COMPANY</b>		Lease <b>ATLANTIC C</b>		Well No. <b>12</b>
Unit Letter <b>K</b>	Section <b>31</b>	Township <b>31-N</b>	Range <b>10-W</b>	County <b>SAN JUAN</b>
Actual Footage Location of Well: <b>1650</b> feet from the <b>SOUTH</b> line and <b>1650</b> feet from the <b>WEST</b> line				
Ground Level Elev. <b>6055</b>	Producing Formation <b>PICTURED CLIFFS</b>	Pool <b>BLANCO PICTURED CLIFFS EXT.</b>	Dedicated Acreage: <b>159.15</b> Acres	

- Outline the acreage dedicated to the subject well by colored pencil or hachure marks on the plat below.
- If more than one lease is dedicated to the well, outline each and identify the ownership thereof (both as to working interest and royalty).
- If more than one lease of different ownership is dedicated to the well, have the interests of all owners been consolidated by communitization, unitization, force-pooling, etc?

Yes  No If answer is "yes," type of consolidation \_\_\_\_\_

If answer is "no," list the owners and tract descriptions which have actually been consolidated. (Use reverse side of this form if necessary.) \_\_\_\_\_

No allowable will be assigned to the well until all interests have been consolidated (by communitization, unitization, forced-pooling, or otherwise) or until a non-standard unit, eliminating such interests, has been approved by the Commission. **NOTE: CORRECTED ACREAGE PER DEPENDENT RESURVEY.**

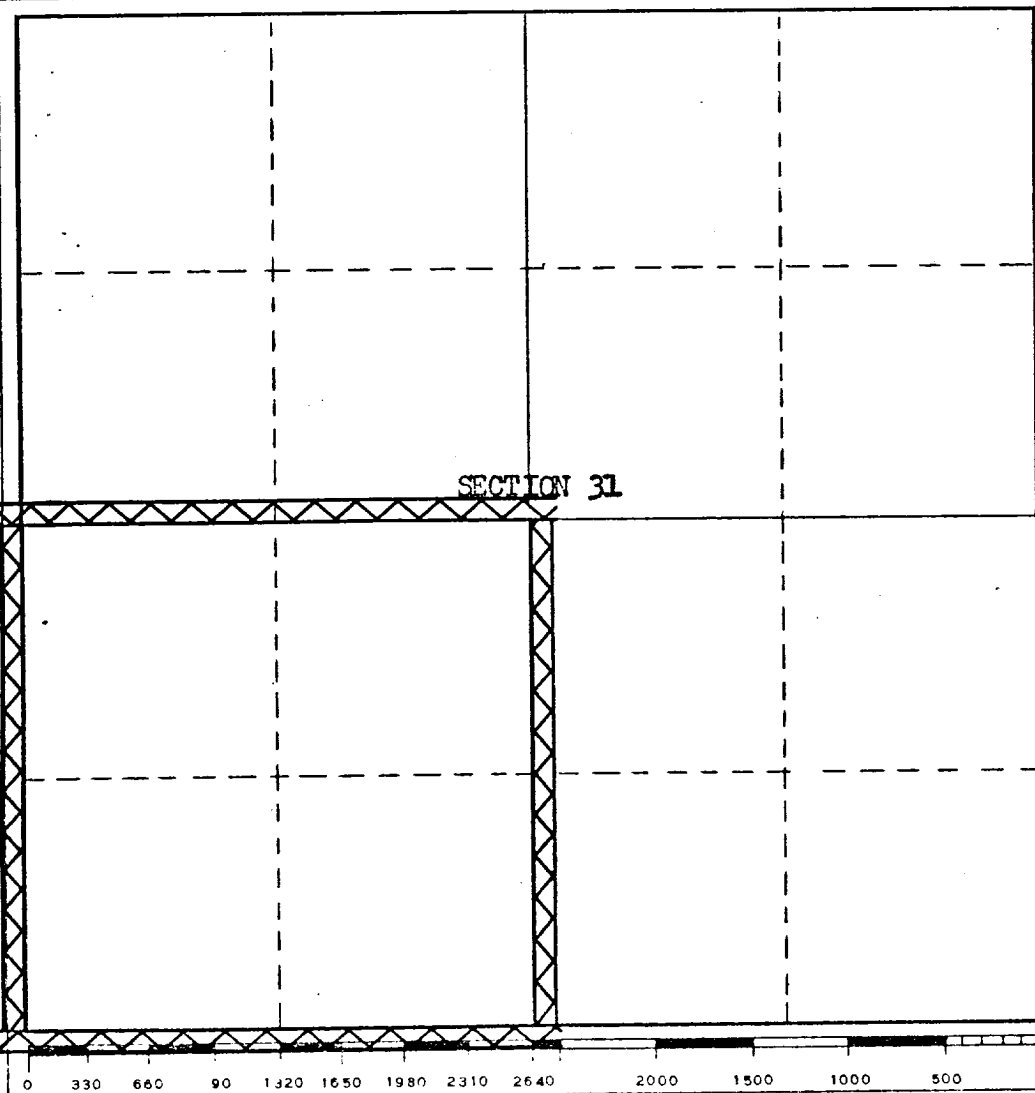
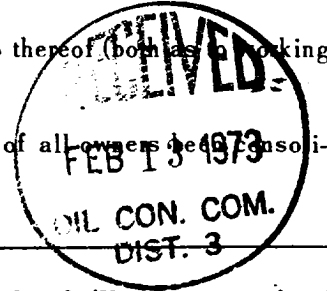

**CERTIFICATION**

*I hereby certify that the information contained herein is true and complete to the best of my knowledge and belief.*

---

Name  
Original Signed **F. H. WOOD**

Position  
**Petroleum Engineer**

Company  
**El Paso Natural Gas Company**

Date  
**February 13, 1973**

---

*I hereby certify that the well location shown on this plat was plotted from field notes of actual surveys made by me or under my supervision, and that the same is true and correct to the best of my knowledge and belief.*

---

Date Surveyed  
**1972**

Registered Professional Engineer and/or Land Surveyor

---

Certificate No.

