

NEW MEXICO OIL CONSERVATION COMMISSION
WELL LOCATION AND ACREAGE DEDICATION PLAT

Form 1-1
Supersedes C-128
Effective 1-1-66

All distances must be from the outer boundaries of the Section.

EL PASO NATURAL GAS COMPANY		SAN JUAN 32-9 UNIT (SF-078507)		81
Section	26	Range	32-N	County
Section	K	Range	10-W	County
Acres	1800	Section	SOUTH	Acres
Acres	6961	Section	FRUITLAND	Acres
Acres	1680	Section	UNDESIGNATED FRUITLAND	Acres
Acres	150.82	Section	WEST	Acres

1. Outline the acreage dedicated to the subject well by colored pencil or machine marks on the plat below.
2. If more than one lease is dedicated to the well, outline each and indicate the ownership thereof (both as to working interest and royalty).
3. If more than one lease of different ownership is dedicated to the well, have the interests of all owners been consolidated by communitization, unitization, force-pooling, etc?

☒ Yes ☐ No If answer is "yes," type of consolidation: Unitization

If answer is "no," list the owners and tract descriptions which have actually been consolidated. (Use reverse side of this form if necessary.)

No allowable will be assigned to the well until all interests have been consolidated (by communitization, unitization, forced-pooling, or otherwise) or until a non-standard unit, eliminating such interests, has been approved by the Commission. **NOTE: THIS PLAT REISSUED TO SHOW CORRECTED ACREAGE DEDICATION. 5-16-73**



RECEIVED

MAY 21 1973

U. S. GEOLOGICAL SURVEY
FARMINGTON, N. M.

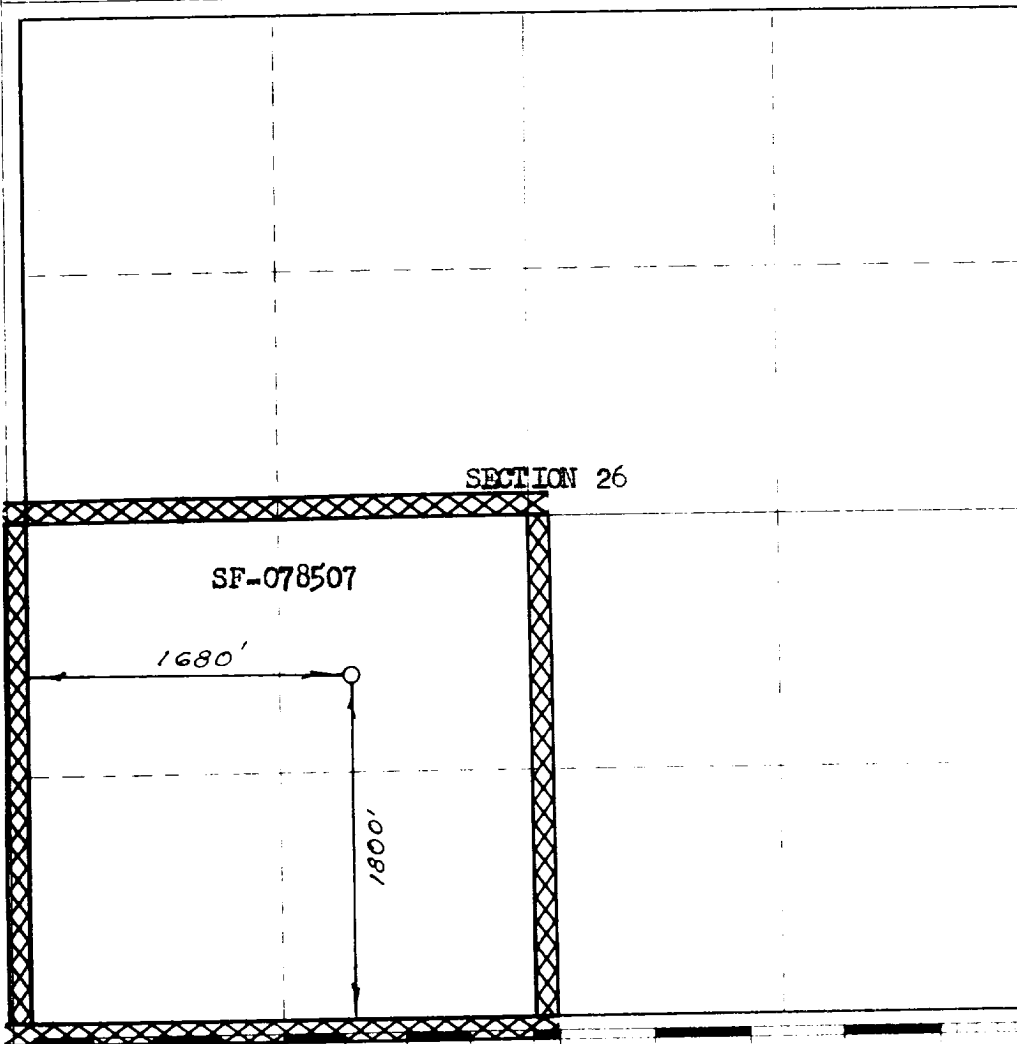

CERTIFICATION

I hereby certify that the information contained herein is true and complete to the best of my knowledge and belief.

Original Signed by
D. G. Brisco

Drilling Clerk

El Paso Natural Gas Co.

May 21, 1973

I hereby certify that the well location shown on this plat was plotted from field notes of actual surveys made by me or under my supervision and that the same is true and correct to the best of my knowledge and belief.

APRIL 30, 1973

David Wilson

1760

