

**NEW MEXICO OIL CONSERVATION COMMISSION**  
**WELL LOCATION AND ACERAGE DEDICATION PLAT**

All distances must be from the outer boundaries of the Section

**RECEIVED**  
 SEP 19 1973  
 U. S. GEOLOGICAL SURVEY  
 FARMINGTON, N. M.

Operator <u>Schalk Corporation</u>		Lease <u>Schalk 94</u>		Well No. <u>94</u>	
Unit Letter <u>M</u>	Section <u>26</u>	Township <u>32 NORTH</u>	Range <u>8 WEST</u>	County <u>SAN JUAN</u>	
Actual Footage Location of Well: <u>1100</u> feet from the <u>SOUTH</u> line and <u>960</u> feet from the <u>WEST</u> line					
Ground Level Elev. <u>6877.0</u>	Producing Formation <u>DAKOTA NW</u>	Pool <u>Basin Dakota</u>	Dedicated Acreage: <u>320</u> Acres		

1. Outline the acreage dedicated to the subject well by colored pencil or hachure marks on the plat below.
2. If more than one lease is dedicated to the well, outline each and identify the ownership thereof (both as to working interest and royalty).
3. If more than one lease of different ownership is dedicated to the well, have the interests of all owners been consolidated by communitization, unitization, force-pooling, etc?  
 ( ) Yes ( ) No If answer is "yes," type of consolidation \_\_\_\_\_  
 If answer is "no," list the owners and tract descriptions which have actually consolidated. (Use reverse side of this form if necessary) \_\_\_\_\_  
 No allowable will be assigned to the well until all interests have been consolidated (by communitization, unitization, forced-pooling, or otherwise) or until a non standard unit, eliminating such interests, has been approved by the Commission.

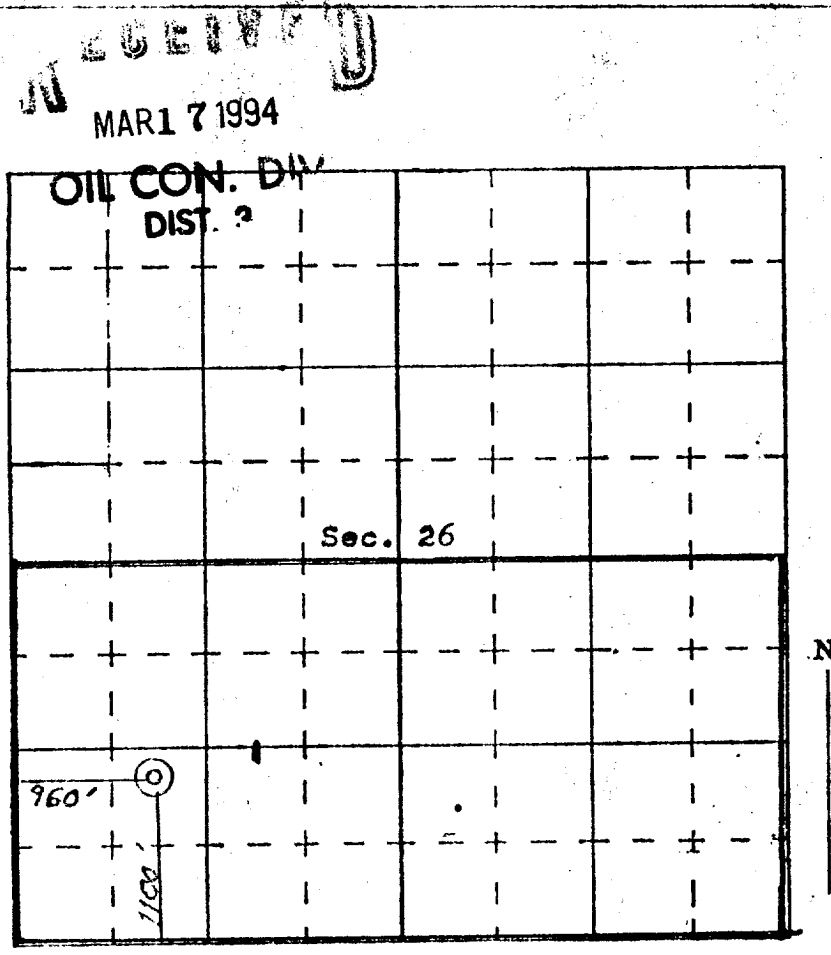

SCALE—4 INCHES EQUALS 1 MILE

SAN JUAN ENGINEERING COMPANY, FARMINGTON, N. M.

**CERTIFICATION**

I hereby certify that the information contained herein is true and complete to the best of my knowledge and belief.

Donna Hughes  
 Name  
 DONNA HUGHES, AGENT  
 Position

Company \_\_\_\_\_  
 Date SEPTEMBER 19, 1973

I hereby certify that the well location shown on this plat was plotted from field notes of actual surveys made by me or under my supervision, and that the same is true and correct to the best of my knowledge and belief.

8 September, 1973  
 Date Surveyed  
James P. Leese  
 Registered Professional Engineer  
 and of Land Surveyor  
**JAMES P. LEESE**  
 1463  
 Certificate No. 1463