

NO. OF COPIES RECEIVED	5
DISTRIBUTION	
SANTA FE	1
FILE	1
U.S.G.S.	2
LAND OFFICE	
OPERATOR	1

NEW MEXICO OIL CONSERVATION COMMISSION

30-045-21351

Form C-101
Revised 1-1-65

5A. Indicate Type of Lease	
STATE <input type="checkbox"/>	FEE <input checked="" type="checkbox"/>

5. State Oil & Gas Lease No.

APPLICATION FOR PERMIT TO DRILL, DEEPEN, OR PLUG BACK

1a. Type of Work		7. Unit Agreement Name	
b. Type of Well OIL WELL <input type="checkbox"/> DRILL <input checked="" type="checkbox"/> DEEPEN <input type="checkbox"/> PLUG BACK <input type="checkbox"/> GAS WELL <input checked="" type="checkbox"/> OTHER <input type="checkbox"/> SINGLE ZONE <input checked="" type="checkbox"/> MULTIPLE ZONE <input type="checkbox"/>		8. Farm or Lease Name Holmberg Gas Com "B"	
2. Name of Operator AMOCO PRODUCTION COMPANY		9. Well No. 1	
3. Address of Operator 501 Airport Drive, Farmington, New Mexico 87401		10. Field and Pool, or Wildcat Undesignated Fruitland	
4. Location of Well UNIT LETTER P LOCATED 1190 FEET FROM THE South LINE AND 810 FEET FROM THE East LINE OF SEC. 28 TWP. 32N RGE. 10W NMPM		12. County San Juan	
21. Elevations (Show whether DF, RT, etc.) 5874' GL ungraded		19. Proposed Depth 2950'	19A. Formation Fruitland
21A. Kind & Status Plug. Bond Statewide		20. Rotary or C.T. Rotary	
21B. Drilling Contractor Arapahoe Drilling Co.		22. Approx. Date Work will start October 1973	

23. PROPOSED CASING AND CEMENT PROGRAM

SIZE OF HOLE	SIZE OF CASING	WEIGHT PER FOOT	SETTING DEPTH	SACKS OF CEMENT	EST. TOP
11"	8-5/8"	24#	250'	200	Surface
7-7/8"	4-1/2"	9.5#	2950'	500	Surface

Well to be drilled to test the Fruitland formation. Completion and stimulation will be determined from evaluation of open hole logs. Copies of Location Plat are attached.

Copies of well logs will be sent upon completion of the well.

APPROVAL VALID
FOR 90 DAYS UNLESS
DRILLING COMMENCED,

EXPIRES 12-26-73



IN ABOVE SPACE DESCRIBE PROPOSED PROGRAM: IF PROPOSAL IS TO DEEPEN OR PLUG BACK, GIVE DATA ON PRESENT PRODUCTIVE ZONE AND PROPOSED NEW PRODUCTIVE ZONE. GIVE BLOWOUT PREVENTER PROGRAM, IF ANY.

I hereby certify that the information above is true and complete to the best of my knowledge and belief.

Signed J. ARNOLD SNELL Original Signed by Area Engineer Title September 25, 1973 Date

(This space for State Use)

PETROLEUM COMMISSION NO. 3

SEP 26 1973

APPROVED BY [Signature] TITLE DATE
CONDITIONS OF APPROVAL, IF ANY:

**NEW MEXICO OIL CONSERVATION COMMISSION
WELL LOCATION AND ACERAGE DEDICATION PLAT**

All distances must be from the outer boundaries of the Section

Operator Amoco Production Company			Lease Holmberg Gas Com "B"		Well No. 1
Unit Letter P	Section 28	Township 32 North	Range 10 West	County San Juan	

Actual Footage Location of Well:
1190 feet from the **South** line and **810** feet from the **East** line
 Ground Level Elev. **5874 est.** Producing Formation **Fruitland** Pool **Undesignated Fruitland** Dedicated Acreage: **160** Acres

1. Outline the acreage dedicated to the subject well by colored pencil or hachure marks on the plat below.
2. If more than one lease is dedicated to the well, outline each and identify the ownership thereof (both as to working interest and royalty),
3. If more than one lease of different ownership is dedicated to the well, have the interests of all owners been consolidated by communitization, unitization, force-pooling, etc?

() Yes () No If answer is "yes," type of consolidation
 If answer is "no," list the owners and tract descriptions which have actually consolidated. (Use reverse side of this form if necessary.)

No allowable will be assigned to the well until all interests have been consolidated (by communitization, unitization, forced-pooling, or otherwise) or until a non standard unit, eliminating such interests, has been approved by the Commission.

CERTIFICATION

I hereby certify that the information contained herein is true and complete to the best of my knowledge and belief.

J. L. ...
 Name
 Area Engineer
 Position
AMOCO PRODUCTION COMPANY
 Company
September 25, 1973
 Date

I hereby certify that the well location shown on this plat was plotted from field notes of actual survey made by me or under my supervision, and that the same is true and correct to the best of my knowledge and belief.

E. V. Echot Hawk
 Date Surveyed
September 19, 1973
 Registered Professional Engineer
 and/or Land Surveyor

E. V. Echot Hawk
 Certificate No. 3602
E. V. Echot Hawk LS

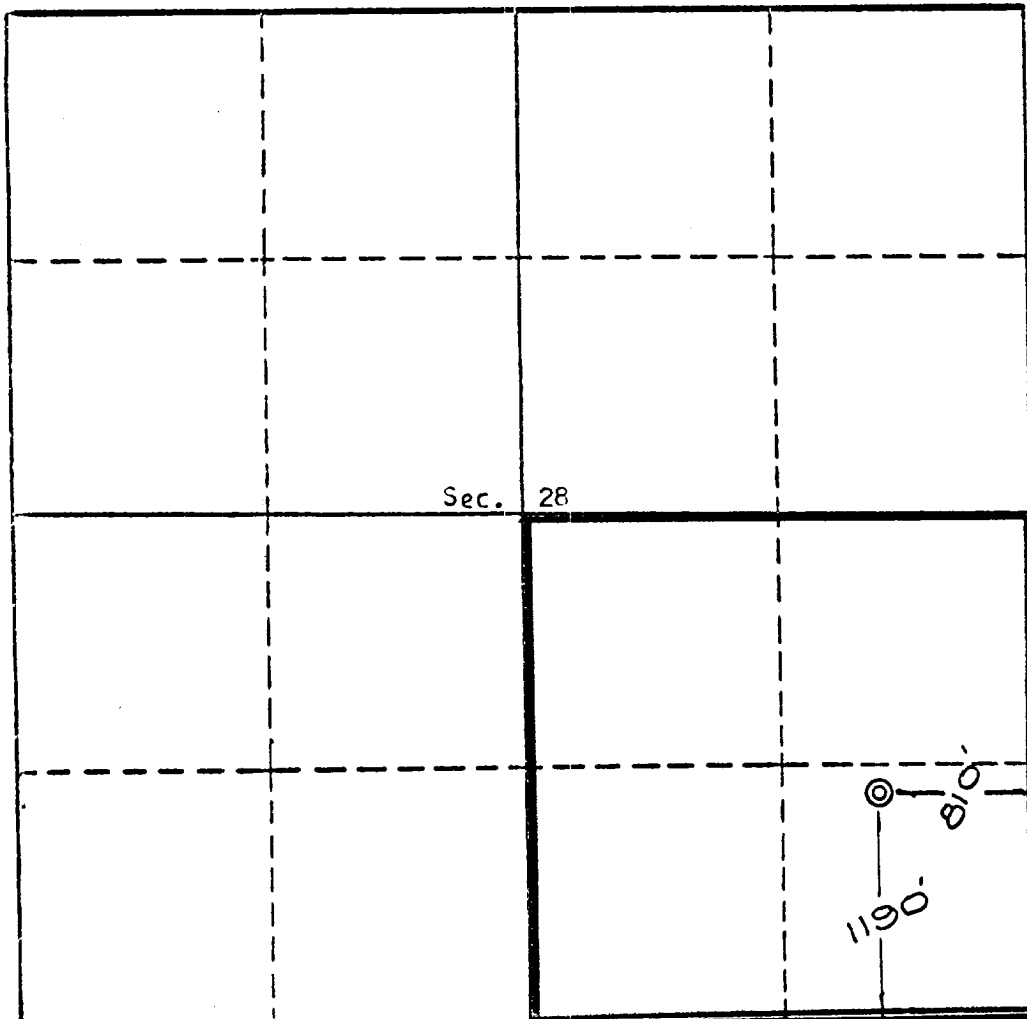

Scale: 1 inch = 1,000 feet