

30-045-21376

Form C-101
Revised 1-1-65

NEW MEXICO OIL CONSERVATION COMMISSION

NO. OF COPIES RECEIVED	6
DISTRIBUTION	
SANTA FE	1
FILE	2
U.S.G.S.	2
LAND OFFICE	
OPERATOR	2

5A. Indicate Type of Lease	
STATE <input type="checkbox"/>	FEED <input checked="" type="checkbox"/>
5. State Oil & Gas Lease No.	

APPLICATION FOR PERMIT TO DRILL, DEEPEN, OR PLUG BACK

1a. Type of Work DRILL <input checked="" type="checkbox"/> DEEPEN <input type="checkbox"/> PLUG BACK <input type="checkbox"/>		7. Unit Agreement Name
b. Type of Well OIL WELL <input type="checkbox"/> GAS WELL <input checked="" type="checkbox"/> OTHER <input type="checkbox"/>		8. Farm or Lease Name Thurston
2. Name of Operator El Paso Natural Gas Company		9. Well No. 2
3. Address of Operator PO Box 990, Farmington, NM 87401		10. Field and Pool, or Wildcat Aztec Pictured Cliffs
4. Location of Well UNIT LETTER <u>A</u> LOCATED <u>1180</u> FEET FROM THE <u>North</u> LINE AND <u>1180</u> FEET FROM THE <u>East</u> LINE OF SEC. <u>31</u> TWP. <u>31N</u> RGE. <u>10W</u> NMPM		12. County San Juan
19. Proposed Depth 2415'		19A. Formation Pictured Cliffs
20. Rotary or C.T. Rotary		21. Elevations (Show whether DI, RT, etc.) 5827'GR
21A. Kind & Status Plug. Bond statewide		22. Approx. Date Work will start

23.

PROPOSED CASING AND CEMENT PROGRAM

SIZE OF HOLE	SIZE OF CASING	WEIGHT PER FOOT	SETTING DEPTH	SACKS OF CEMENT	EST. TOP
12 1/4"	8 5/8"	24.0#	120'	110 cu. ft.	circ. to surface
6 3/4"	2 7/8"	6.4#	2415'	520 cu. ft.	690'

Selectively perforate and sandwater fracture the Pictured Cliffs formation.

The NE/4 of Section 31 is dedicated to this well.

APPROVAL FOR
FOR 90 DAYS UNLESS
DRILLING COMMENCED,

EXPIRES 2-4-74



IN ABOVE SPACE DESCRIBE PROPOSED PROGRAM: IF PROPOSAL IS TO DEEPEN OR PLUG BACK, GIVE DATA ON PRESENT PRODUCTIVE ZONE AND PROPOSED NEW PRODUCTIVE ZONE. GIVE BLOWOUT PREVENTER PROGRAM, IF ANY.

I hereby certify that the information above is true and complete to the best of my knowledge and belief.

Signed A. L. Breece Title Drilling Clerk Date November 6, 1973

(This space for State Use)

APPROVED BY [Signature] TITLE _____ DATE _____

CONDITIONS OF APPROVAL, IF ANY:

**NEW MEXICO OIL CONSERVATION COMMISSION
WELL LOCATION AND ACREAGE DEDICATION PLAT**

Form 1-1-69
Supersedes C-128
Effective 1-1-69

All distances must be from the outer boundaries of the Section.

EL PASO NATURAL GAS COMPANY			THURSTON		(FEE)	2
A	31	31-N	11-W	SAN JUAN		
1180	NORTH	1180	EAST			
5827	PICTURED CLIFFS	AZTEC PICTURED CLIFFS	160.00			

1. Outline the acreage dedicated to the subject well by colored pencil or hatchure marks on the plat below.
2. If more than one lease is dedicated to the well, outline each and identify the ownership thereof (ownership to working interest and royalty).
3. If more than one lease of different ownership is dedicated to the well, have the interests of all owners been consolidated by communitization, unitization, force-pooling, etc?

☐ Yes ☐ No If answer is "yes," type of consolidation _____

If answer is "no," list the owners and tract descriptions which have actually been consolidated (Use reverse side of this form if necessary.) _____

No allowable will be assigned to the well until all interests have been consolidated (by communitization, unitization, forced-pooling, or otherwise) or until a non-standard unit, eliminating such interests, has been approved by the Commission.

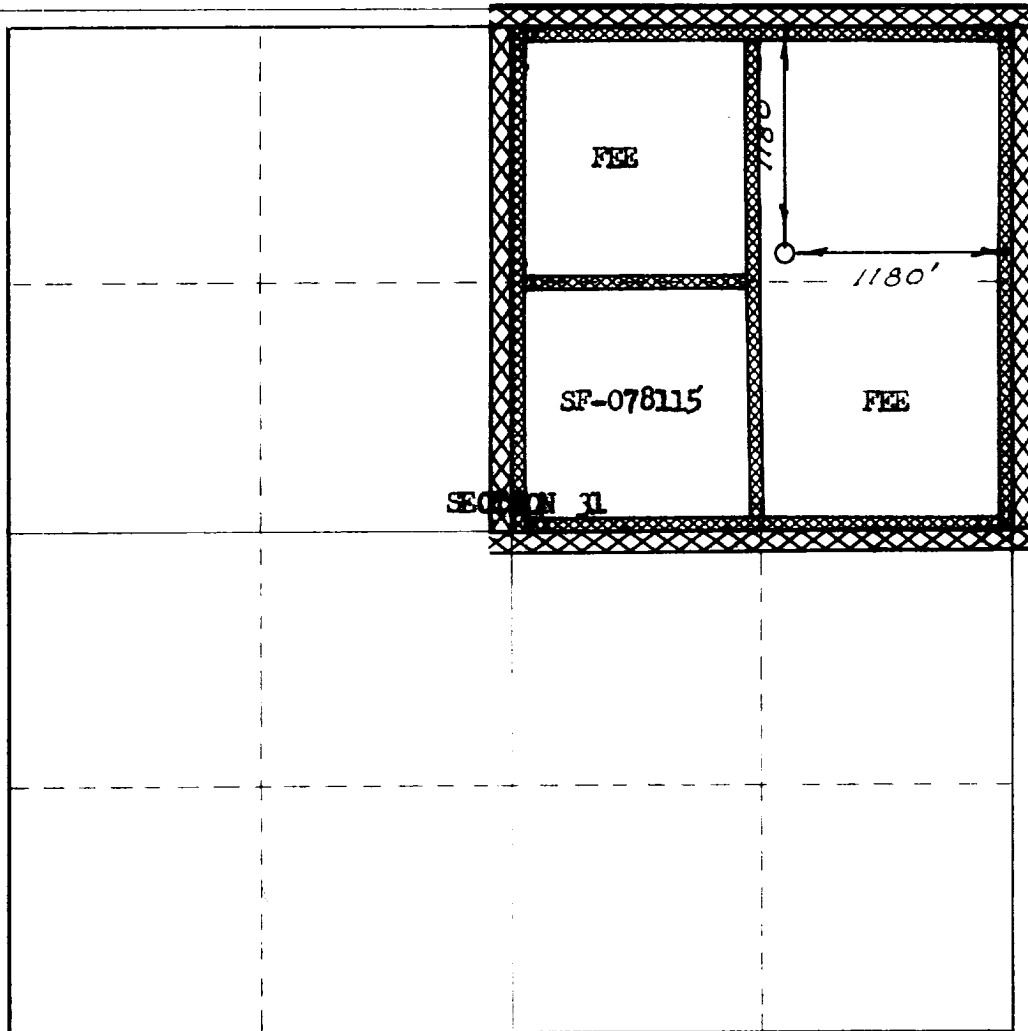
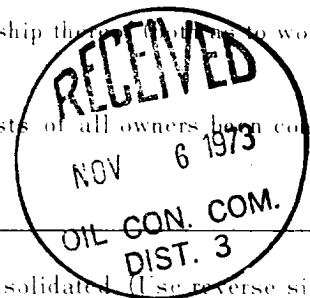

CERTIFICATION

I hereby certify that the information contained herein is true and complete to the best of my knowledge and belief.

Original Signed by
D. G. Brisco
Drilling Clerk

El Paso Natural Gas Co.

November 6, 1973

I hereby certify that the well location shown on this plat was plotted from field notes of actual surveys made by me or under my supervision, and that the same is true and correct to the best of my knowledge and belief.

FEBRUARY 23, 1973

Paul Olsen
1760

