

NO. OF COPIES RECEIVED	6
DISTRIBUTION	
SANTA FE	1
FILE	1
U.S.G.S.	2
LAND OFFICE	1
OPERATOR	1

NEW MEXICO OIL CONSERVATION COMMISSION

30-045-31377

Form C-101
Revised 1-1-65

5A. Indicate Type of Lease
STATE <input checked="" type="checkbox"/> FILE <input type="checkbox"/>
5. State Oil & Gas Lease No.
E-1195-3

APPLICATION FOR PERMIT TO DRILL, DEEPEN, OR PLUG BACK

1a. Type of Work		7. Unit Agreement Name	
b. Type of Well DRILL <input checked="" type="checkbox"/> DEEPEN <input type="checkbox"/> PLUG BACK <input type="checkbox"/> OIL WELL <input type="checkbox"/> GAS WELL <input checked="" type="checkbox"/> OTHER <input type="checkbox"/> SINGLE ZONE <input checked="" type="checkbox"/> MULTIPLE ZONE <input type="checkbox"/>		8. Farm or Lease Name Smyers Com A	
2. Name of Operator El Paso Natural Gas Company		9. Well No. 2	
3. Address of Operator PO Box 990, Farmington, NM 87401		10. Field and Pool, or Wildcat Undes. Pictured Cliffs	
4. Location of Well UNIT LETTER C LOCATED 1160 FEET FROM THE North LINE AND 1480 FEET FROM THE West LINE OF SEC. 2 TWP. 31N RGE. 11W NMPM		12. County San Juan	
21. Elevations (Show whether DF, RT, etc.) 5978' GR		19. Proposed Depth 2845'	19A. Formation Pictured Cliffs
21A. Kind & Status Plug. Bond statewide	21B. Drilling Contractor	20. Rotary or C.T. Rotary	
22. Approx. Date Work will start			

PROPOSED CASING AND CEMENT PROGRAM

SIZE OF HOLE	SIZE OF CASING	WEIGHT PER FOOT	SETTING DEPTH	SACKS OF CEMENT	EST. TOP
12 1/4"	8 5/8"	24.0#	120'	110 cu. ft.	circ. to surface
6 3/4"	2 7/8"	6.4#	2845'	540 cu. ft.	1045'

Selectively perforate and sandwater fracture the Pictured Cliffs formation.

The NW/4 of Section 2 is dedicated to this well.

APPROVAL VALID
FOR 90 DAYS UNLESS
DRILLING COMMENCED,

EXPIRES 2-4-74

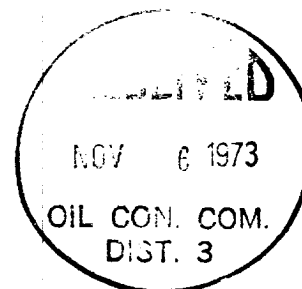

IN ABOVE SPACE DESCRIBE PROPOSED PROGRAM: IF PROPOSAL IS TO DEEPEN OR PLUG BACK, GIVE DATA ON PRESENT PRODUCTIVE ZONE AND PROPOSED NEW PRODUCTIVE ZONE. GIVE BLOWOUT PREVENTER PROGRAM, IF ANY.

I hereby certify that the information above is true and complete to the best of my knowledge and belief.

Signed J. G. Bivens Title Drilling Clerk Date November 6, 1973

(This space for State Use)

APPROVED BY [Signature] TITLE _____ DATE _____

CONDITIONS OF APPROVAL, IF ANY:

N MEXICO OIL CONSERVATION COMMISS
WELL LOCATION AND ACREAGE DEDICATION PLAT

Form 1-5-71
Supersedes O-128
Effective 1-5-71

All distances must be from the outer boundaries of the Section

EL PASO NATURAL GAS COMPANY		SMYERS COM. A		(E-1195-3)	2
C	2	31-N	11-W	SAN JUAN	
1160	NORTH	1480	WEST		
5978	PICTURED CLIFFS	UNDESIGNATED PICTURED CLIFFS	160.75		

1. Outline the acreage dedicated to the subject well by colored pencil or hachure marks on the plat below.
2. If more than one lease is dedicated to the well, outline each and identify the ownership thereof (both as to working interest and royalty).
3. If more than one lease of different ownership is dedicated to the well, have the interests of all owners been consolidated by communitization, unitization, force-pooling, etc?

☒ Yes ☐ No If answer is "yes," type of consolidation Communitization

If answer is "no," list the owners and tract descriptions which have actually been consolidated. (Use reverse side of this form if necessary.)

No allowable will be assigned to the well until all interests have been consolidated (by communitization, unitization, force-pooling, or otherwise) or until a non-standard unit, eliminating such interests, has been approved by the Commission.

NOTE: THIS PLAT REISSUED TO SHOW CORRECTED ACREAGE DEDICATION. 11-8-73

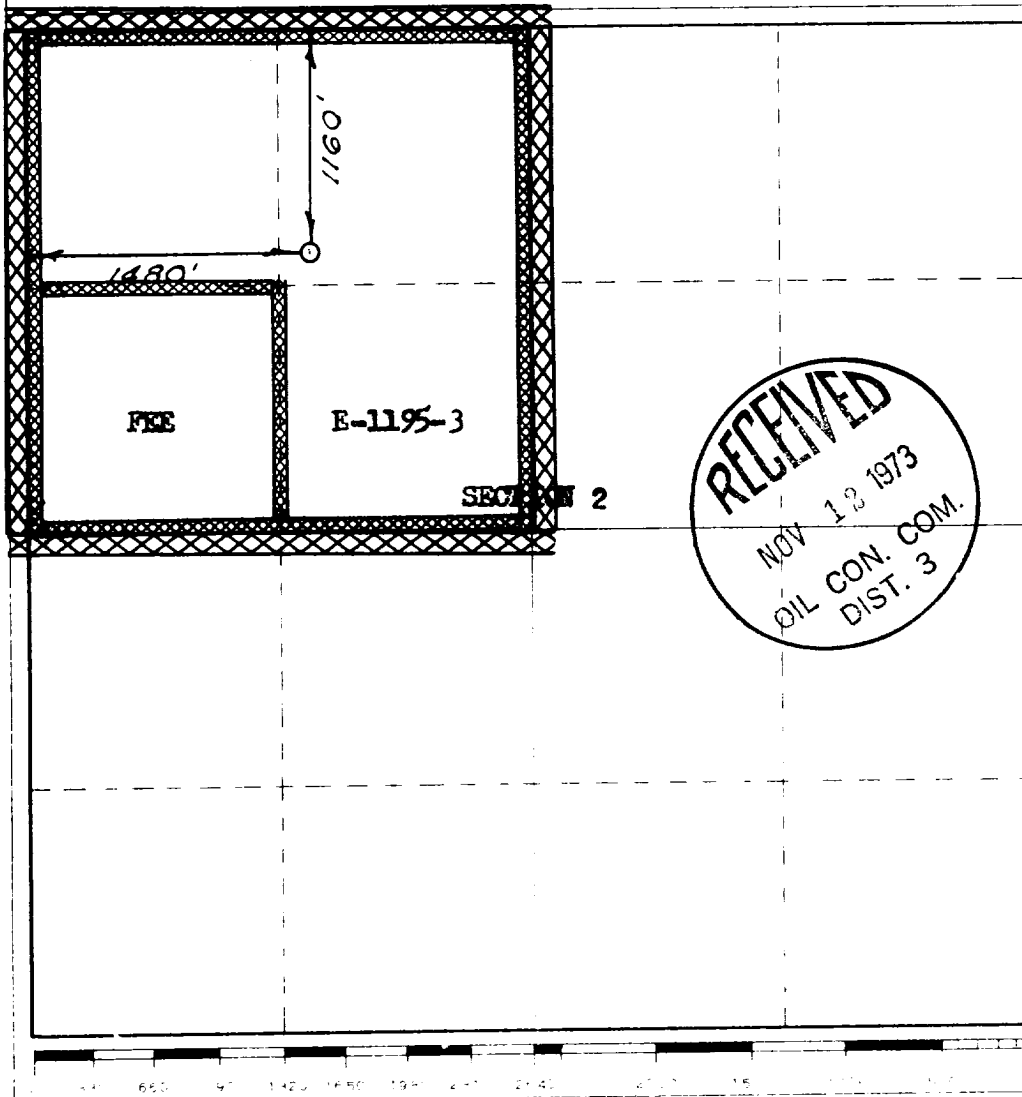

RECEIVED
NOV 12 1973
OIL CON. COM.
DIST. 3

CERTIFICATION

I hereby certify that the information contained herein is true and complete to the best of my knowledge and belief.
Original Signed by
D. G. Brisco

Drilling Clerk
El Paso Natural Gas Co.
November 12, 1973

I hereby certify that the well location shown on this plat was plotted from field notes of actual surveys made by me or under my supervision, and that the same is true and correct to the best of my knowledge and belief.

JULY 26, 1973

David Kilmer
1760