

NO. OF COPIES RECEIVED	
DISTRIBUTION	5
SANTA FE	1
FILE	1
U.S.G.S.	2
LAND OFFICE	
OPERATOR	1

NEW MEXICO OIL CONSERVATION COMMISSION

Form C-101
Revised 1-1-65 30-045-01484

5A. Indicate Type of Lease	
STATE <input type="checkbox"/>	FEE <input checked="" type="checkbox"/>
5. State Oil & Gas Lease No.	

APPLICATION FOR PERMIT TO DRILL, DEEPEN, OR PLUG BACK

1a. Type of Work	
b. Type of Well DRILL <input checked="" type="checkbox"/> DEEPEN <input type="checkbox"/> PLUG BACK <input type="checkbox"/>	
OIL WELL <input type="checkbox"/> GAS WELL <input checked="" type="checkbox"/> OTHER <input type="checkbox"/> SINGLE ZONE <input checked="" type="checkbox"/> MULTIPLE ZONE <input type="checkbox"/>	
2. Name of Operator Northwest Pipeline Corporation	
3. Address of Operator 501 Airport Drive, Room 126 Farmington, N.M. 87401	
4. Location of Well UNIT LETTER M LOCATED 1140 FEET FROM THE West LINE AND 890 FEET FROM THE South LINE OF SEC. 20 TWP. 32N RGE. 11W NMPM	
7. Unit Agreement Name	
8. Farm or Lease Name Holt	
9. Well No. 4	
10. Field and Pool, or Wildcat Undesignated Pictured Cliffs	
12. County San Juan	
19. Proposed Depth 3400'	
19A. Formation Pictured Cliffs	
20. Rotary or C.T. Rotary	
21. Elevations (Show whether DF, RT, etc.) 6590 G.L.	
21A. Kind & Status Plug. Bond Blanket on file	
21B. Drilling Contractor	
22. Approx. Date Work will start June 1, 1974	

PROPOSED CASING AND CEMENT PROGRAM					
SIZE OF HOLE	SIZE OF CASING	WEIGHT PER FOOT	SETTING DEPTH	SACKS OF CEMENT	EST. TOP
12-1/4	8-5/8	24.0	100	110	Circulate
6-3/4	2-7/8	6.4	3400	350	Ojo Alamo

Selectively Perforate and sand-water frac the Pictured Cliffs formation

The SW/4 of Sec 20 is dedicated to this well

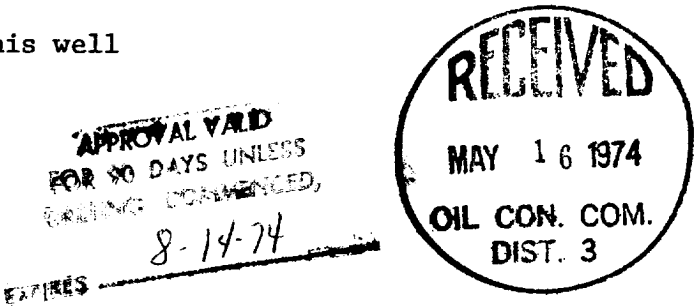

IN ABOVE SPACE DESCRIBE PROPOSED PROGRAM: IF PROPOSAL IS TO DEEPEN OR PLUG BACK, GIVE DATA ON PRESENT PRODUCTIVE ZONE AND PROPOSED NEW PRODUCTIVE ZONE. GIVE BLOWOUT PREVENTER PROGRAM, IF ANY.

I hereby certify that the information above is true and complete to the best of my knowledge and belief.

Signed Dr. Whitcomb Title Drilling & Production Engineer Date May 16, 1974

(This space for State Use)
APPROVED BY Curry C. Cawel TITLE SUPERVISOR DIST. #3 DATE 5-16-74
CONDITIONS OF APPROVAL, IF ANY:

**NEW MEXICO OIL CONSERVATION COMMISSION
WELL LOCATION AND ACREAGE DEDICATION PLAT**

Form C-102
Supersedes C-128
Effective 1-1-65

All distances must be from the outer boundaries of the Section.

Operator Northwest Pipeline Corporation			Lease Holt		Well No. 4
Unit Letter M	Section 20	Township 32N	Range 11W	County San Juan	
Actual Footage Location of Well: 890 feet from the South line and 1140 feet from the West line					
Ground Level Elev. 6590	Producing Formation Pictured Cliffs		Pool Undesignated Pictured Cliffs		Dedicated Acreage: 160 Acres

1. Outline the acreage dedicated to the subject well by colored pencil or hachure marks on the plat below.
2. If more than one lease is dedicated to the well, outline each and identify the ownership thereof (both as to working interest and royalty).
3. If more than one lease of different ownership is dedicated to the well, have the interests of all owners been consolidated by communitization, unitization, force-pooling, etc?

☐ Yes ☒ No If answer is "yes," type of consolidation _____

If answer is "no," list the owners and tract descriptions which have actually been consolidated. (Use reverse side of this form if necessary.) NE/4 SW/4 NM 010910 other three 1/4 - 1/4 Layer Fee

No allowable will be assigned to the well until all interests have been consolidated (by communitization, unitization, forced-pooling, or otherwise) or until a non-standard unit, eliminating such interests, has been approved by the Commission.

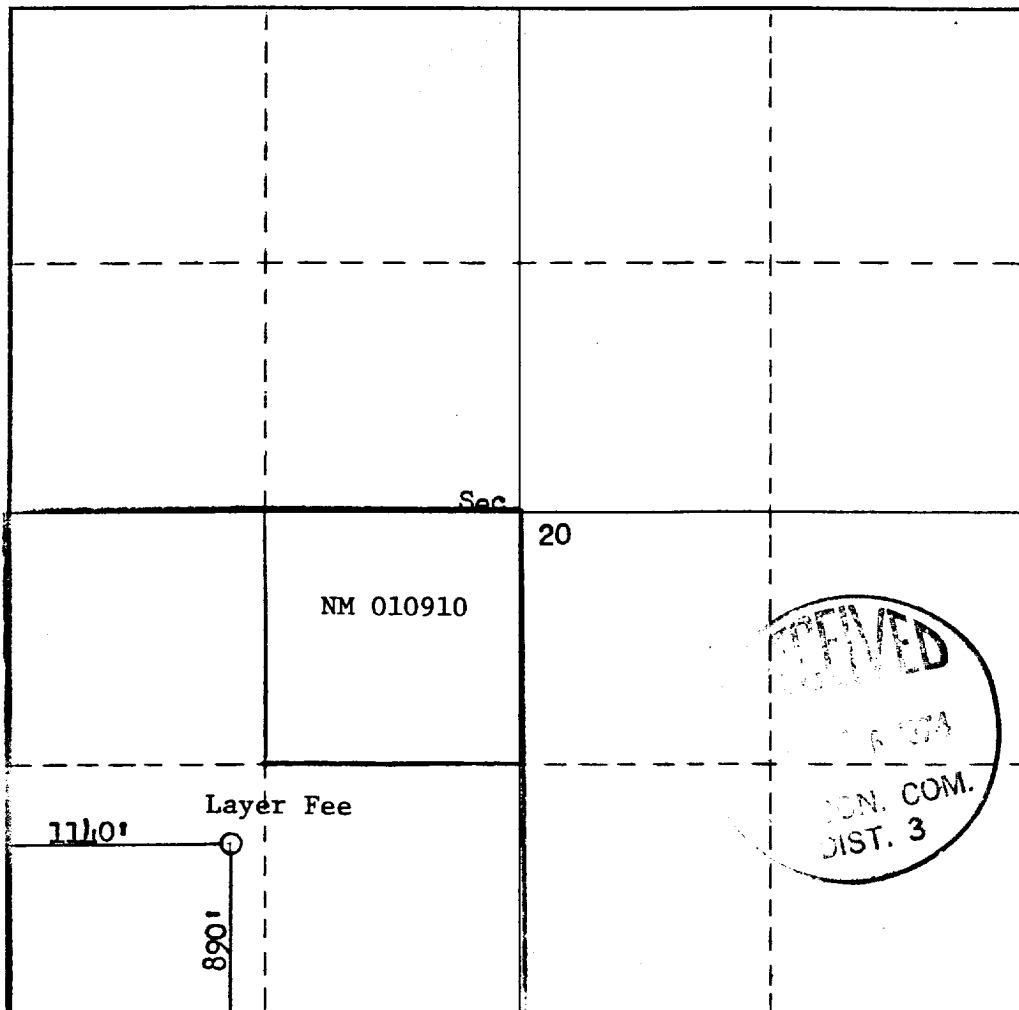

CERTIFICATION

I hereby certify that the information contained herein is true and complete to the best of my knowledge and belief.

Name
David H. Lambing
Position
Drilling & Production Eng.
Company
Northwest Pipeline Corp.
Date
May 16, 1974

I hereby certify that the well location shown on this plat was plotted from field notes of actual surveys made by me or under my supervision, and that the same is true and correct to the best of my knowledge and belief.

Date Surveyed
May 8, 1974
Registered Professional Engineer and/or Land Surveyor
Fred B. Kerr
Certificate No.
3950

