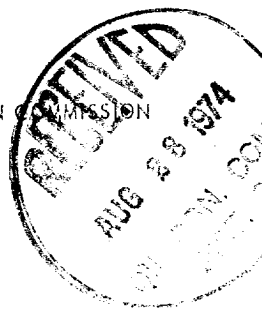

NO. OF COPIES RECEIVED	6
DISTRIBUTION	
SANTA FE	1
FILE	1
U.S.G.S.	2
LAND OFFICE	1
OPERATOR	1

NEW MEXICO OIL CONSERVATION COMMISSION

Form C-101
Revised 1-1-65

30-045-21544

APPLICATION FOR PERMIT TO DRILL, DEEPEN, OR PLUG BACK

1a. Type of Work DRILL <input checked="" type="checkbox"/> DEEPEN <input type="checkbox"/> PLUG BACK <input type="checkbox"/>		5a. Indicate Type of Lease STATE <input checked="" type="checkbox"/> FEDERAL <input type="checkbox"/>
b. Type of Well OIL WELL <input type="checkbox"/> GAS WELL <input checked="" type="checkbox"/> OTHER <input type="checkbox"/> SINGLE ZONE <input checked="" type="checkbox"/> MULTIPLE ZONE <input type="checkbox"/>		6. State Oil & Gas Lease No. E-503
2. Name of Operator Northwest Pipeline Corporation		7. Unit Agreement Name San Juan 32-7
3. Address of Operator P.O. Box 90 Production Dept. Farmington, New Mexico 87401		8. Farm or Lease Name San Juan 32-7
4. Location of Well UNIT LETTER <u>K</u> LOCATED <u>1850</u> FEET FROM THE <u>west</u> LINE AND <u>1830</u> FEET FROM THE <u>south</u> LINE OF SEC. <u>36</u> TWP. <u>32N</u> RGF. <u>7W</u> NMPM		9. Well No. #27
		10. Field and Pool, or Willcox Blanco Mesa Verde
		11. County San Juan
		12. Rotary or C.V.L. Rotary
		13. Proposed Depth 6150
		14. Formation Mesa Verde
		15. Rotary or C.V.L. Rotary
21. Elevations (Show whether DI, RI, etc.) 6677 GR	21A. Kind & Status Plug. Bond Blanket	21B. Drilling Contractor Arapahoe Drilling Co.
		22. Approx. Date Work will start August 30, 1974

23.

PROPOSED CASING AND CEMENT PROGRAM

SIZE OF HOLE	SIZE OF CASING	WEIGHT PER FOOT	SETTING DEPTH	SACKS OF CEMENT	EST. TOP
13-3/4	9-5/8	32.3#	200	180	circ.
8-3/4	7	20#	3979	230	1650
6-1/4	4-1/2	10.5#	6150	220	3750

Selectively perforate and stimulate the Mesa Verde formation.

The west half of section #36 is dedicated to this well.

APPROVAL VALID
FOR 90 DAYS UNLESS
DRILLING COMMENCED,

EXPIRES 11-27-74

IN ABOVE SPACE DESCRIBE PROPOSED PROGRAM: IF PROPOSAL IS TO DEEPEN OR PLUG BACK, GIVE DATA ON PRESENT PRODUCTIVE ZONE AND PROPOSED NEW PRODUCTIVE ZONE. GIVE BLOWOUT PREVENTER PROGRAM, IF ANY.

I hereby certify that the information above is true and complete to the best of my knowledge and belief.

Signed O. B. Whitenburg Title Drilling & Production Engineer Date August 27, 1974
(This space for State Use)

SUPERVISOR DIST. #3

APPROVED BY [Signature] TITLE _____ DATE AUG 28 1974

CONDITIONS OF APPROVAL, IF ANY:

NEW MEXICO OIL CONSERVATION COMMISSION WELL LOCATION AND ACREAGE DEDICATION PLAT

Form C-102
Supersedes C-125
Effective 1-1-65

All distances must be from the outer boundaries of the Section.

Operator Northwest Pipeline Corporation			Lease San Juan 32-7 Unit		Well No. 27
Unit Letter K	Section 36	Township 32N	Range 7W	County San Juan	
Actual Proctage Location of Well:					
1830 feet from the South		line and 1850 feet from the West		line	
Ground Level Elev. 6677		Producing Formation Mesa Verde		Pool Blanco Mesa Verde	Dedicated Acreage 320 Acres

1. Outline the acreage dedicated to the subject well by colored pencil or hachure marks on the plat below.

2. If more than one lease is dedicated to the well, outline each and identify the ownership thereof (both as to working interest and royalty).

3. If more than one lease of different ownership is dedicated to the well, have the interests of all owners been consolidated by communitization, unitization, force-pooling, etc?

☐ Yes ☒ No If answer is "yes," type of consolidation _____

If answer is "no," list the owners and tract descriptions which have actually been consolidated. (Use reverse side of this form if necessary.) NE/4 SW/4 Sec. 36, T-32-N, R-7-W

No allowable will be assigned to the well until all interests have been consolidated (by communitization, unitization, forced-pooling, or otherwise) or until a non-standard unit, eliminating such interests, has been approved by the Commission.

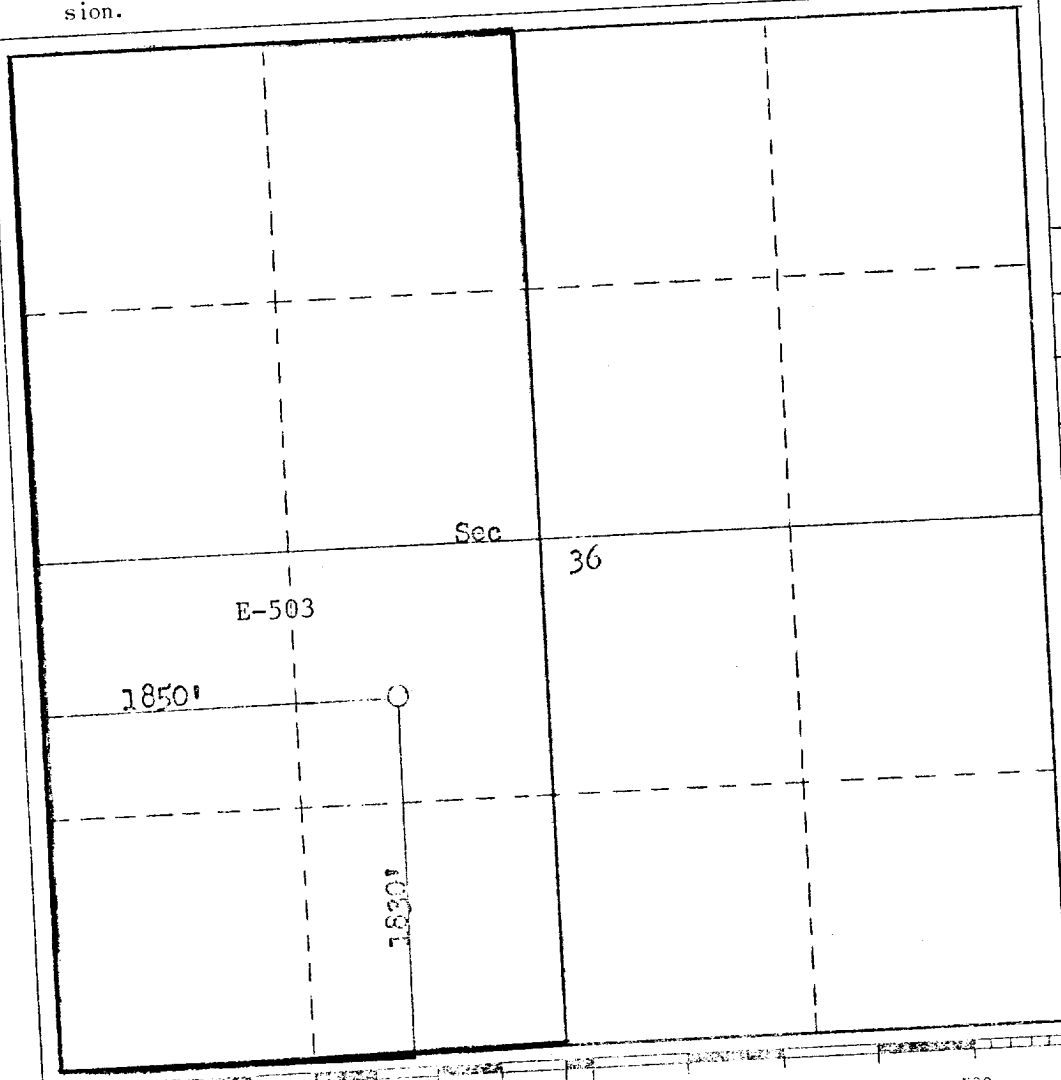

CERTIFICATION

I hereby certify that the information contained herein is true and complete to the best of my knowledge and belief.

Name
O.B. Whitenburg
Position O.B. Whitenburg
Drilling & Production Engineer
Company
Northwest Pipeline Corporation
Date
August 26, 1974

I hereby certify that the well location shown on this plat was plotted from field notes of actual surveys made by me or under my supervision, and that the same is true and correct to the best of my knowledge and belief.

Date Surveyed
August 24, 1974
Registered Professional Engineer and/or Land Surveyor
[Signature]
Certificate No.
3950